

DRAW OF PLOTS FOR REHABILITATION & RESETTLEMENT OF AIRPORT VILLAGES

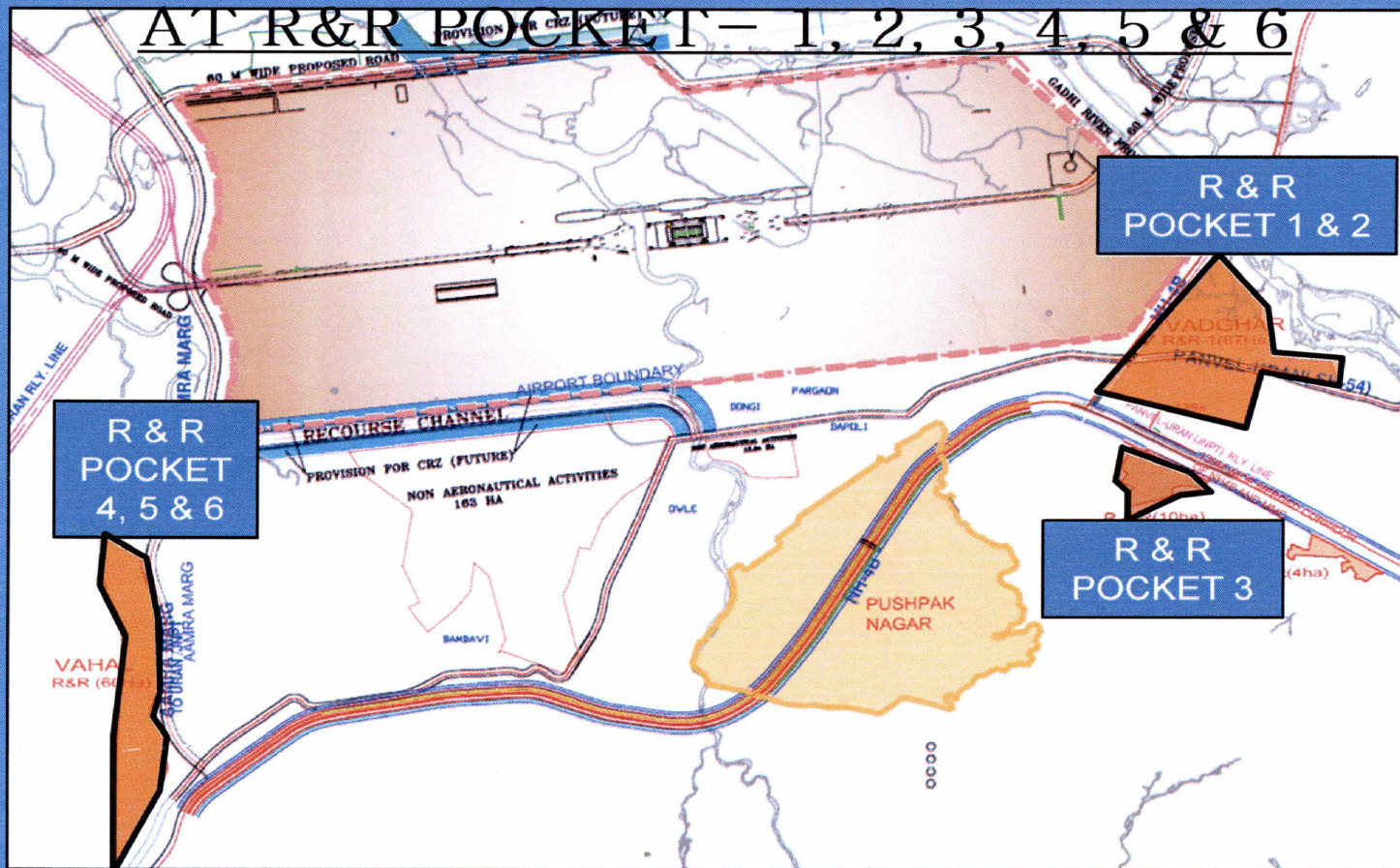

R & R POCKET 1, 2 & 3

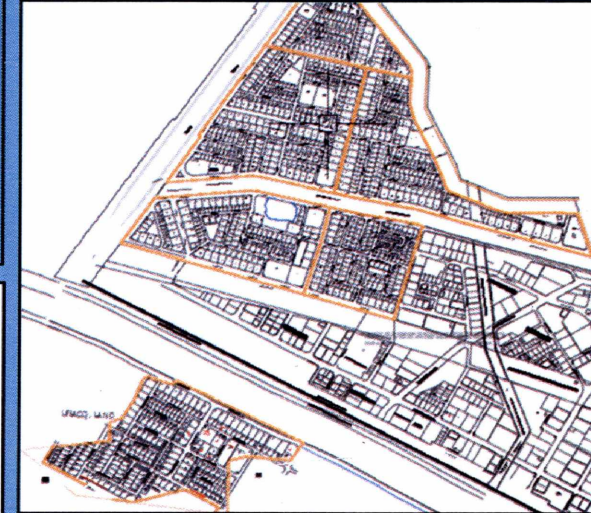

R & R POCKET 4, 5 & 6

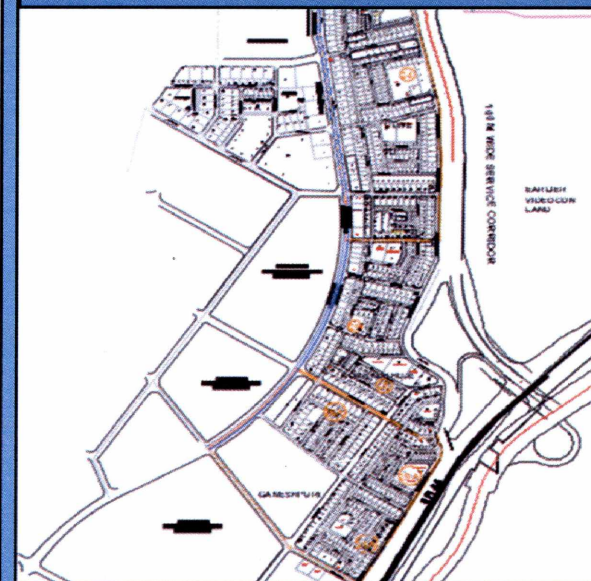

DRAW DATE : 14.06.2017

DRAW OF PLOT OF REHABILITATION AND RESETTLEMENT OF AIRPORT VILLAGES

BLOCK 1	Pocket no.	Sector	Plot no.
Plot Range (Sq m)	4,5,6	25A	336(E-H), 337(C-H), 235, 18(C-D),
	4,5,6	24	51C
40	3	1	268
	1,2	R4	185,186
	1,2	R1	54E,121B,181,195, 54C

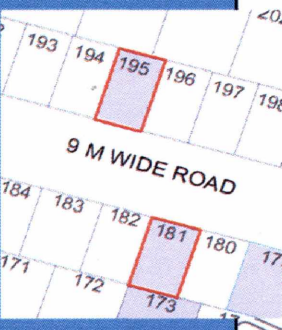
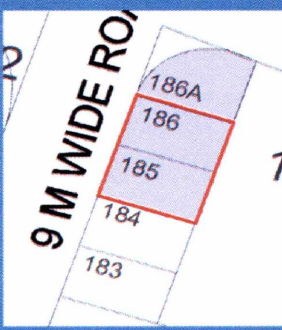
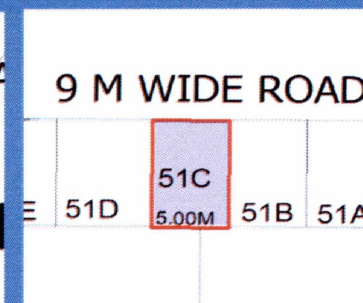
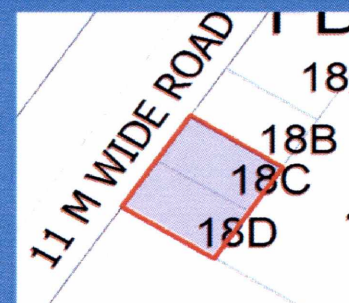
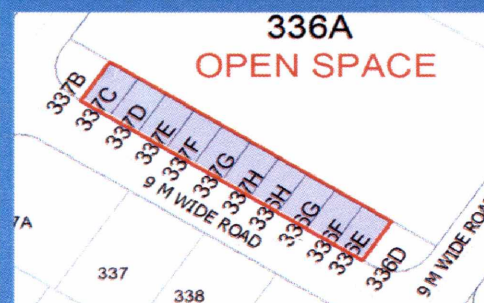
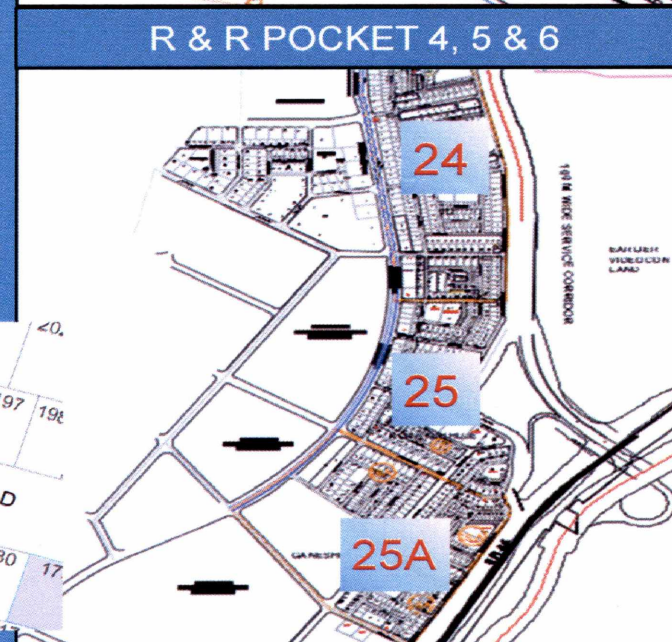
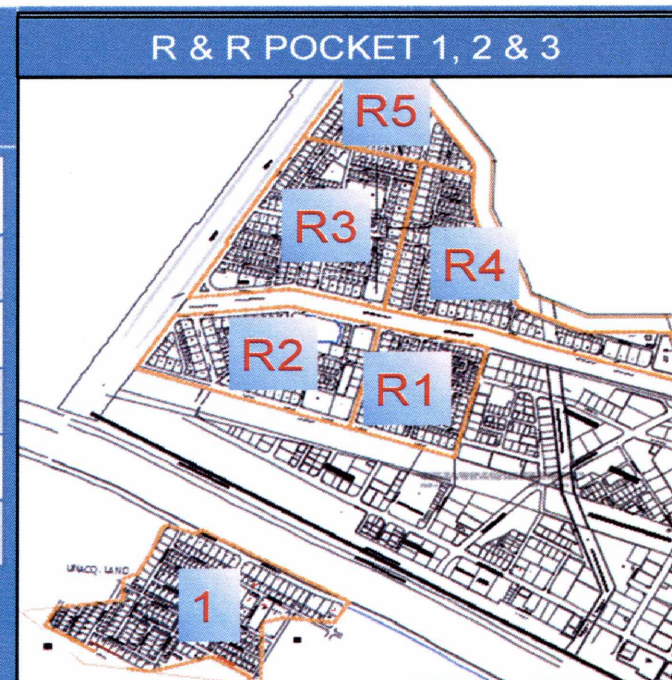

QMM
14/6/17

Latil
14/6/17

N.B. Chaudhary
14/6/17

DRAW OF PLOT OF REHABILITATION AND RESETTLEMENT OF AIRPORT VILLAGES

BLOCK 2	Pocket no.	Sector	Plot no.
Plot Range (Sq m)	4,5,6	25A	18B, 337B,336D
	1,2	R1	54F, 188A,179
50	1,2	R4	186A,206,206(A-B),
	3	1	268A, 106B
	4,5,6	24	79-81, 87-89, 59,76

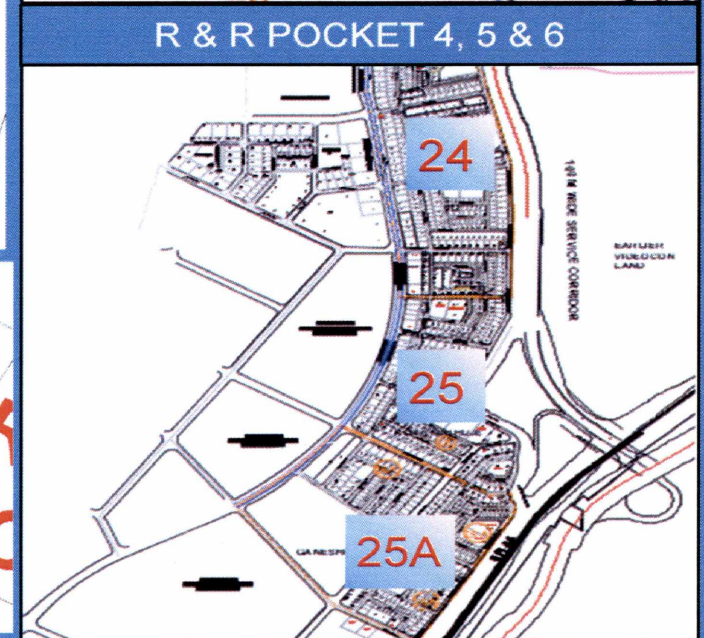
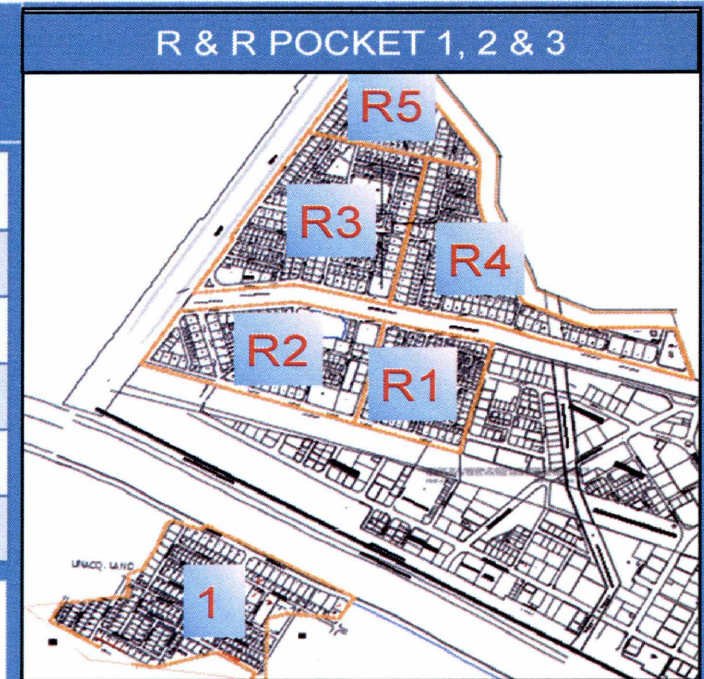
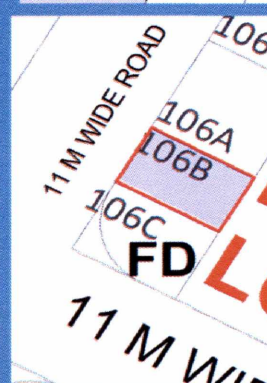
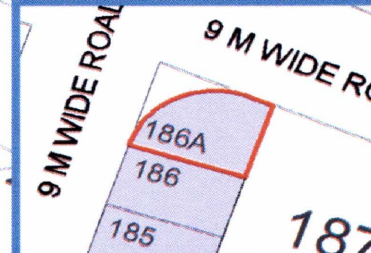
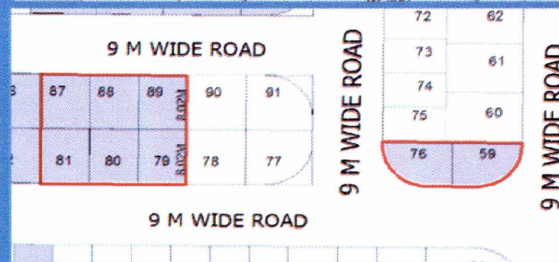
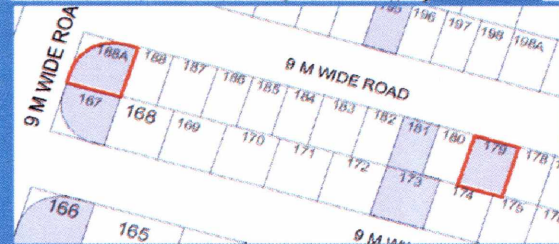
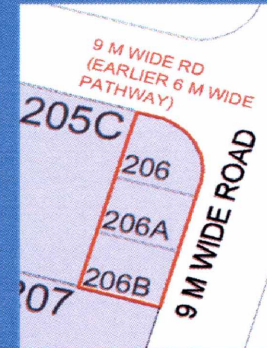
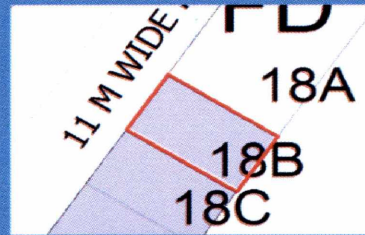
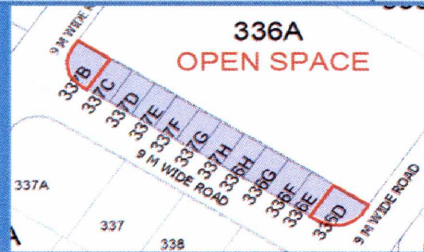

QMM
14/6/17

satil
14/6/17

N.B. Chaudhary
14/6/17

DRAW OF PLOT OF REHABILITATION AND RESETTLEMENT OF AIRPORT VILLAGES

BLOCK 3	Pocket no.	Sector	Plot no.
Plot Range (Sq m)	1,2	R3	96(A-B)
	1,2	R1	173,108B,167
	1,2	R5	46A, 44(A-C)
	4,5,6	24	82,86

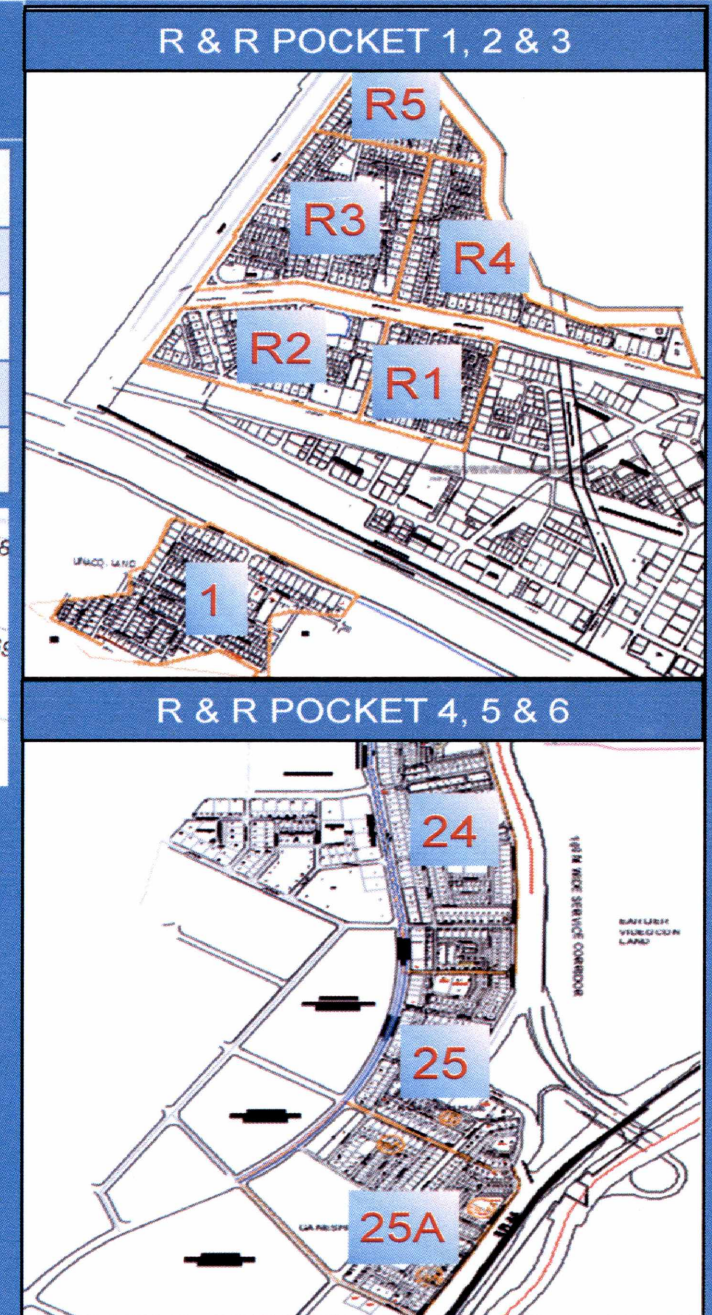
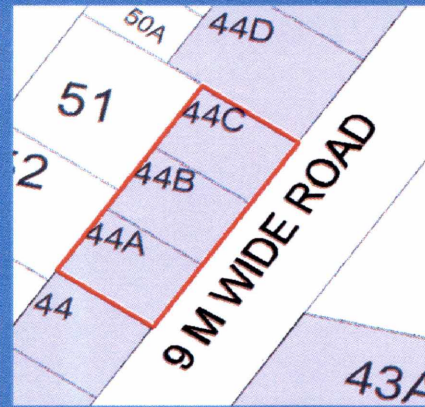
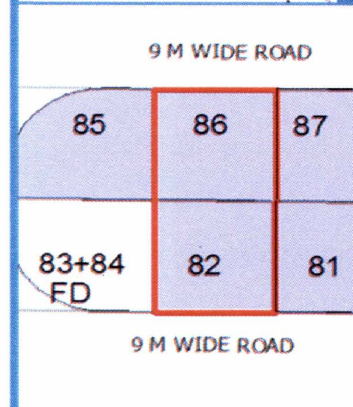
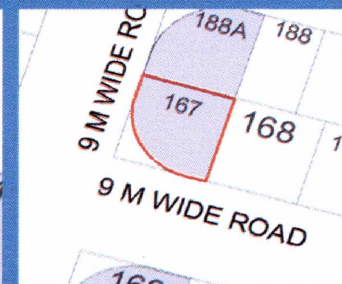
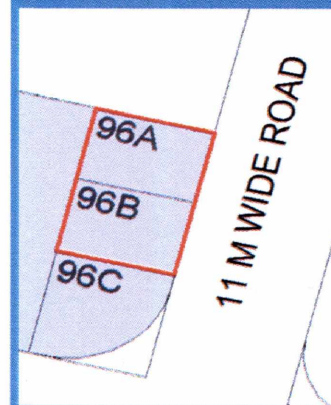

QMM
14/6/17

Satish
14/6/17

N.B. Chaudhary
14/6/17

DRAW OF PLOT OF REHABILITATION AND RESETTLEMENT OF AIRPORT VILLAGES

BLOCK 4	Pocket no.	Sector	Plot no.
Plot Range (Sq m)	1,2	R4	67
	1,2	R1	121, 108, 108A
	1,2	R3	96C
	1,2	R5	44,74,74A
70	4,5,6	24	85,58A
	4,5,6	25A	185,186,186A,56
	4,5,6	25	121B
	3	1	106

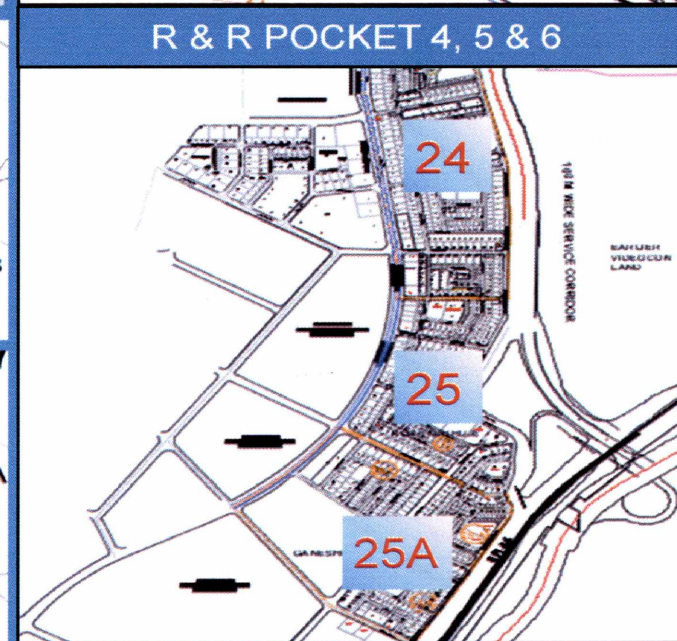
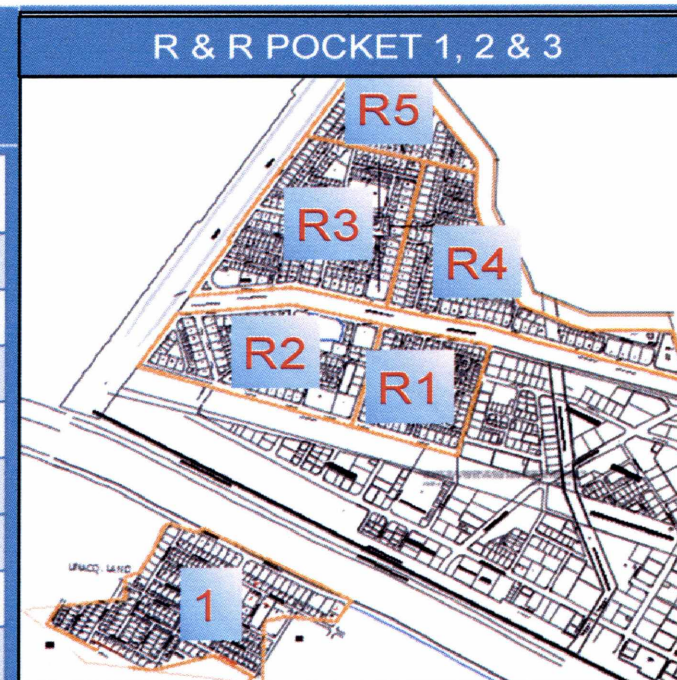

QWNN
14/6/17

Satir
14/6/17

N.B. Chaudhary
1416107

DRAW OF PLOT OF REHABILITATION AND RESETTLEMENT OF AIRPORT VILLAGES

BLOCK 5	Pocket no.	Sector	Plot no.
Plot Range (Sq m)	1,2	R1	166
	1,2	R4	59
80	4,5,6	25A	325
	3	1	106A

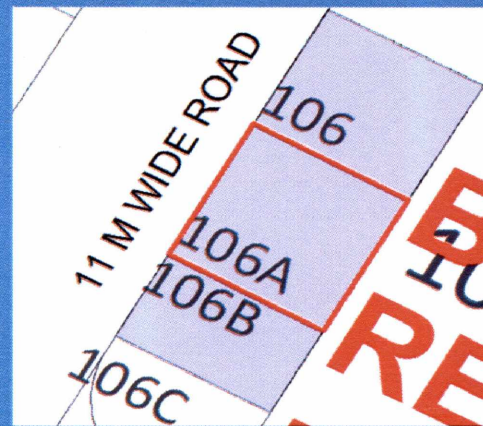
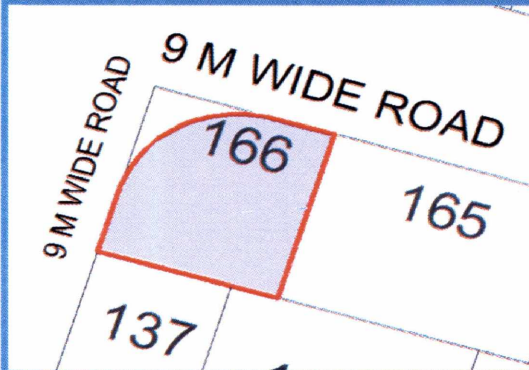

R & R POCKET 1, 2 & 3

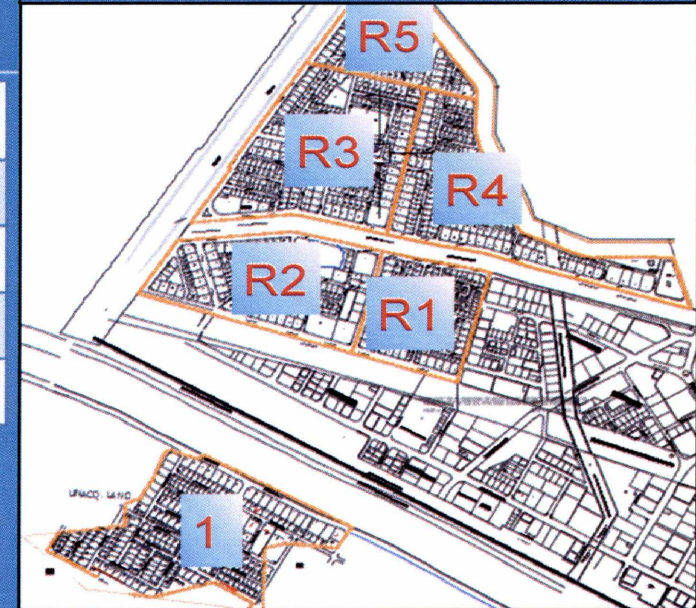

R & R POCKET 4, 5 & 6

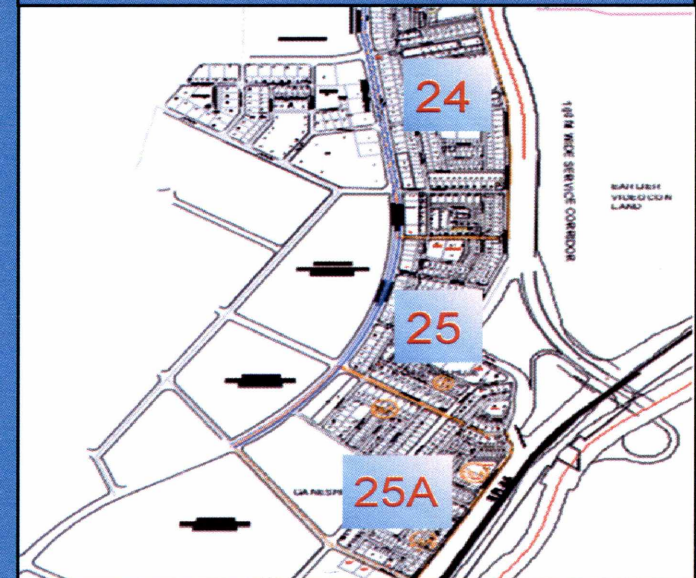

QMM
14/6/17
Satil

N.B. Chaudhary
14/6/17

DRAW OF PLOT OF REHABILITATION AND RESETTLEMENT OF AIRPORT VILLAGES

BLOCK 6	Pocket no.	Sector	Plot no.
Plot Range (Sq m)	1,2	R3	126(A-B)
	1,2	R2	56
90	1,2	R5	44(F-H)
	4,5,6	25A	184
	4,5,6	24	509-510

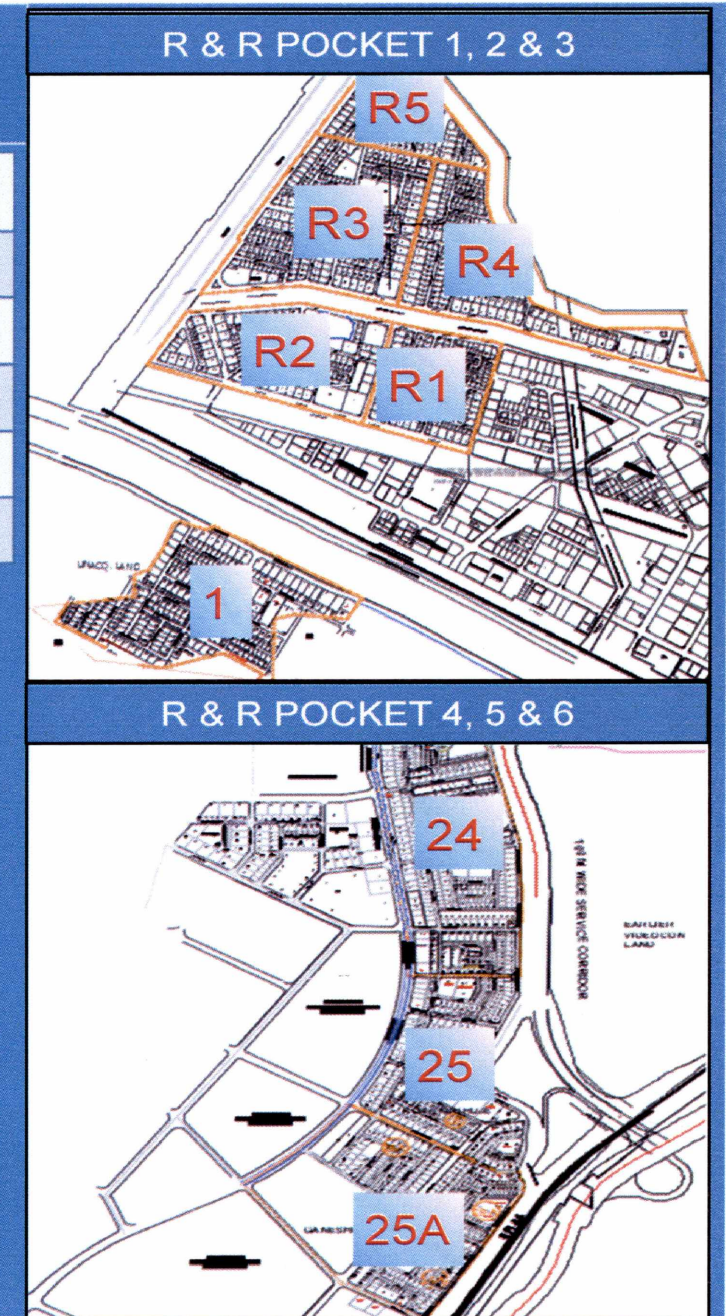
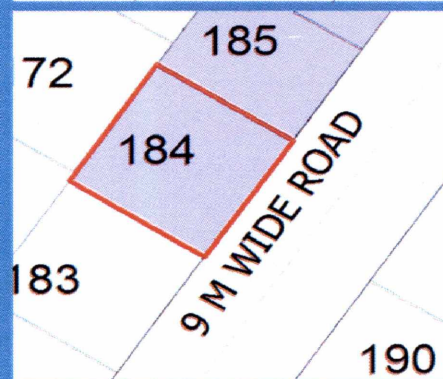
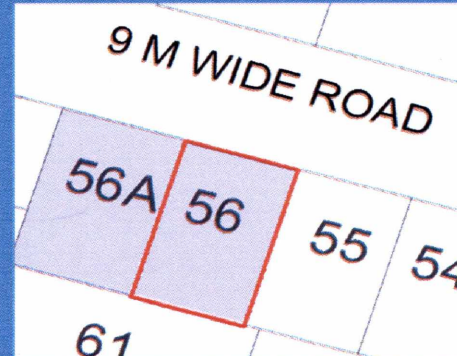
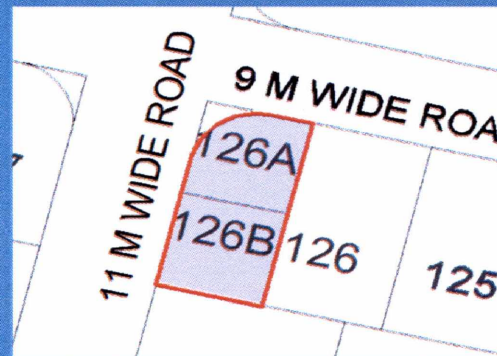

QMM
14/6/17

Satish

N.B. Chaudhary
14/6/17

DRAW OF PLOT OF REHABILITATION AND RESETTLEMENT OF AIRPORT VILLAGES

BLOCK 7	Pocket no.	Sector	Plot no.
Plot Range (Sq m)	3	1	60C, 28(E-F)
	1,2	R3	119
	1,2	R2	56A, 140(A-B)
	1,2	R5	55
100	1,2	R1	122
	4,5,6	24	508
	4,5,6	25A	195

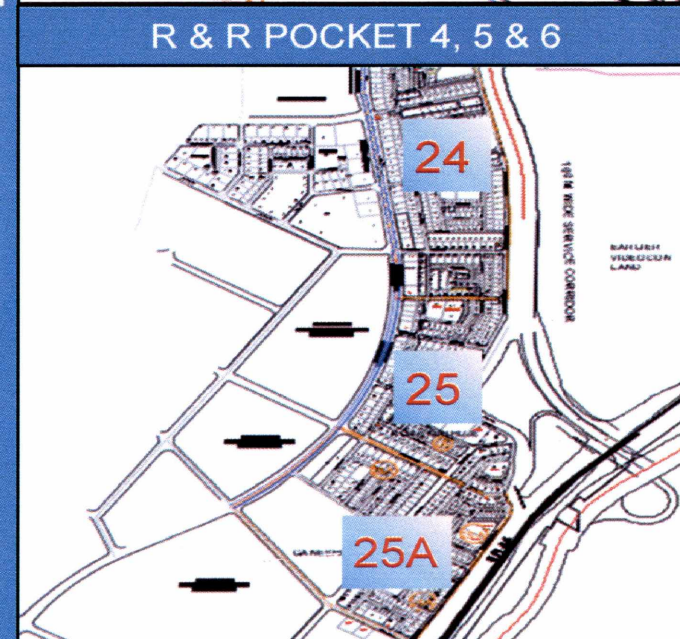
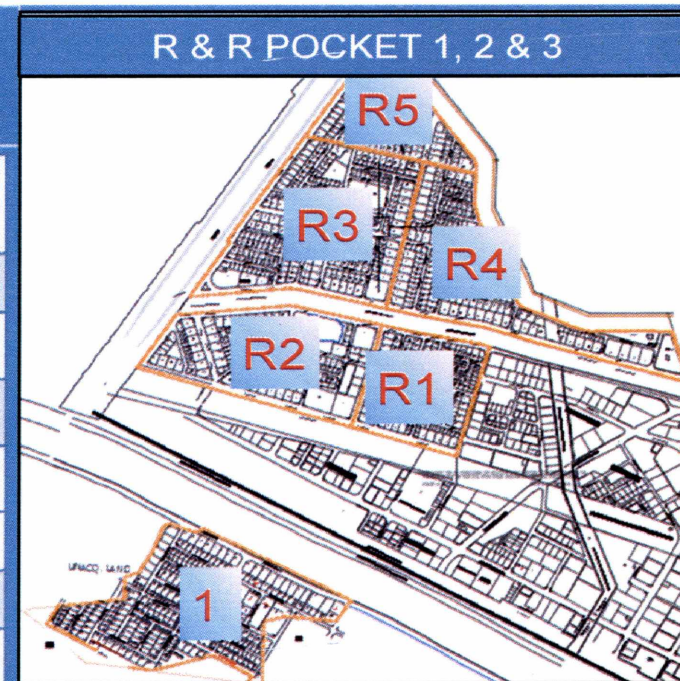

9mm
14/6/17

Satish

N.B. Chaudhori
14/6/17

**DRAW OF PLOT OF REHABILITATION AND
RESETTLEMENT OF AIRPORT VILLAGES**

BLOCK 8	Pocket no.	Sector	Plot no.
Plot Range (Sq m)	1,2	R5	128, 128A
100,120			

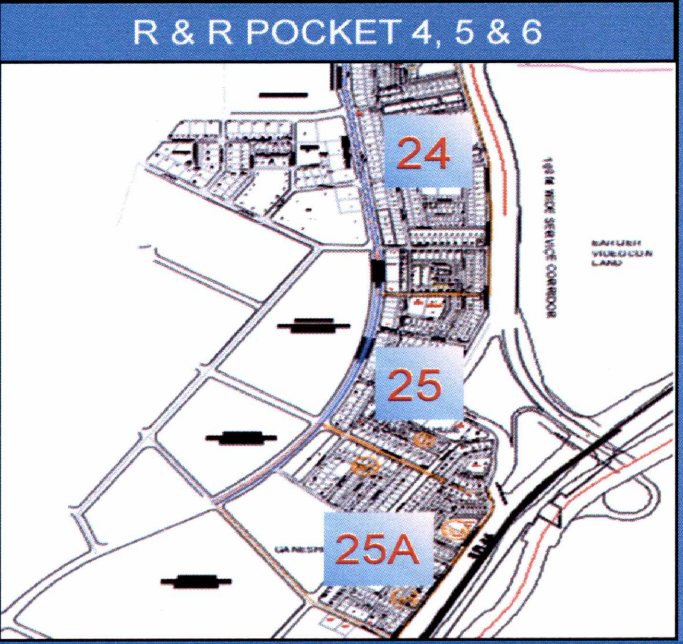
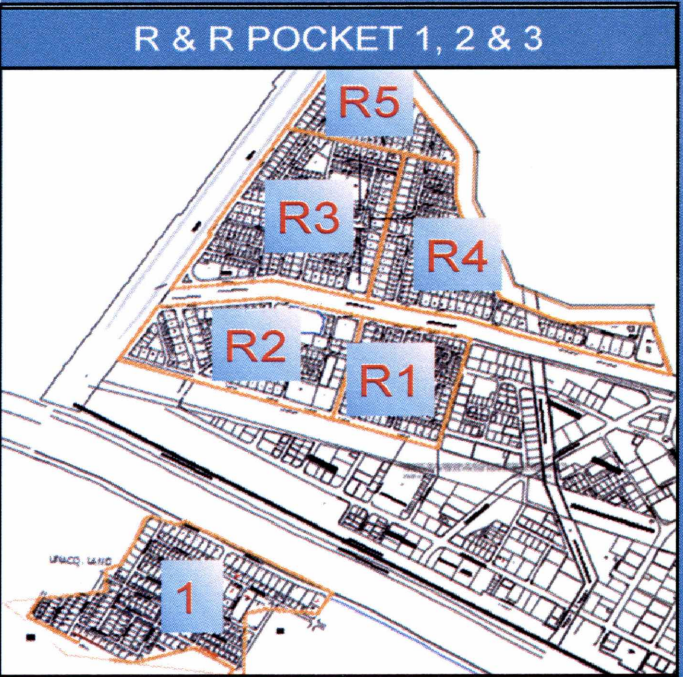
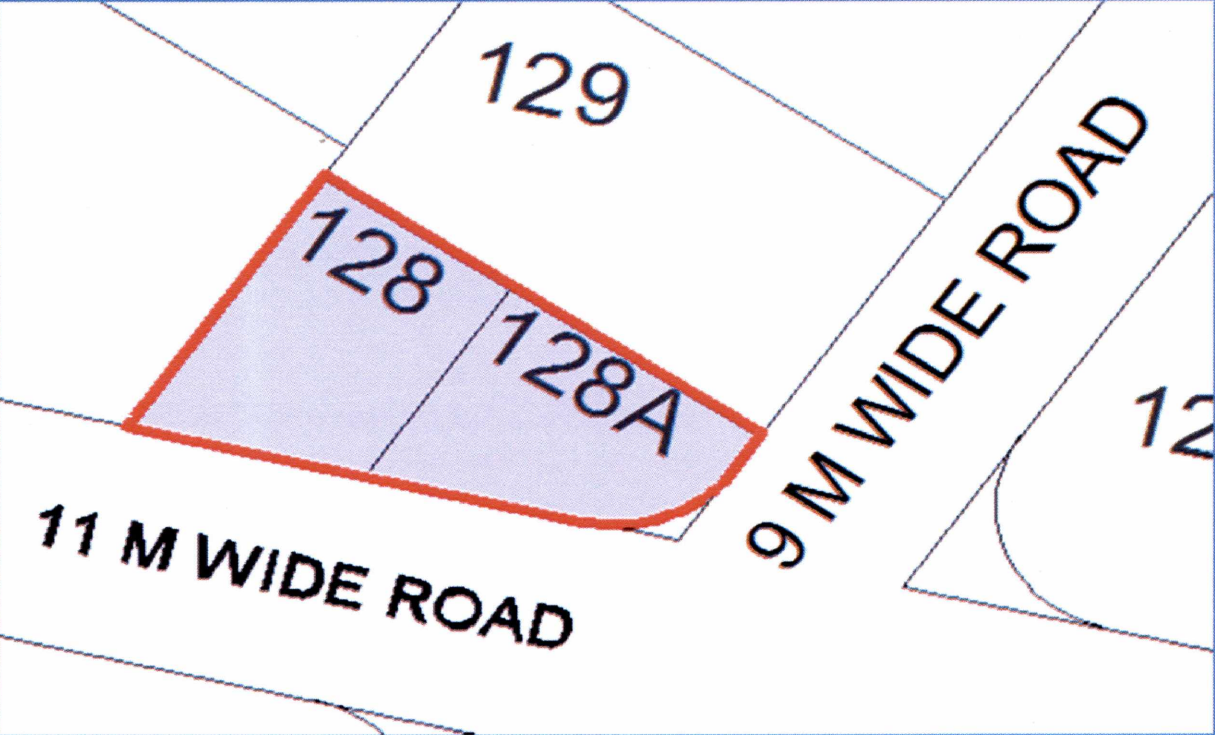

QMM
14/6/17

satil

N.B. Chaudhary
14/6/17

DRAW OF PLOT OF REHABILITATION AND RESETTLEMENT OF AIRPORT VILLAGES

BLOCK 9	Pocket no.	Sector	Plot no.
Plot Range (Sq m)	1,2	R2	18E, 103
	1,2	R5	44(D-E)
110	4,5,6	25A	326
	4,5,6	24	94-95
	3	1	63

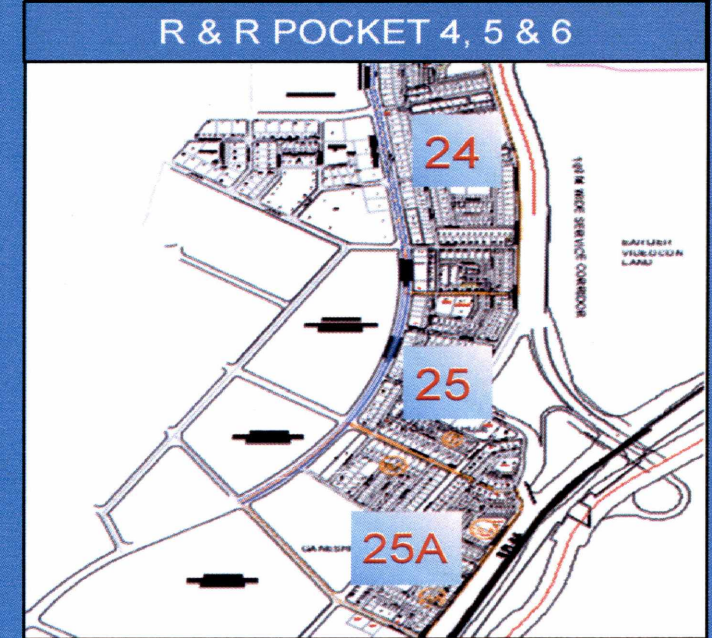
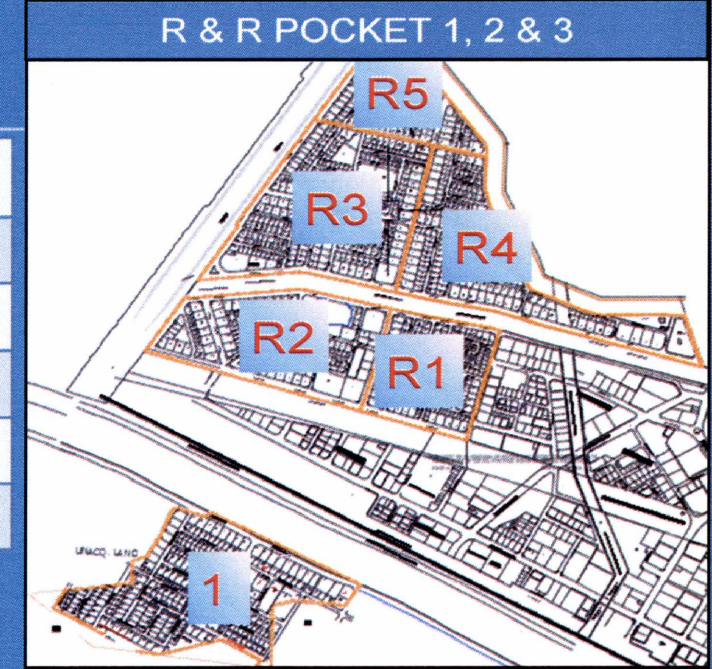
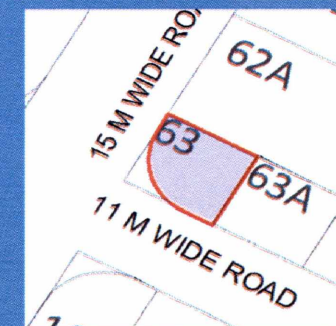
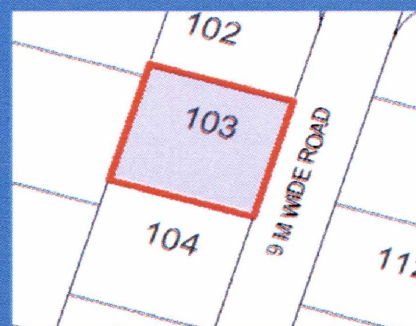
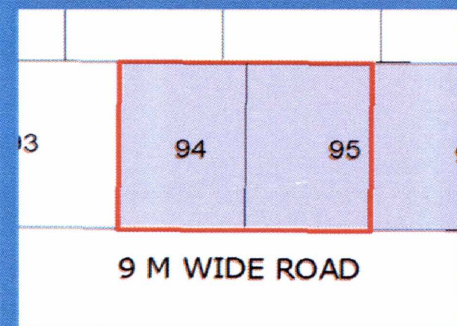
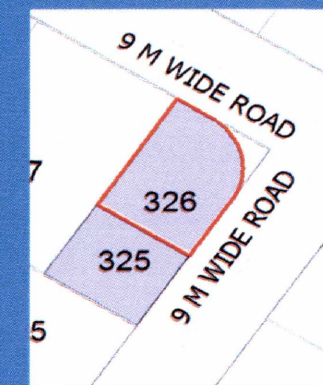
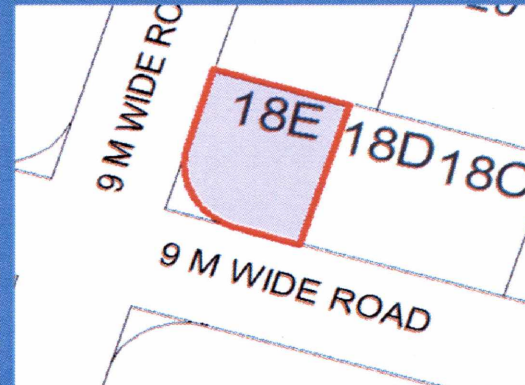
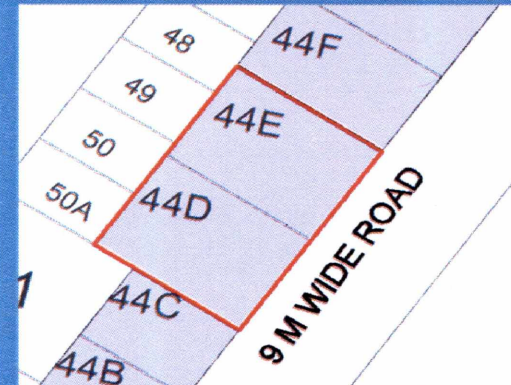

QWV
19/6/17

Satish

N.B.Chandhari
14/6/17

DRAW OF PLOT OF REHABILITATION AND RESETTLEMENT OF AIRPORT VILLAGES

BLOCK 10	Pocket no.	Sector	Plot no.
Plot Range (Sq m)	1,2	R1	151
	1,2	R2	74
130	4,5,6	24	96-97
	3	1	63A

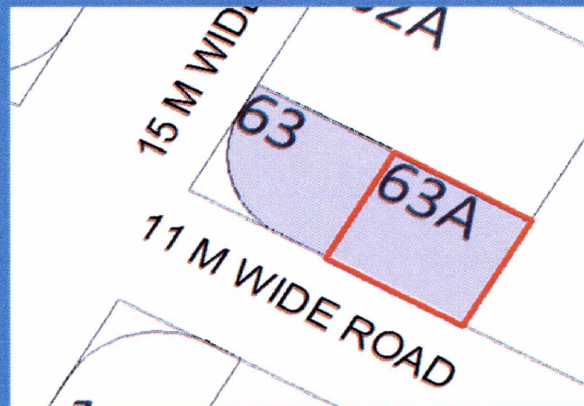
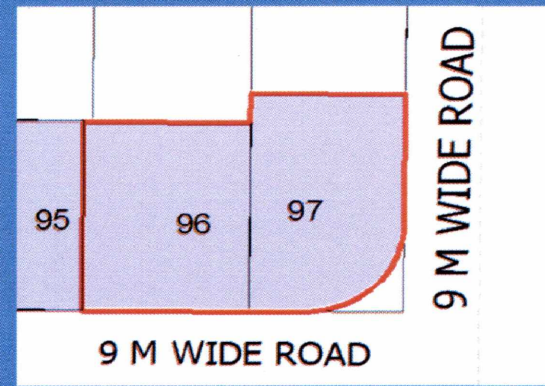
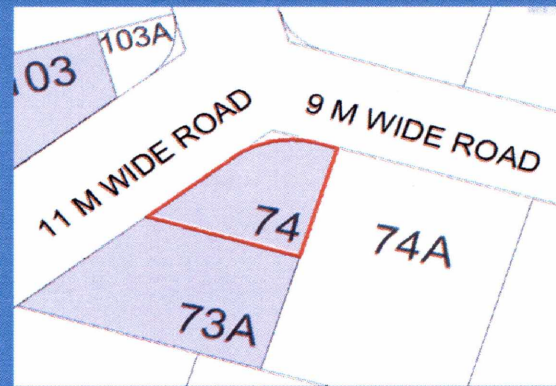
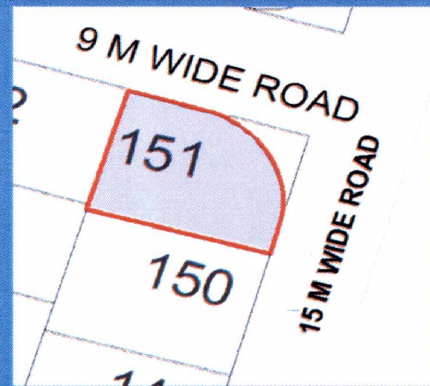

R & R POCKET 1, 2 & 3

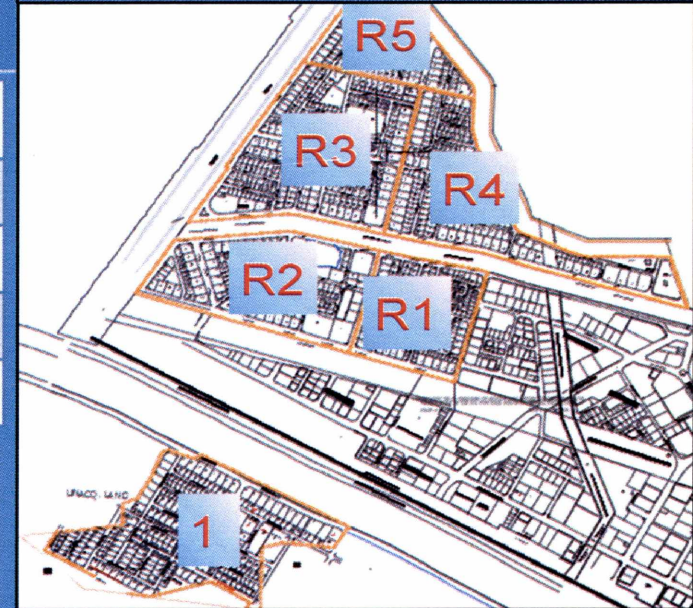

R & R POCKET 4, 5 & 6

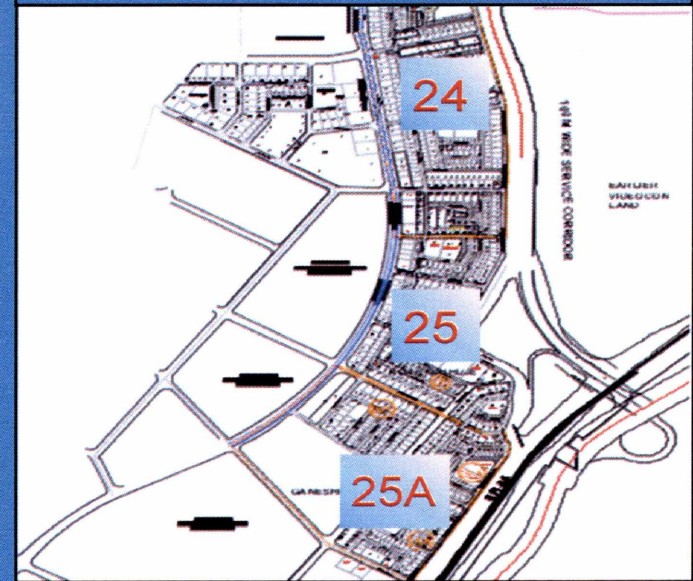

QMM
14/6/17

Satish

N.B. Chaudhary
14/6/17

DRAW OF PLOT OF REHABILITATION AND RESETTLEMENT OF AIRPORT VILLAGES

BLOCK 11	Pocket no.	Sector	Plot no.
Plot Range (Sq m)	4,5,6	25A	32(C-H), 33(A-H)
130, 150, 160, 220			

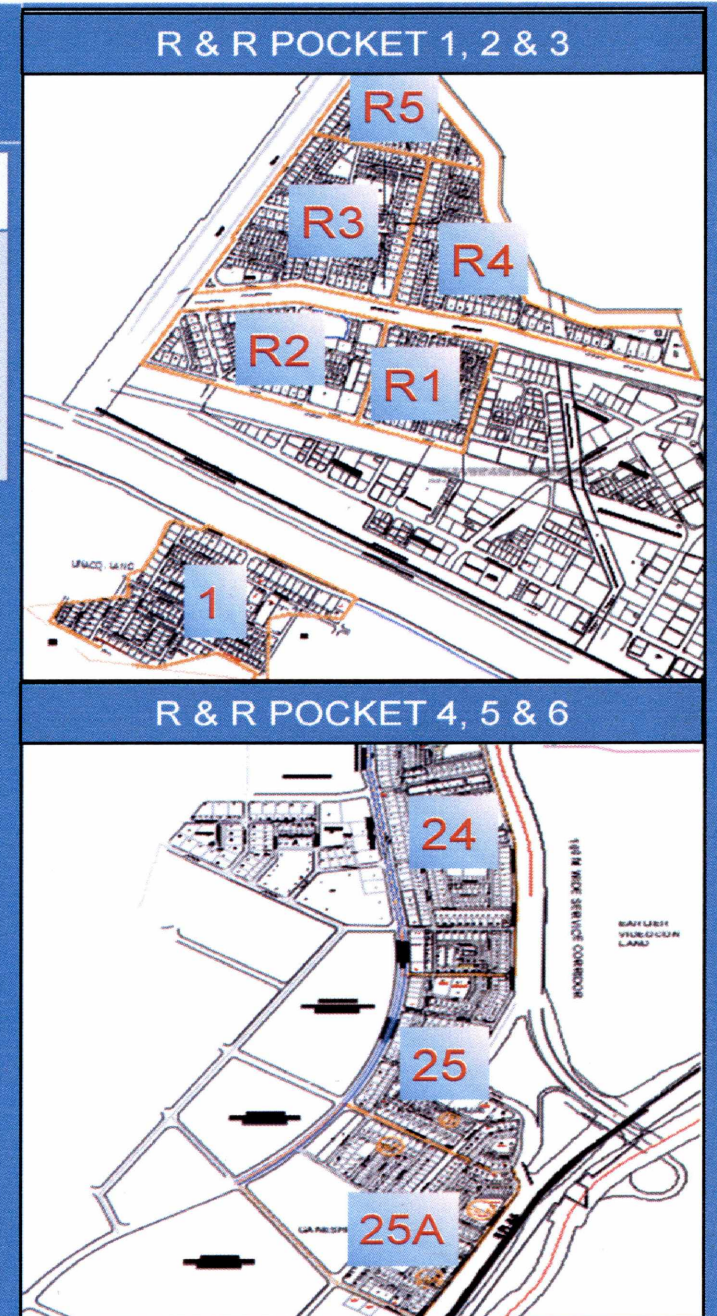
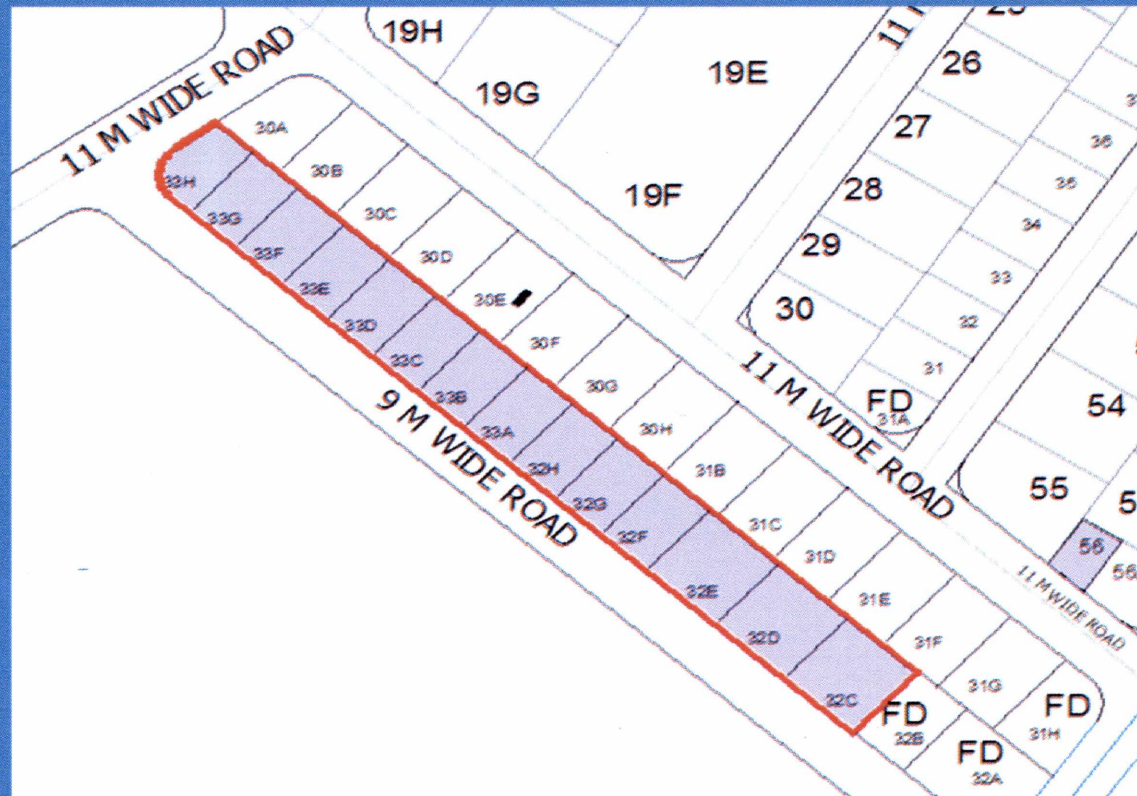

QMM
14/6/17
Satil

N.B. Chaudhary
14/6/17

DRAW OF PLOT OF REHABILITATION AND RESETTLEMENT OF AIRPORT VILLAGES

BLOCK 12	Pocket no.	Sector	Plot no.
Plot Range (Sq m)	4,5,6	24	518, 536-540
	4,5,6	25	73
140	1,2	R4	65+66
	3	1	166

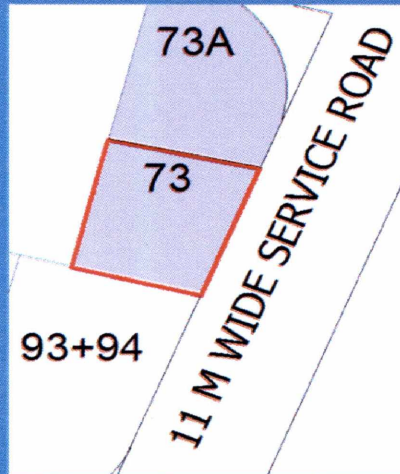
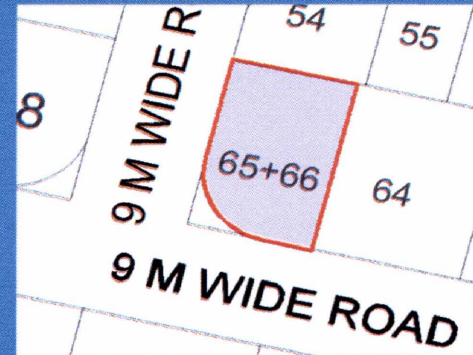
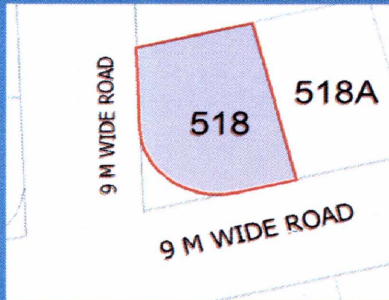

R & R POCKET 1, 2 & 3

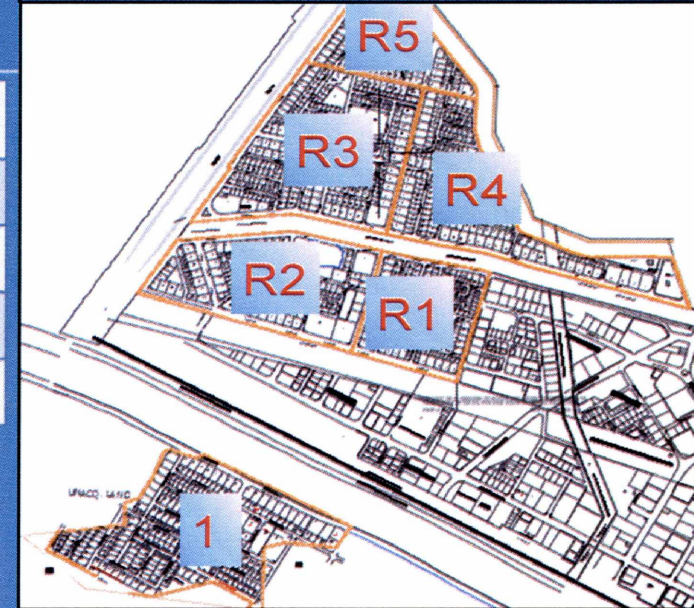

R & R POCKET 4, 5 & 6

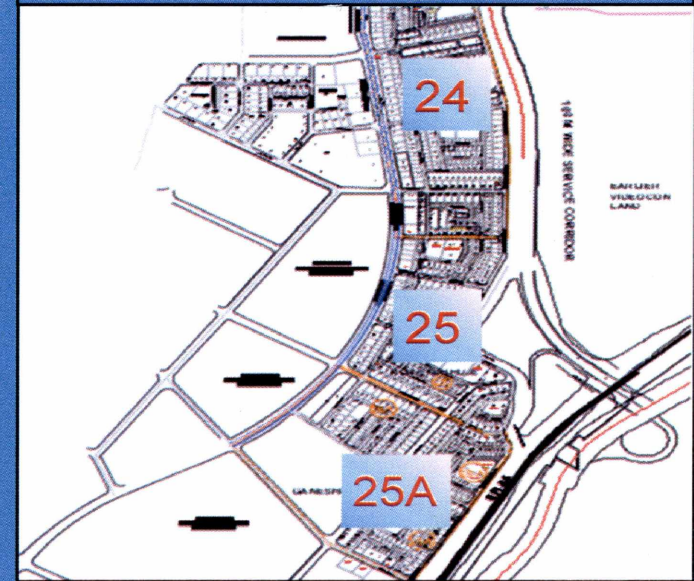

QMM
14/6/17
Satel

N.B. Chaudhary
14/6/17

DRAW OF PLOT OF REHABILITATION AND RESETTLEMENT OF AIRPORT VILLAGES

BLOCK 13	Pocket no.	Sector	Plot no.
Plot Range (Sq m)	4,5,6	24	542-545
	4,5,6	25	328E,169
150	1,2	R3	34B

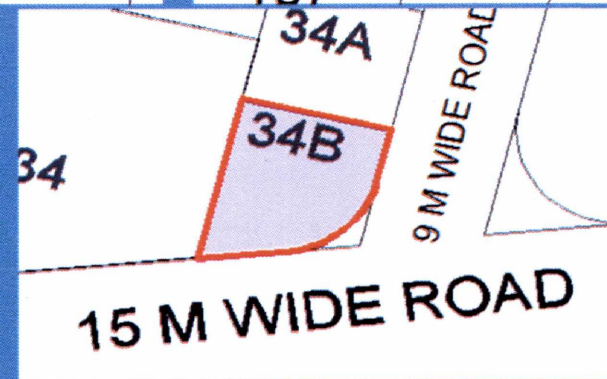
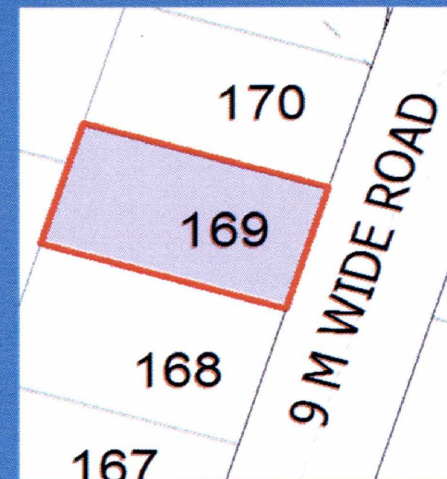
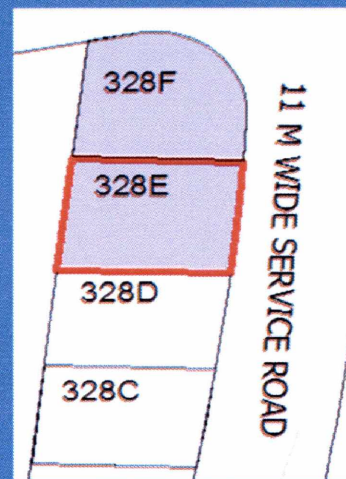
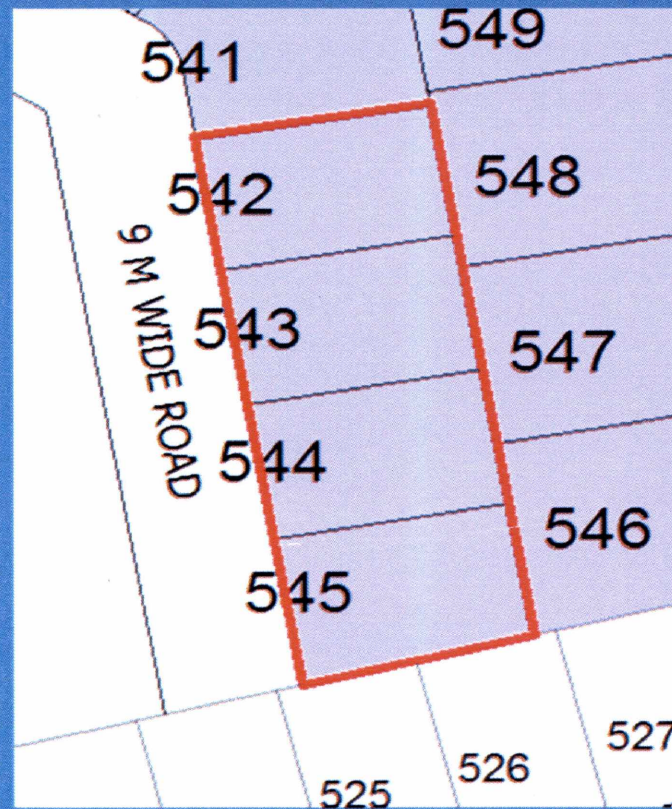

R & R POCKET 1, 2 & 3

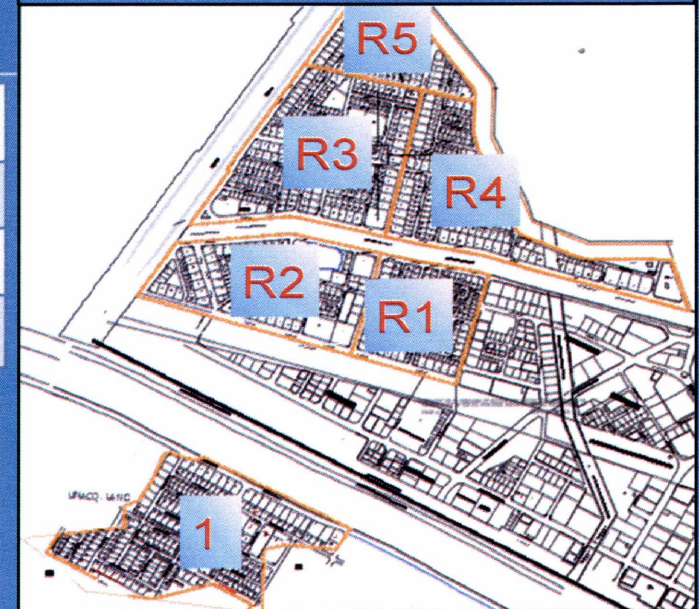

R & R POCKET 4, 5 & 6

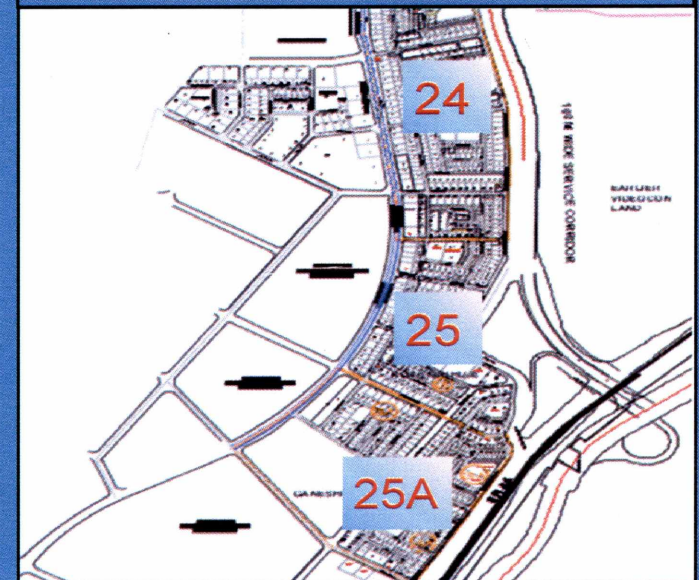

QMM
14/6/17

Satir

N.B. Chaudhary
14/6/17

DRAW OF PLOT OF REHABILITATION AND RESETTLEMENT OF AIRPORT VILLAGES

BLOCK 14	Pocket no.	Sector	Plot no.
Plot Range (Sq m)	4,5,6	24	47-48, 511
160	1,2	R4	22, 207, 207A

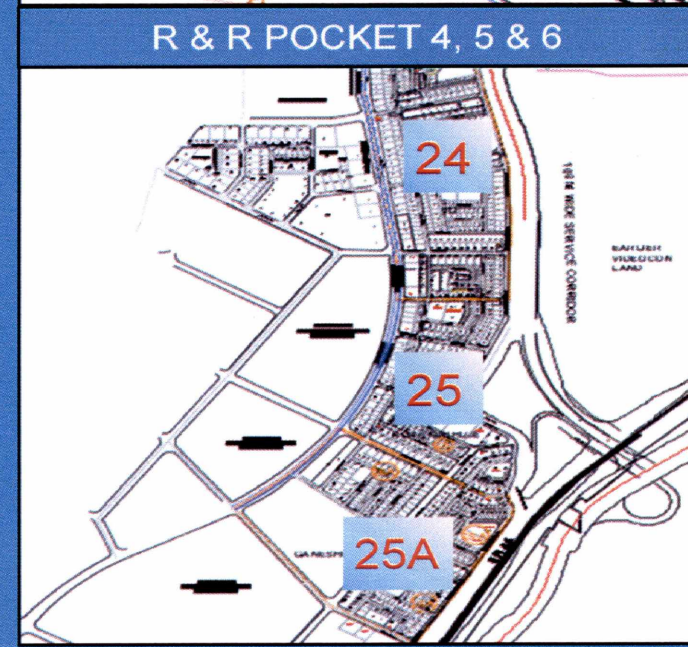
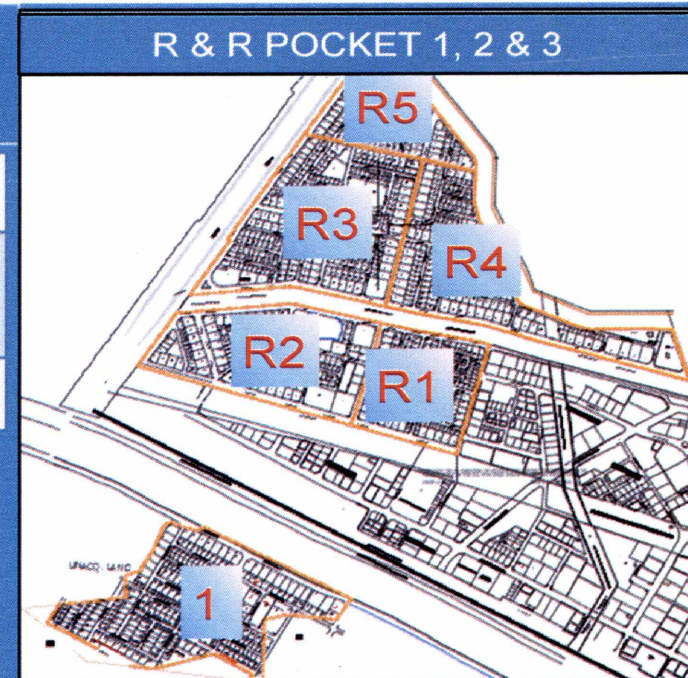
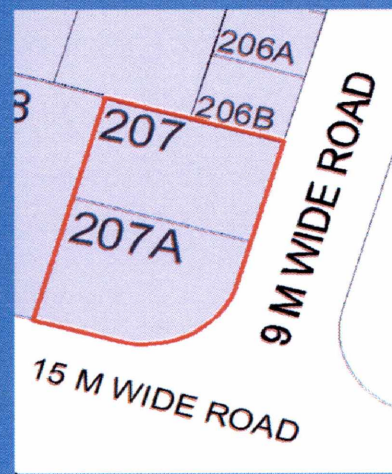
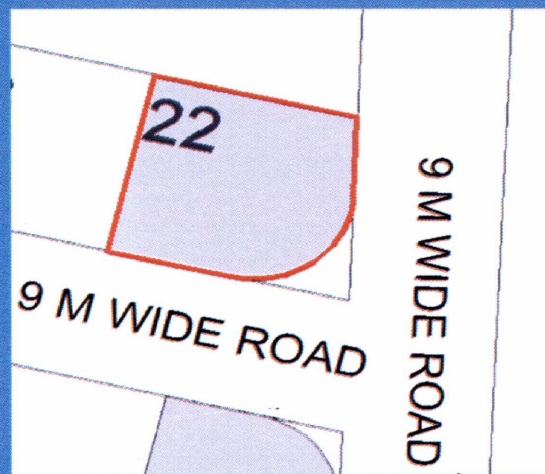
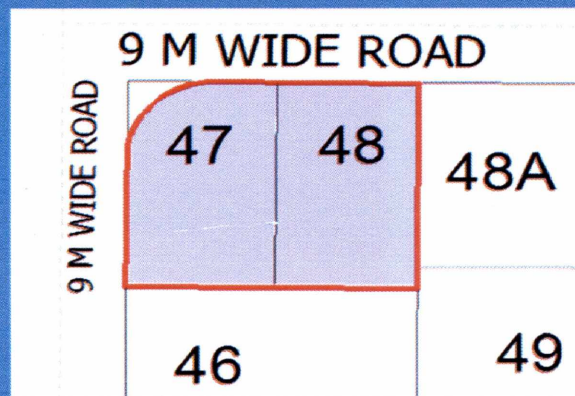

9 MM
14/6/17

Satish

N.B. Chaudhary
14/6/17

DRAW OF PLOT OF REHABILITATION AND RESETTLEMENT OF AIRPORT VILLAGES

BLOCK 15	Pocket no.	Sector	Plot no.
Plot Range (Sq m)	4,5,6	25	73A,154
170			

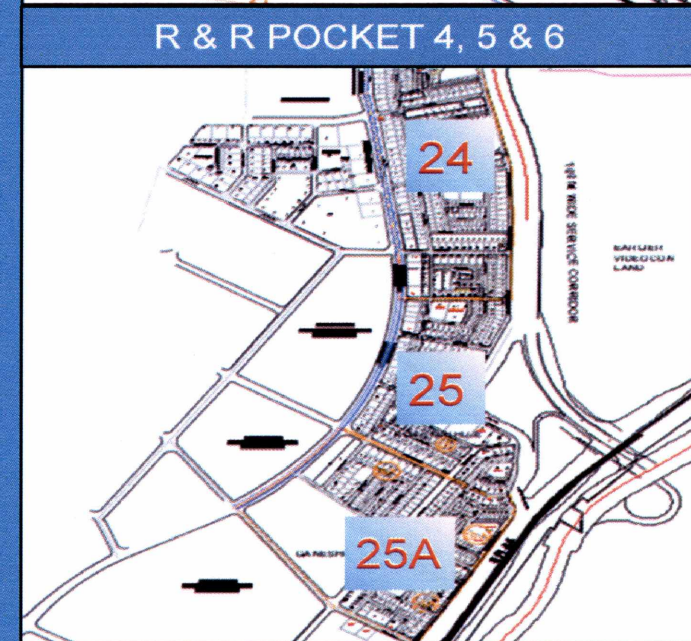
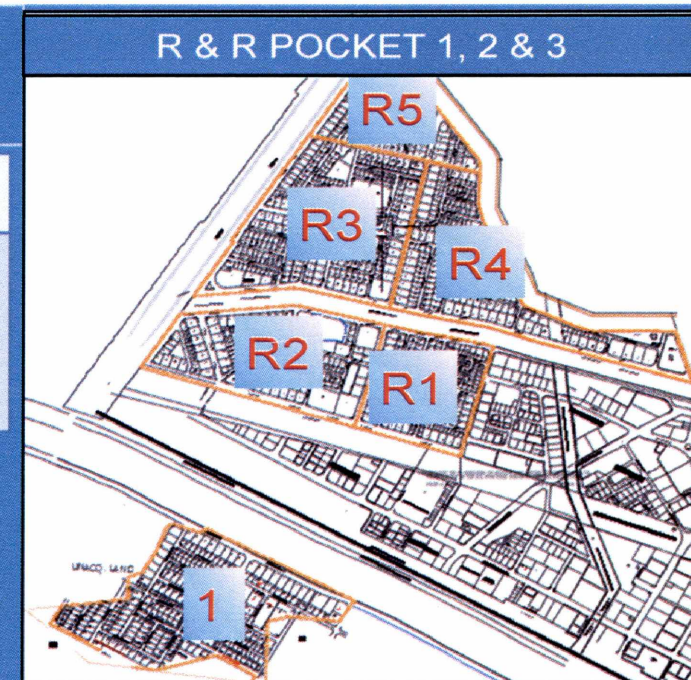
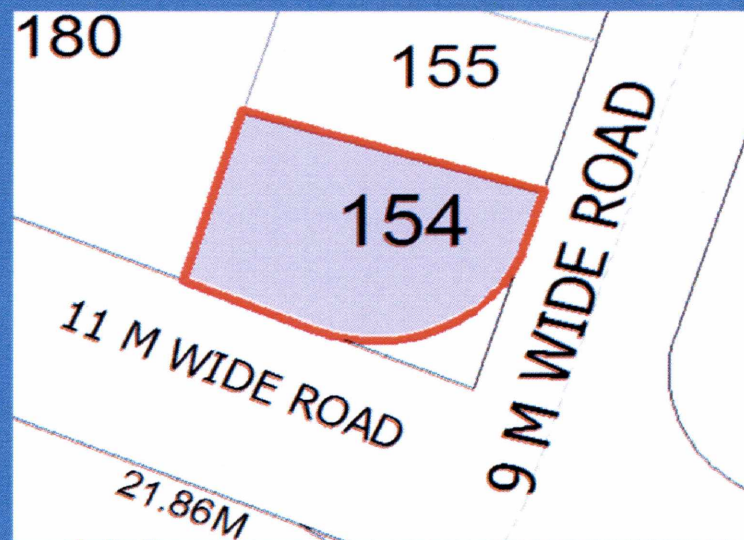

QMM
14/6/17
Satil

N.B. Chaudhary
14/6/17

DRAW OF PLOT OF REHABILITATION AND RESETTLEMENT OF AIRPORT VILLAGES

BLOCK 16	Pocket no.	Sector	Plot no.
Plot Range (Sq m)	1,2	R4	32
	4,5,6	24	149, 475, 476
180	4,5,6	25	328F

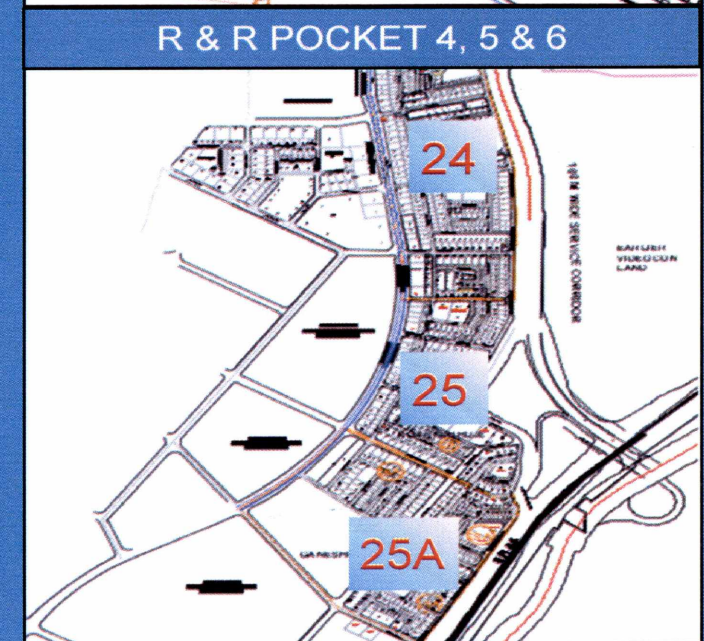
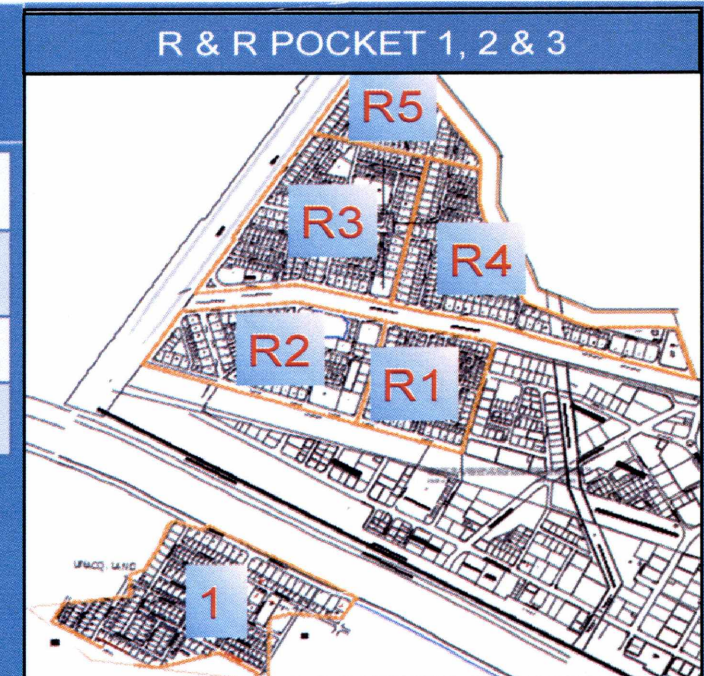
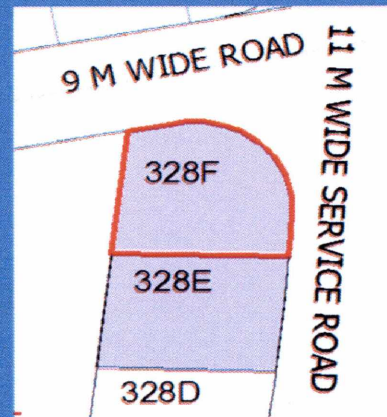
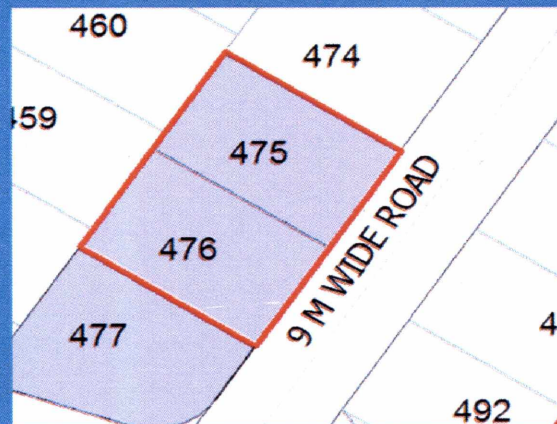
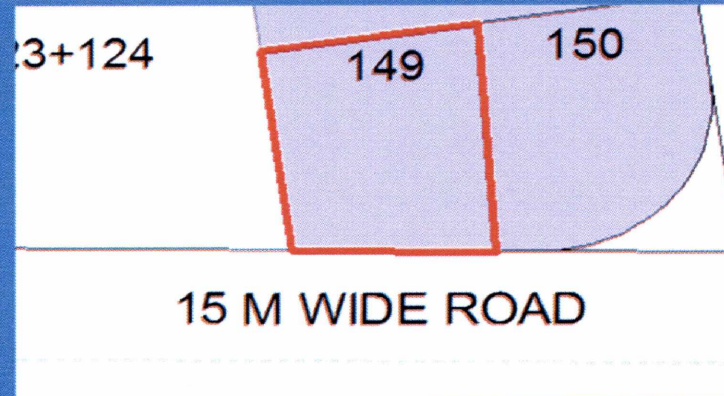
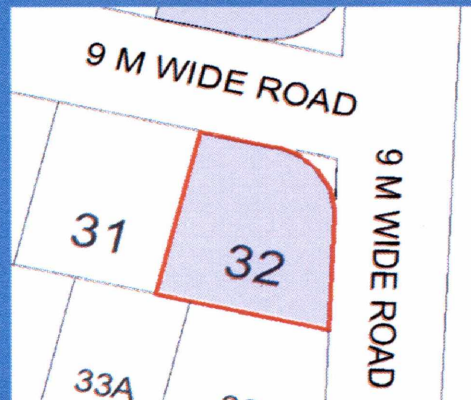

QMM
14/6/17

Satish

N.B. Chaudhary
14/6/17

DRAW OF PLOT OF REHABILITATION AND RESETTLEMENT OF AIRPORT VILLAGES

BLOCK 17	Pocket no.	Sector	Plot no.
Plot Range (Sq m)	4,5,6	25A	30(A-H), 31(B-G)
180,190,200, 210,220			

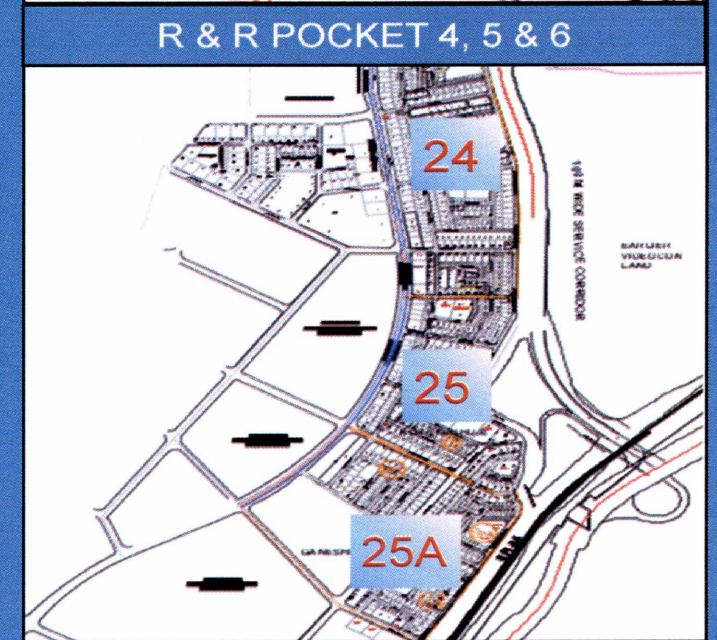
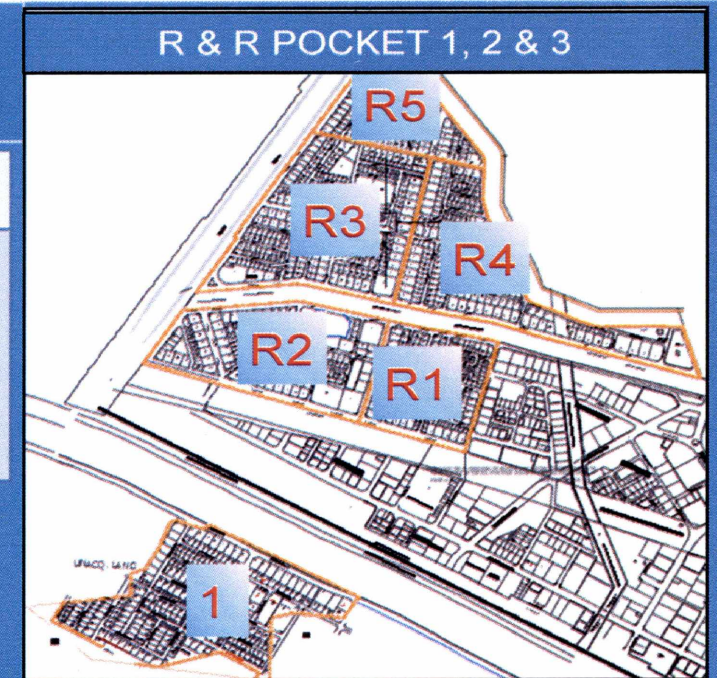
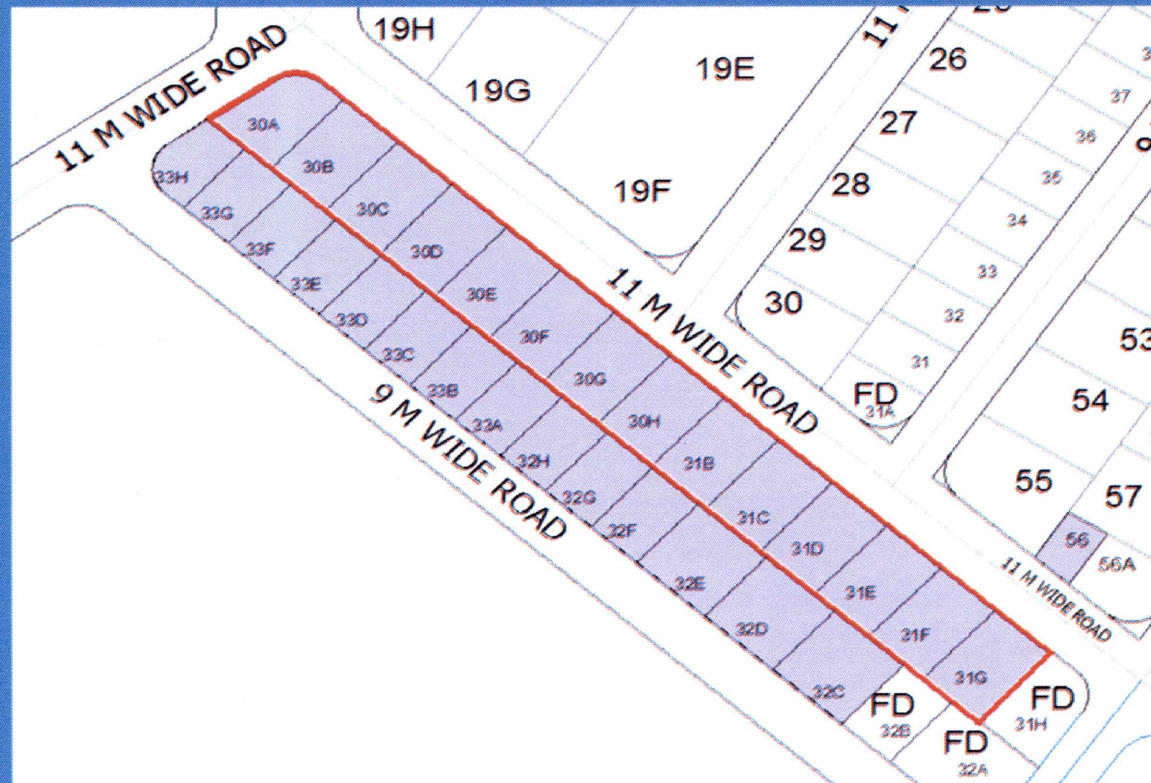

QMM
14/6/17

Satish

N.B. Chaudhary
14/6/17

DRAW OF PLOT OF REHABILITATION AND RESETTLEMENT OF AIRPORT VILLAGES

BLOCK 18	Pocket no.	Sector	Plot no.
Plot Range (Sq m)	4,5,6	24	150, 399B
190	4,5,6	25	238, 29

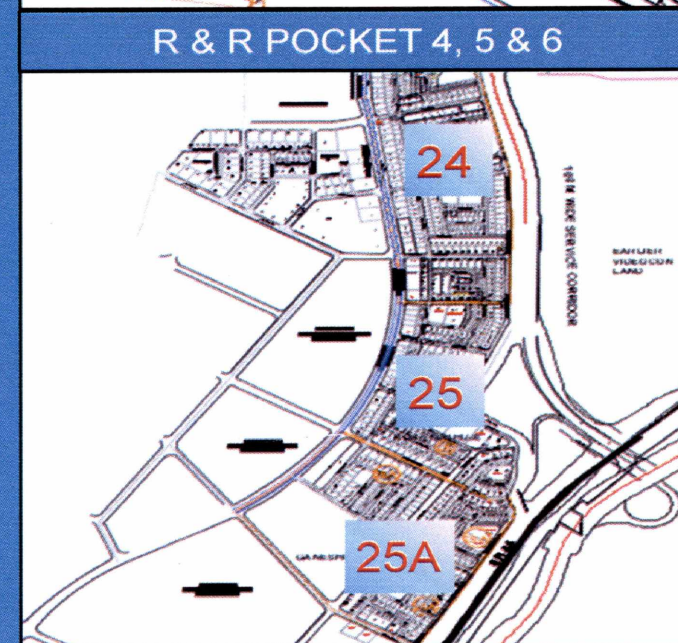
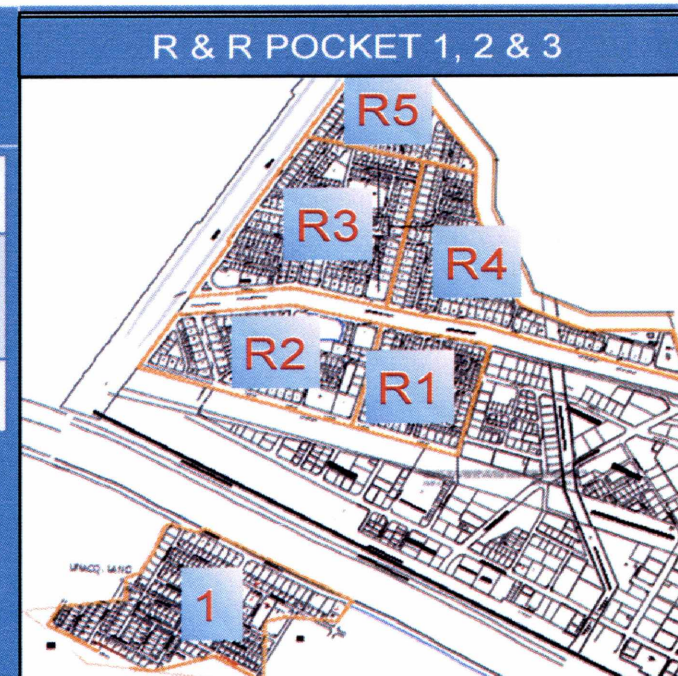
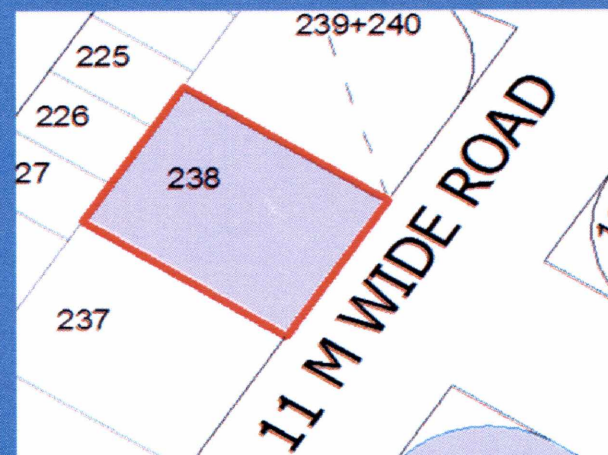
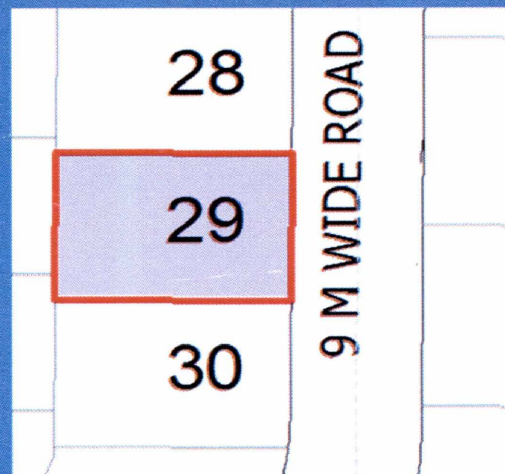
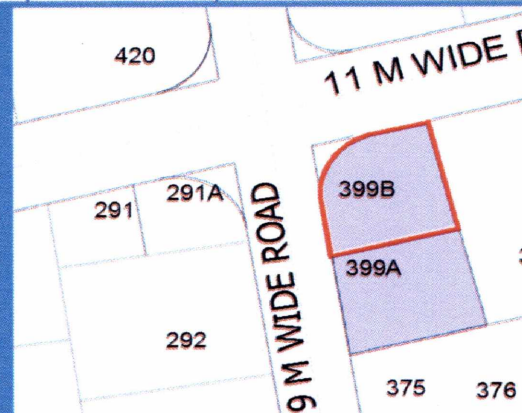
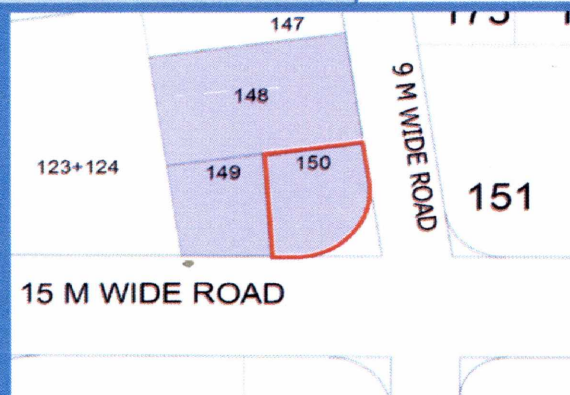

9mm
14/6/17

Salil

N.B. Chaudhary
14/6/17

DRAW OF PLOT OF REHABILITATION AND RESETTLEMENT OF AIRPORT VILLAGES

BLOCK 19	Pocket no.	Sector	Plot no.
Plot Range (Sq m)	1,2	R5	65,73
200	4,5,6	25	250
	1,2	R2	73A

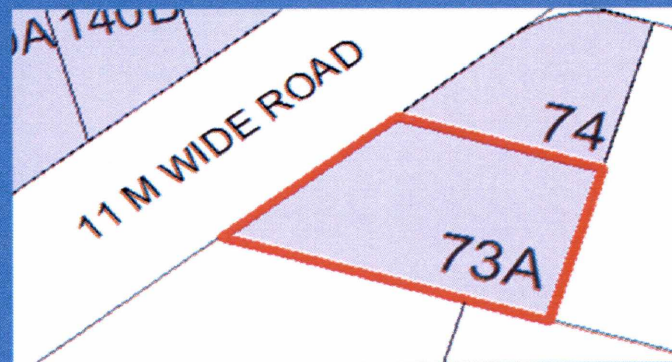
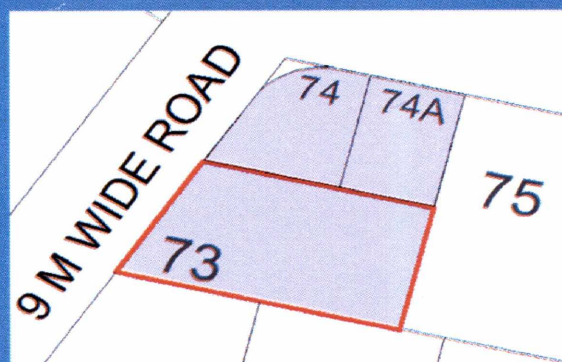
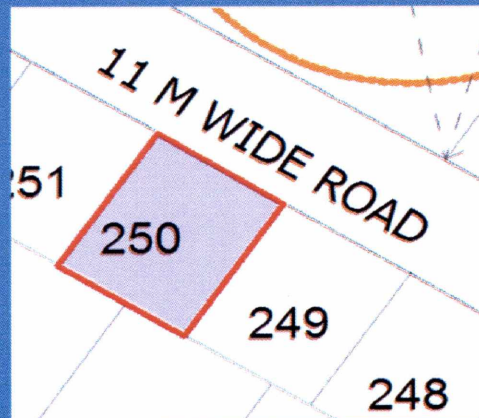
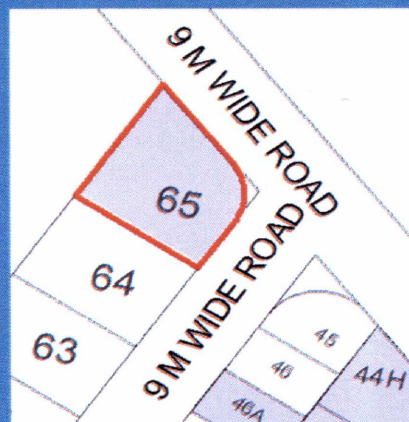

R & R POCKET 1, 2 & 3

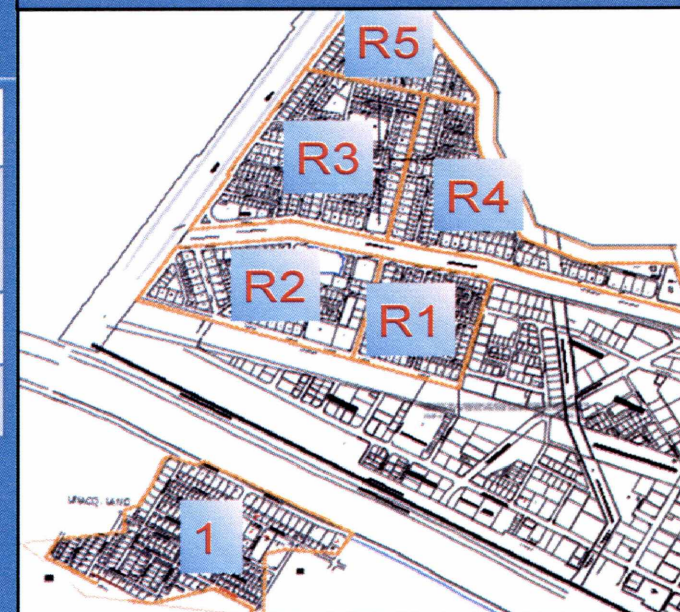

R & R POCKET 4, 5 & 6

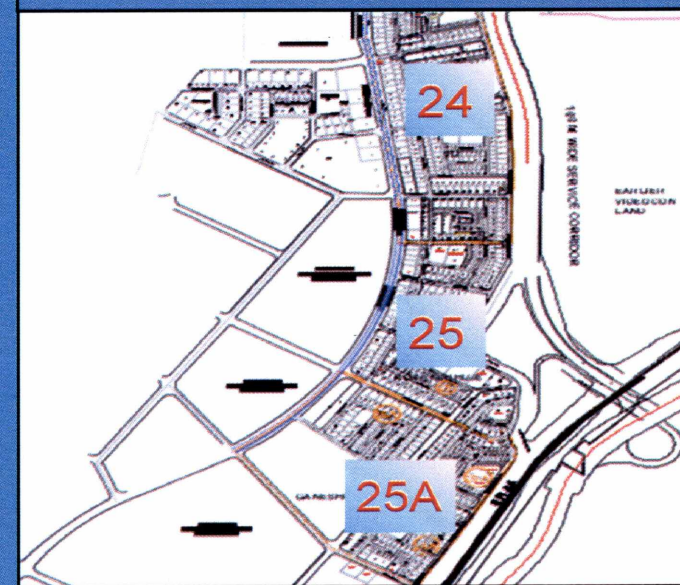

QMM
14/6/17

14/6/17

N.B. Chaudhary
14/6/17

DRAW OF PLOT OF REHABILITATION AND RESETTLEMENT OF AIRPORT VILLAGES

BLOCK 20	Pocket no.	Sector	Plot no.
Plot Range (Sq m)	4,5,6	25A	380+380A
210	4,5,6	24	477,399A

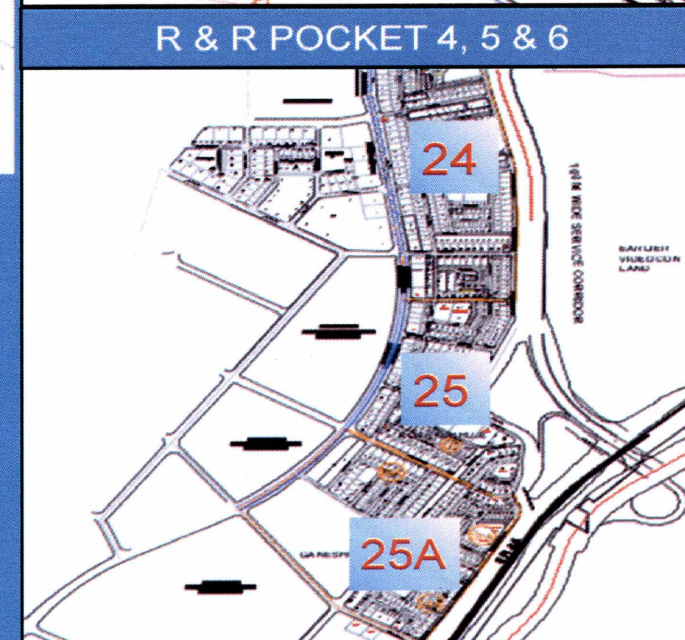
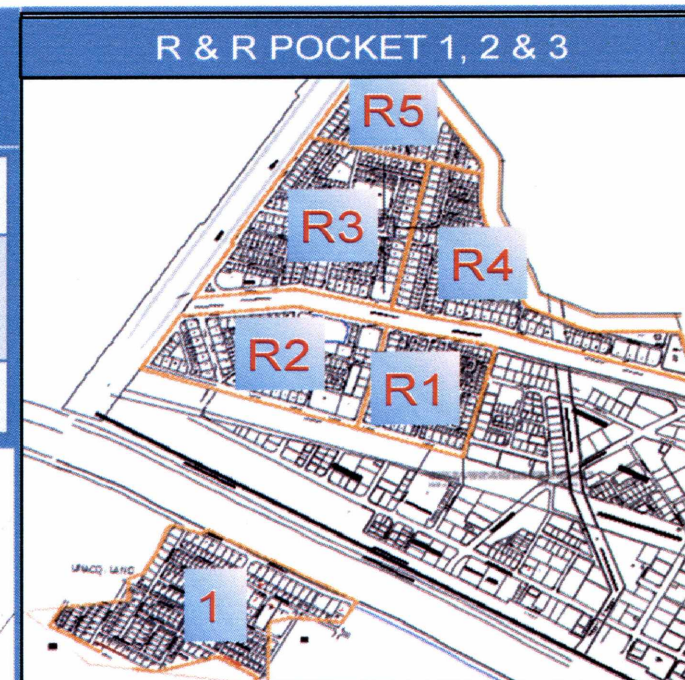
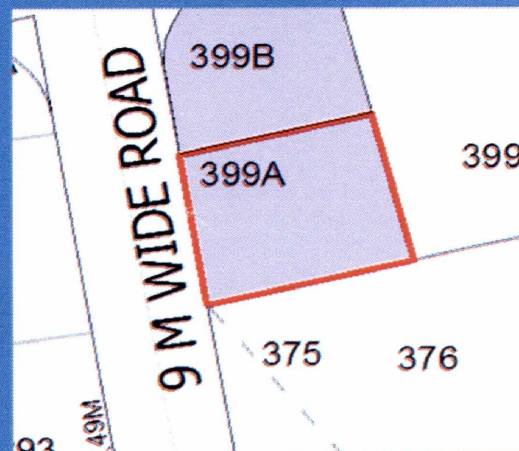
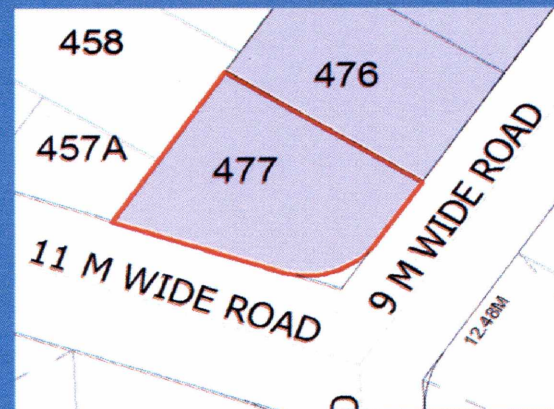

9/11/17
14/6/17

Satish

N.B. Chaudhary
14/6/17

DRAW OF PLOT OF REHABILITATION AND RESETTLEMENT OF AIRPORT VILLAGES

BLOCK 21	Pocket no.	Sector	Plot no.
Plot Range (Sq m)	1,2	R4	42
220	1,2	R5	1

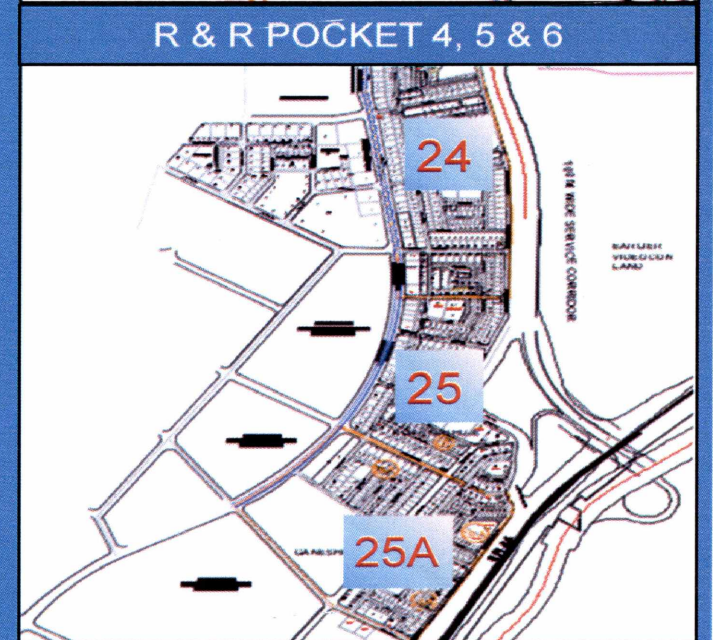
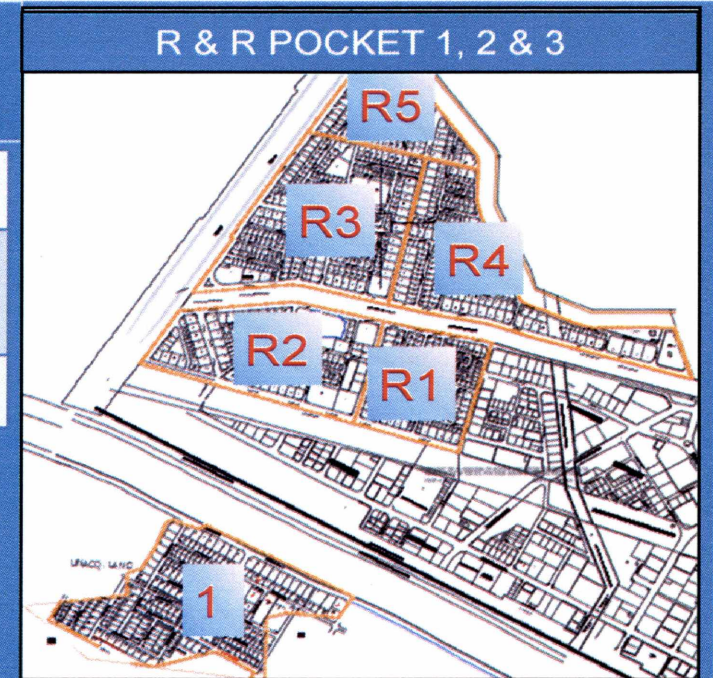
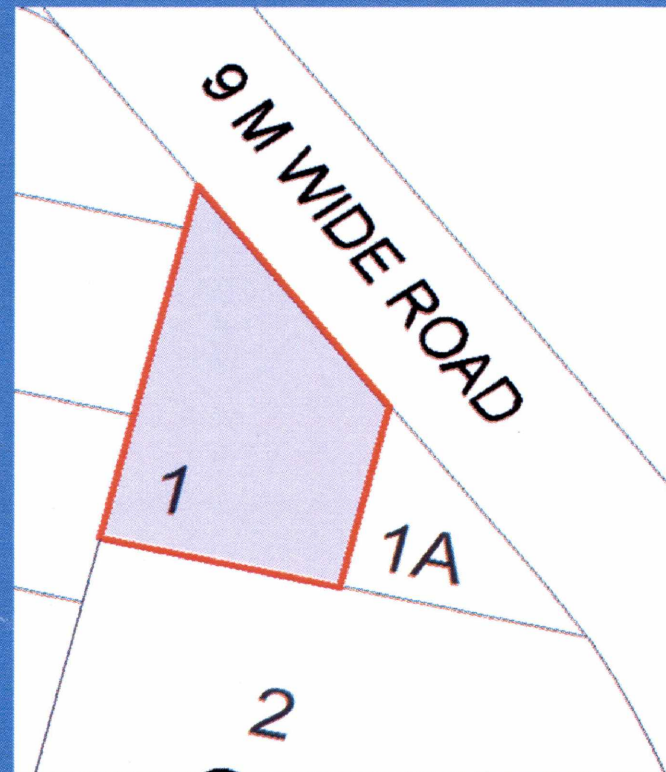

Qum
14/6/17

Salil

N.B. Chaudhari
14/6/17

DRAW OF PLOT OF REHABILITATION AND RESETTLEMENT OF AIRPORT VILLAGES

BLOCK 21	Pocket no.	Sector	Plot no.
Plot Range (Sq m)	1, 2	R4	42
220	1, 2	R5	1

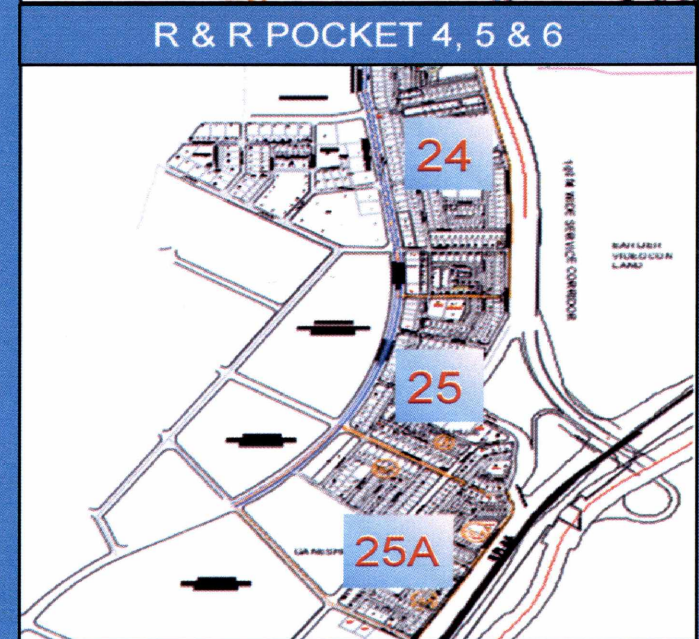
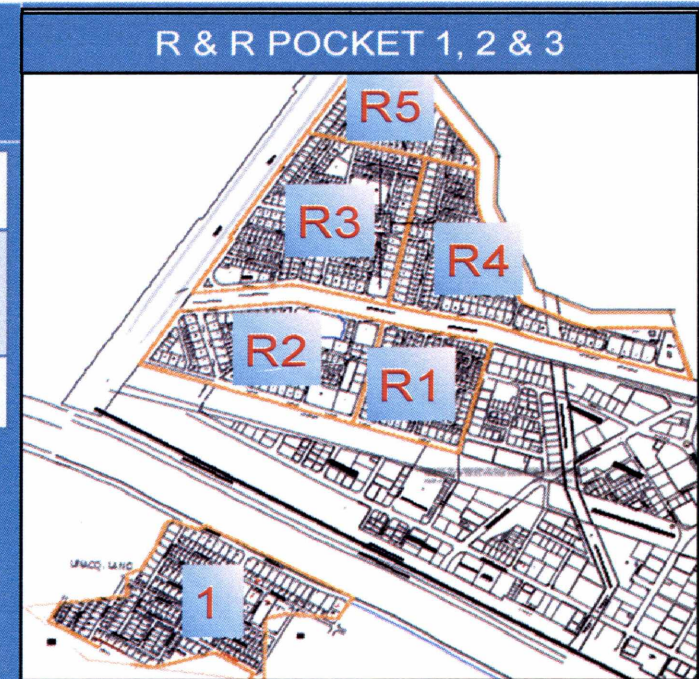

Sum
14/6/17

Satish

N.B. Chaudhari
14/6/17

DRAW OF PLOT OF REHABILITATION AND RESETTLEMENT OF AIRPORT VILLAGES

BLOCK 22	Pocket no.	Sector	Plot no.
Plot Range (Sq m)	1, 2	R5	42, 43
230, 240			

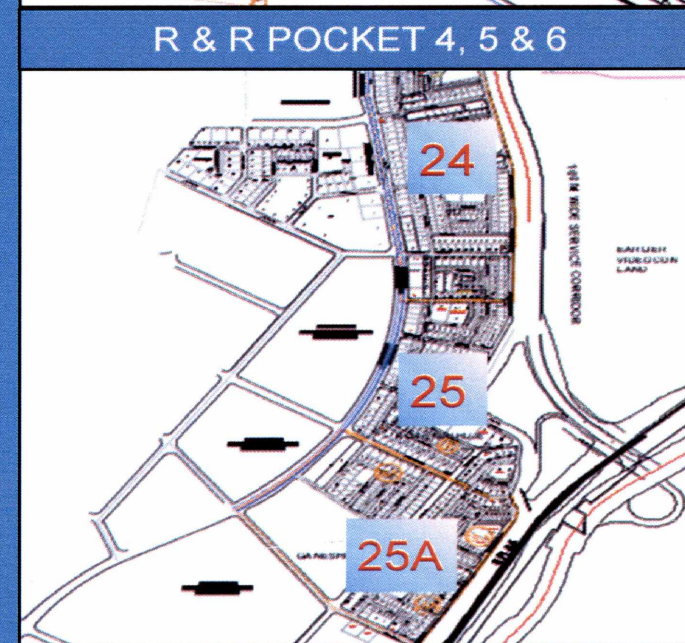
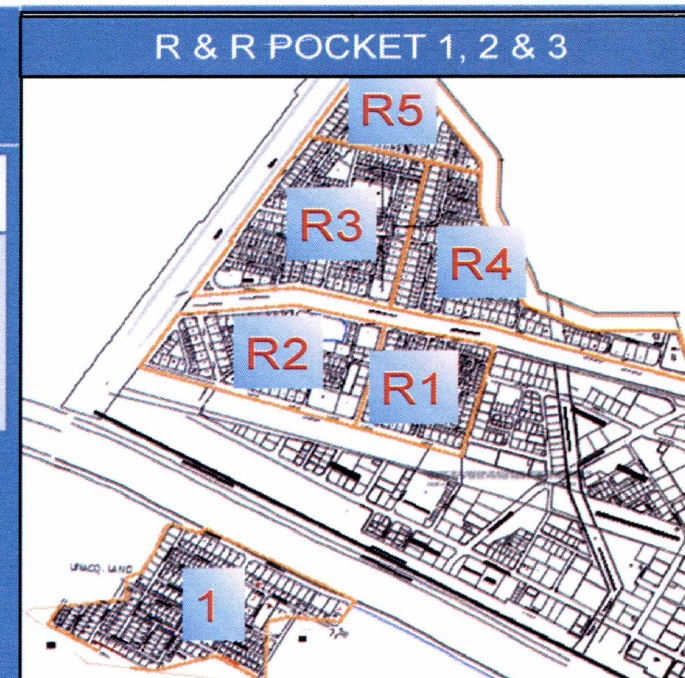

14/6/17

Latil

N.B. Chaudhary
14/6/17

DRAW OF PLOT OF REHABILITATION AND RESETTLEMENT OF AIRPORT VILLAGES

BLOCK 23	Pocket no.	Sector	Plot no.
Plot Range (Sq m)	1, 2	R4	205, 205A, 205B, 205C
230	1, 2	R3	15

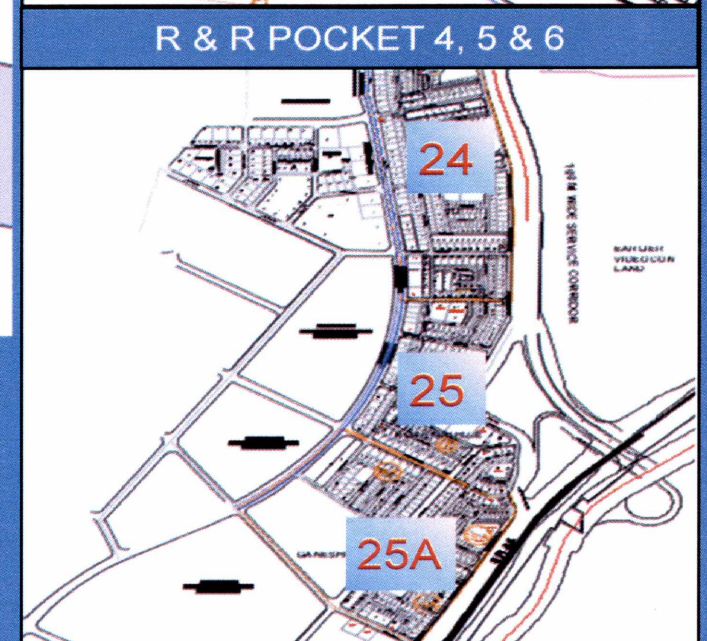
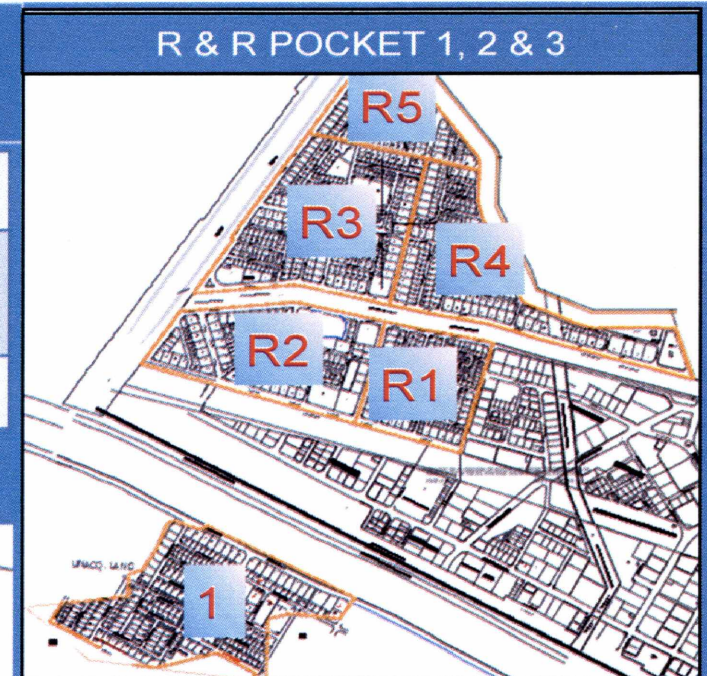
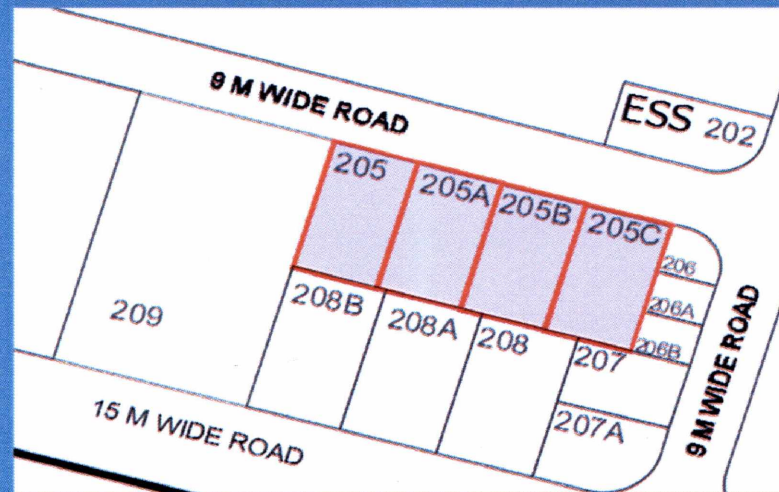

9/11/17
14/6/17

Signature

N.B. Chaudhary
14/6/17

DRAW OF PLOT OF REHABILITATION AND RESETTLEMENT OF AIRPORT VILLAGES

BLOCK 24	Pocket no.	Sector	Plot no.
Plot Range (Sq m)	1, 2	R1	54
		R2	91
		R3	140
260	4, 5, 6	24	553, 554

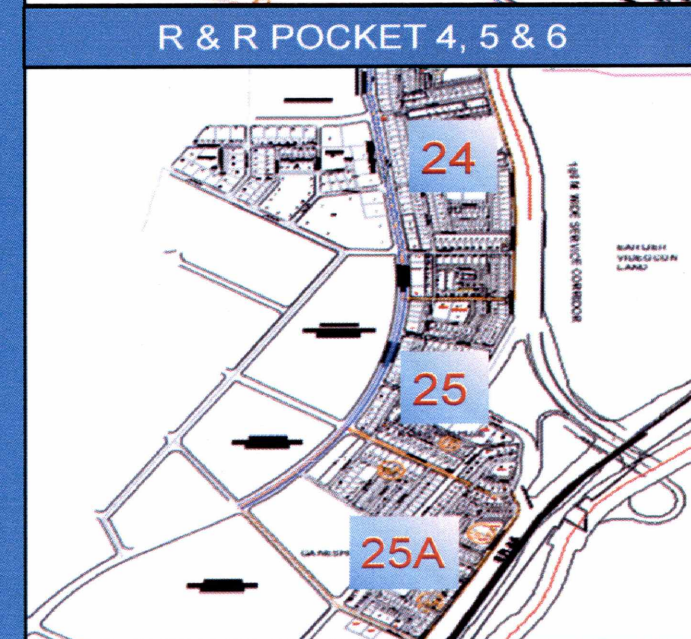
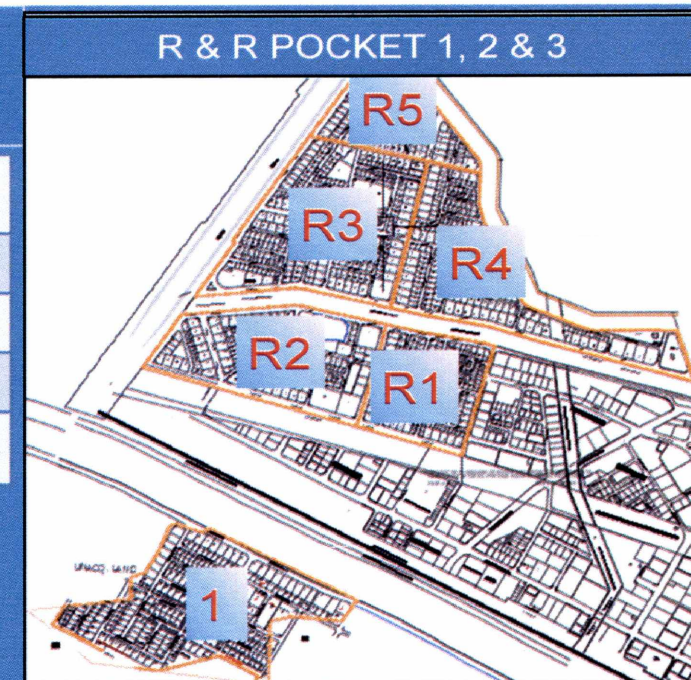
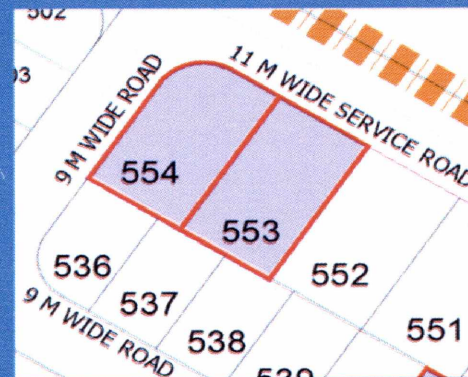
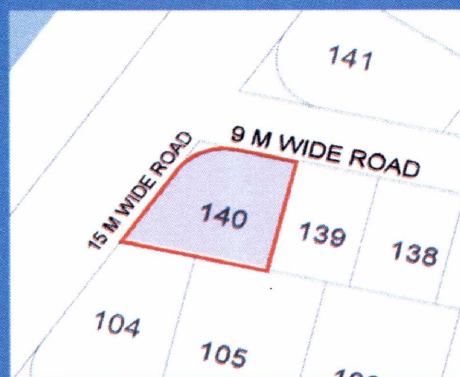
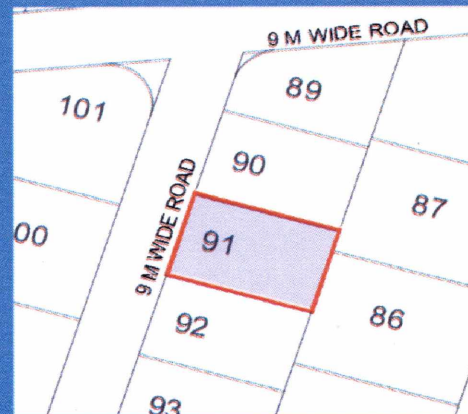
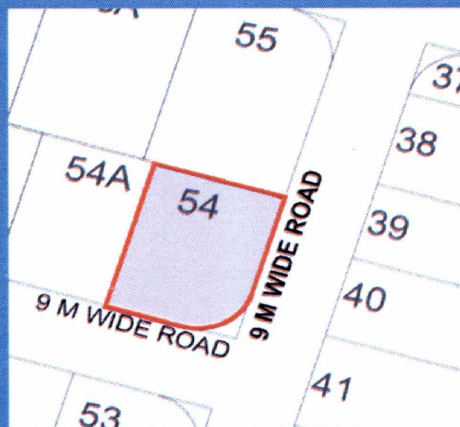

QMM
14/6/17

satil

N.B. Chaudhary
14/6/17

DRAW OF PLOT OF REHABILITATION AND RESETTLEMENT OF AIRPORT VILLAGES

BLOCK 25	Pocket no.	Sector	Plot no.
Plot Range (Sq m)	1, 2	R1	82, 222
		R3	84A
270	4, 5, 6	24	320

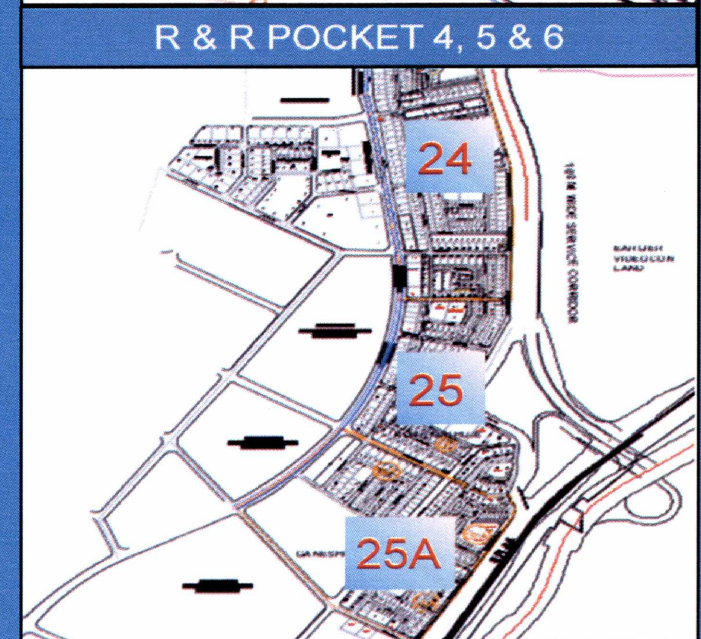
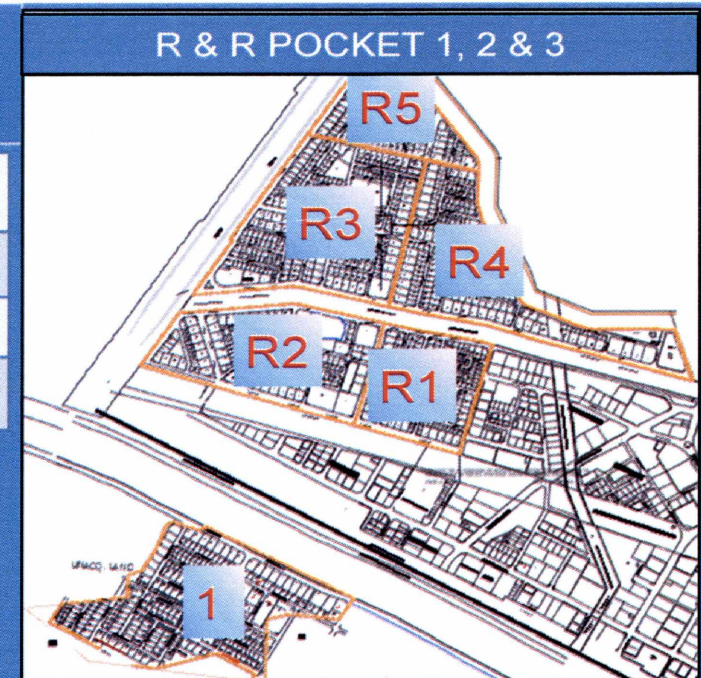
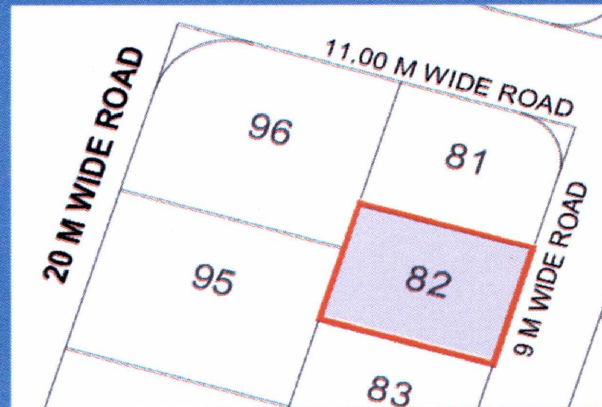
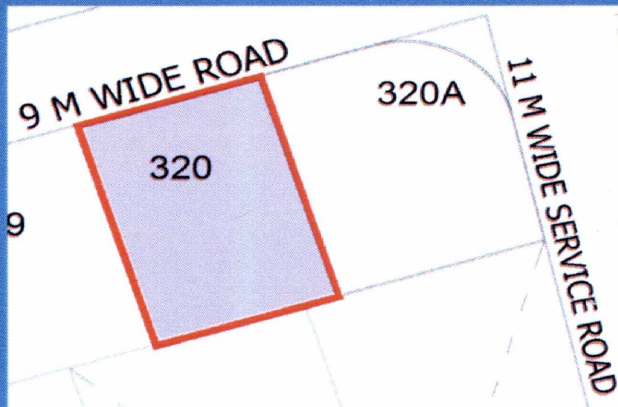
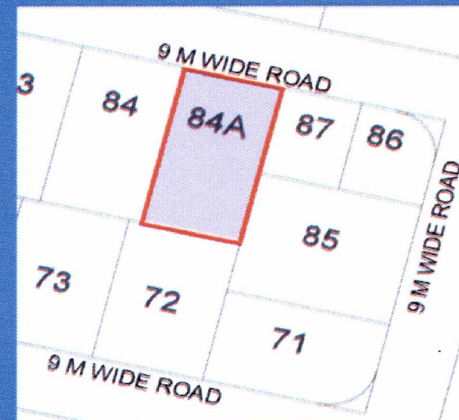
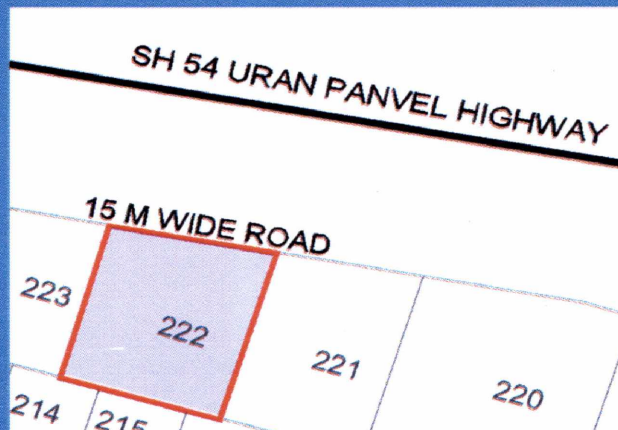

Qum
14/6/17

Satish

N.B. Chaudhari
14/6/17

DRAW OF PLOT OF REHABILITATION AND RESETTLEMENT OF AIRPORT VILLAGES

BLOCK 26	Pocket no.	Sector	Plot no.
Plot Range (Sq m)	1, 2	R4	208B
280	4, 5, 6	24	373, 551, 552, 546, 547, 548

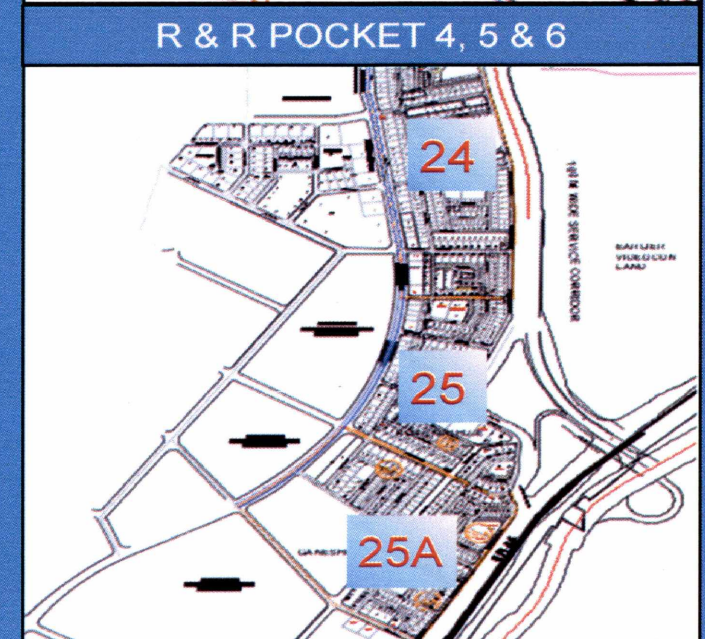
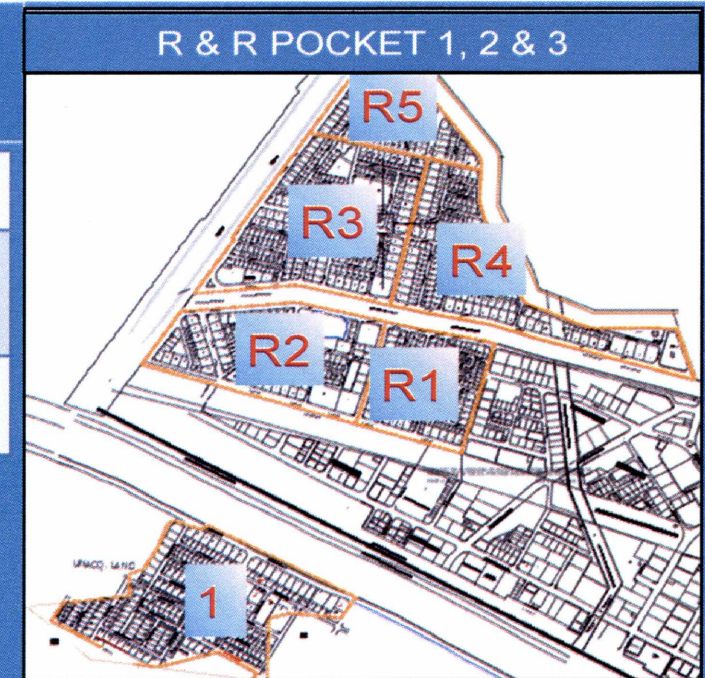
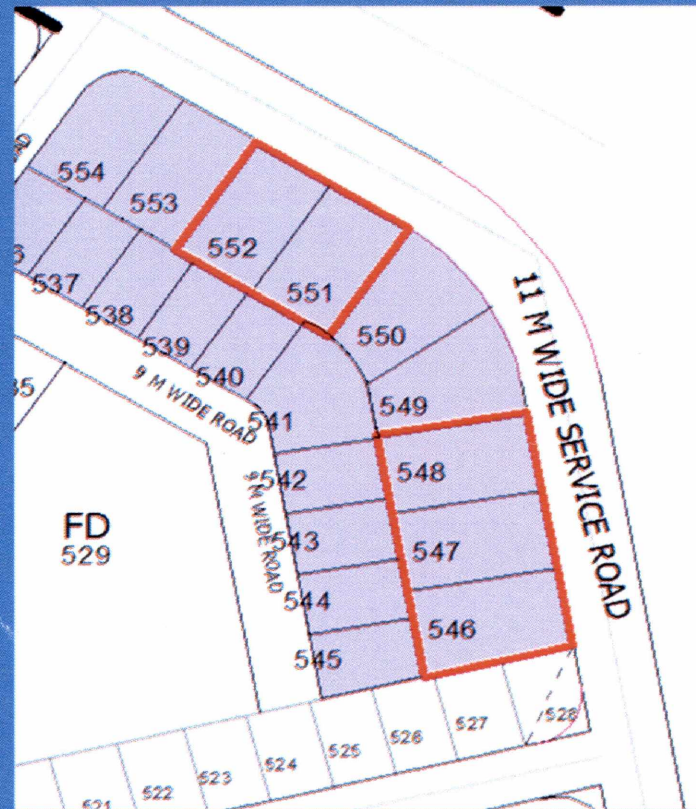
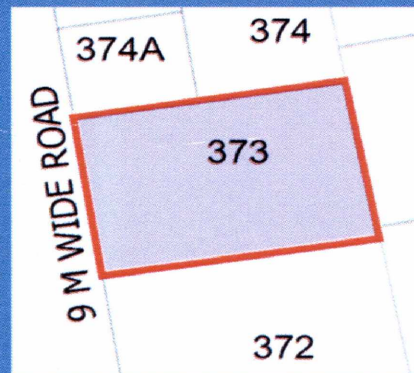
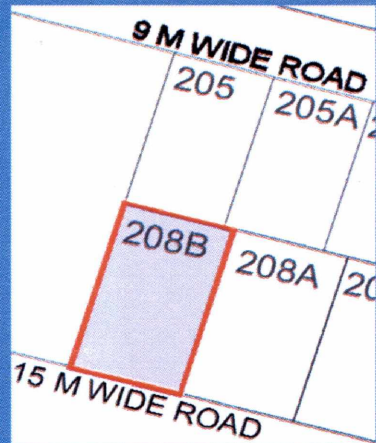

QMM
14/6/17

State

N.B. Chaudhary
14/6/17

DRAW OF PLOT OF REHABILITATION AND RESETTLEMENT OF AIRPORT VILLAGES

BLOCK 27	Pocket no.	Sector	Plot no.
Plot Range (Sq m)	1, 2	R4	208, 208A
290	4, 5, 6	24	549, 550
		25A	17C

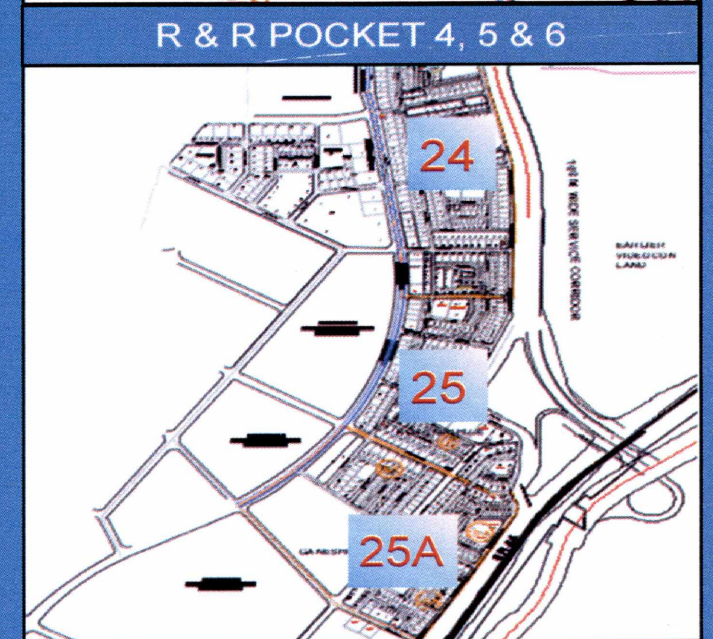
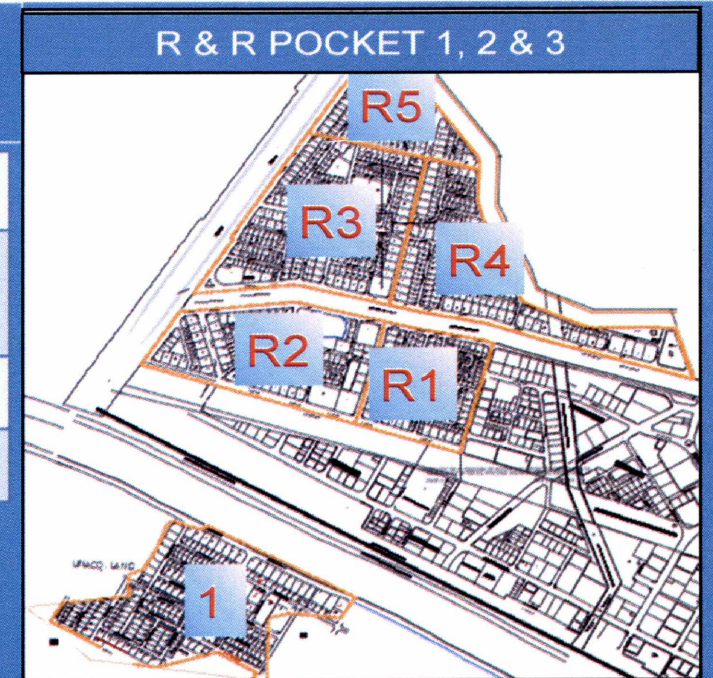
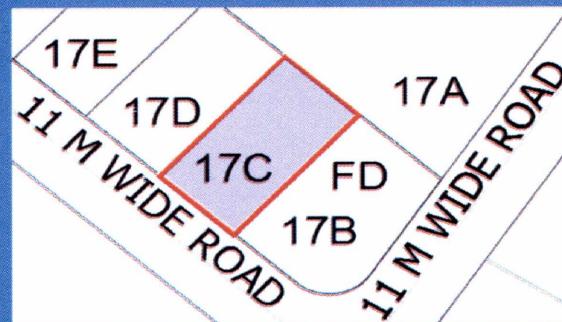
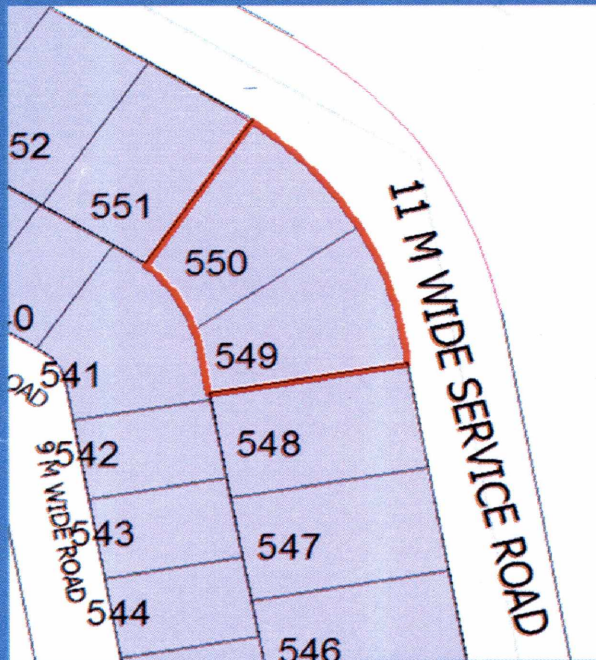

QMM
14/6/17

Satish

N.B. Chaudhary
14/6/17

DRAW OF PLOT OF REHABILITATION AND RESETTLEMENT OF AIRPORT VILLAGES

BLOCK 28	Pocket no.	Sector	Plot no.
Plot Range (Sq m)	4, 5, 6	24	320A
		25	287
300		25A	17D

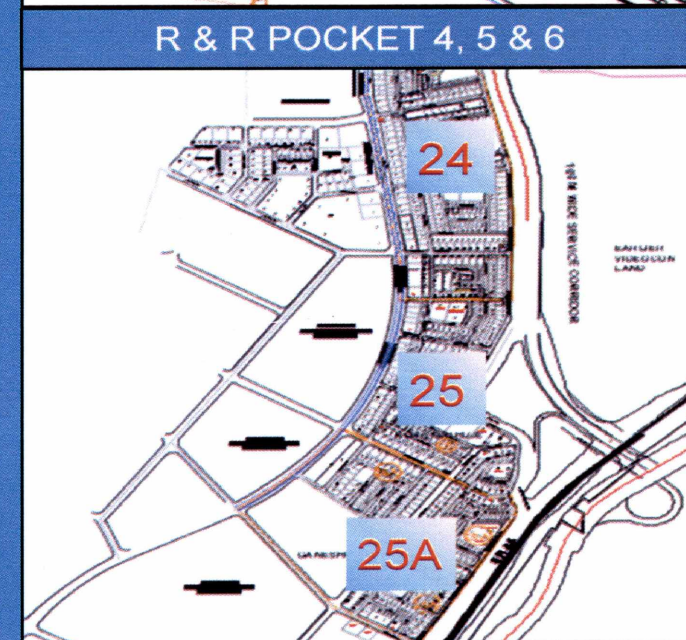
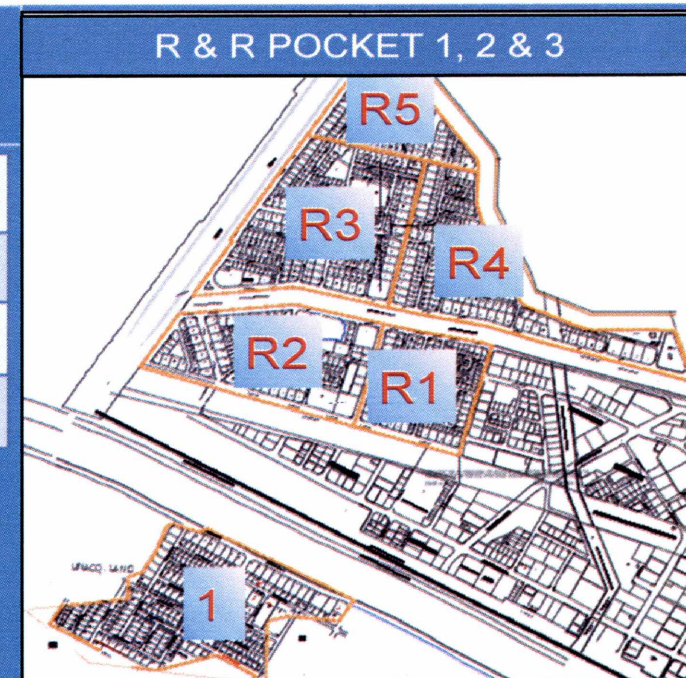
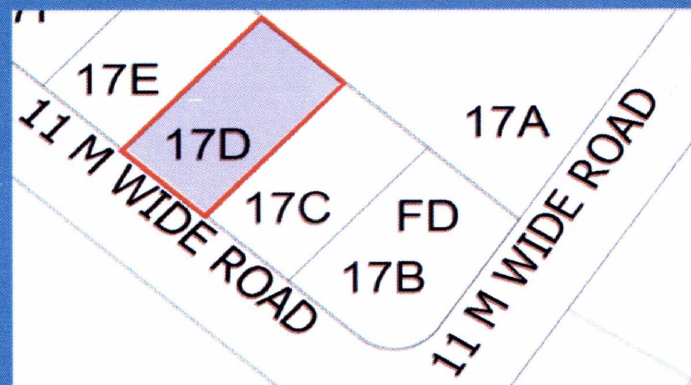

QMM
14/6/17

Salil

N.B. Chaudhary
14/06/17

DRAW OF PLOT OF REHABILITATION AND RESETTLEMENT OF AIRPORT VILLAGES

BLOCK 30	Pocket no.	Sector	Plot no.
Plot Range (Sq m)	1, 2	R1	54B
310	4, 5, 6	25A	19H

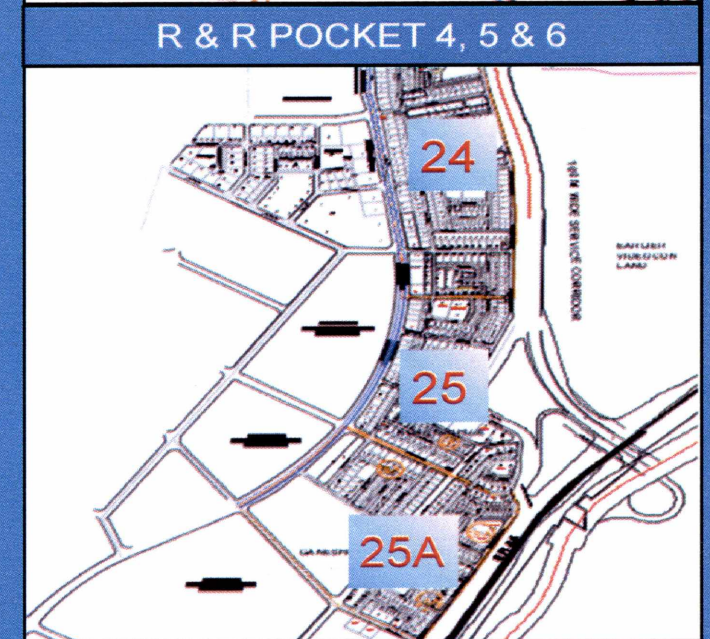
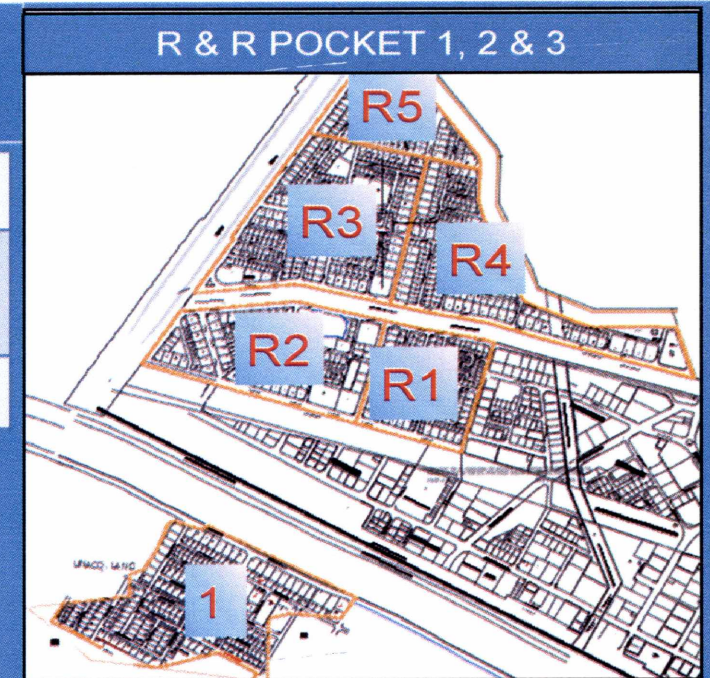
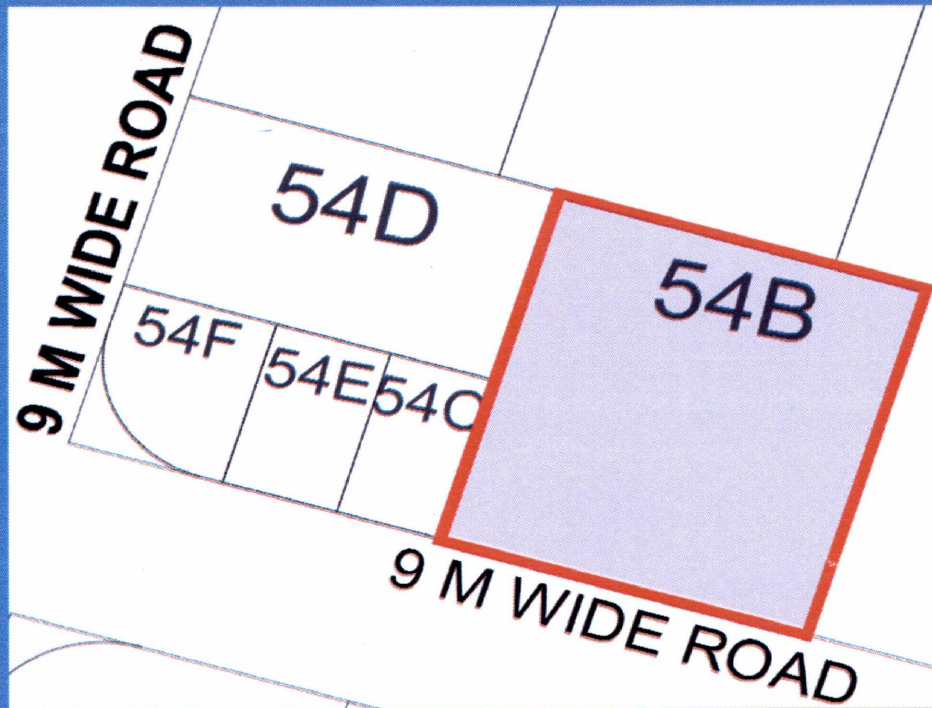

9mm
14/6/17
Satil

N.B. Chaudhary
14/06/17

DRAW OF PLOT OF REHABILITATION AND RESETTLEMENT OF AIRPORT VILLAGES

BLOCK 31	Pocket no.	Sector	Plot no.
Plot Range (Sq m)	4, 5, 6	24	304
330		25	287A



R & R POCKET 1, 2 & 3

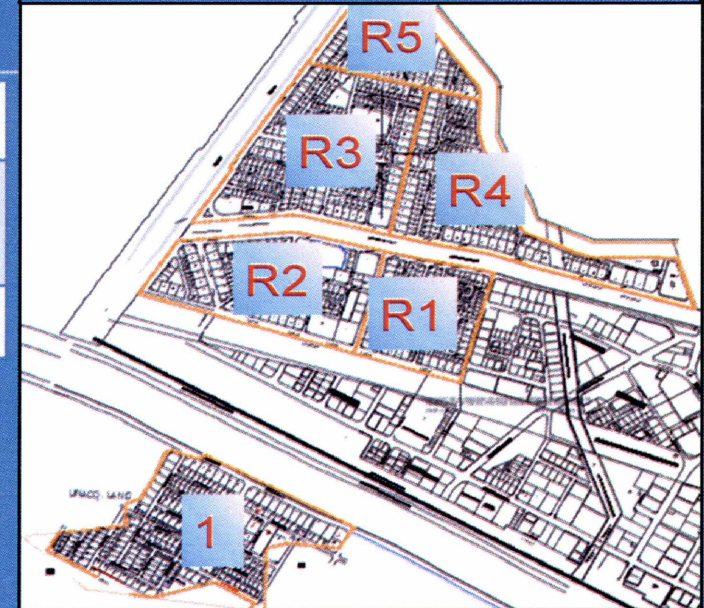

R & R POCKET 4, 5 & 6

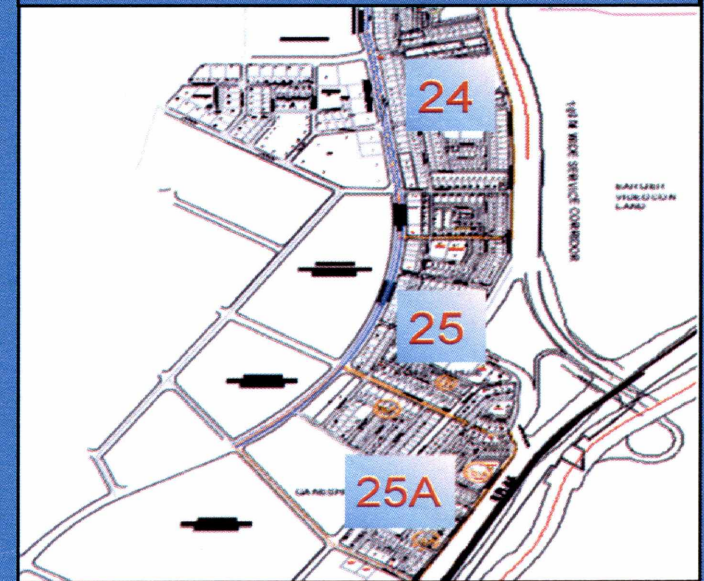

QMM
14/6/17

satil

N.B. Chaudhary
14/06/17

DRAW OF PLOT OF REHABILITATION AND RESETTLEMENT OF AIRPORT VILLAGES

BLOCK 32	Pocket no.	Sector	Plot no.
Plot Range (Sq m)	1, 2	R4	100
320 & 340	4, 5, 6	24	43B

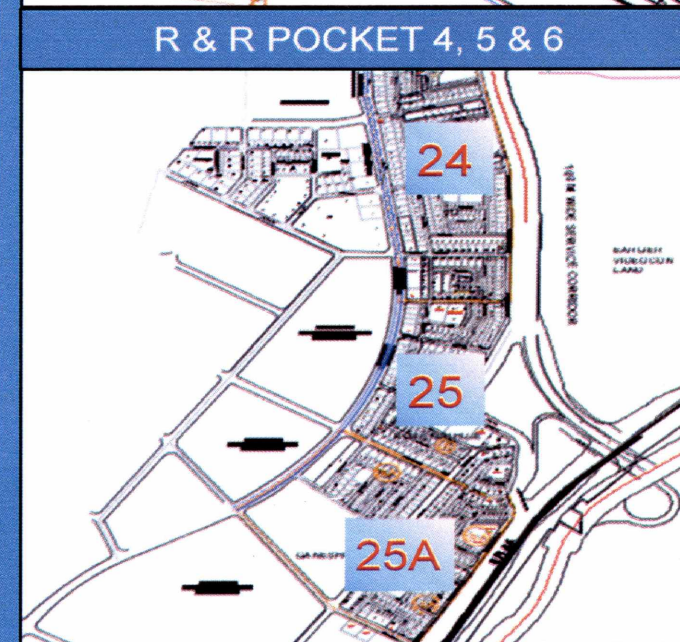
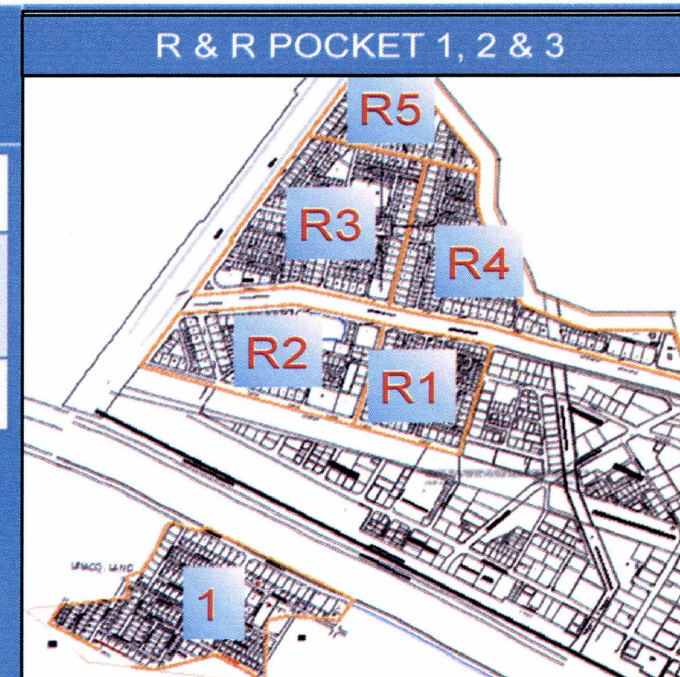
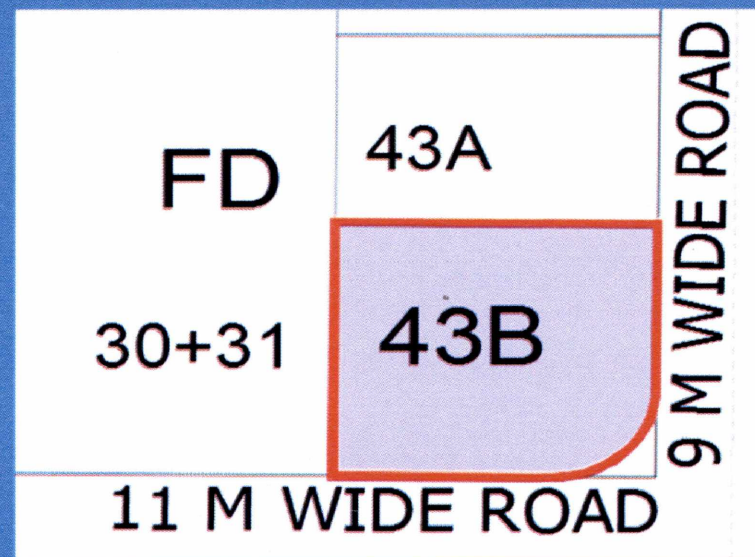
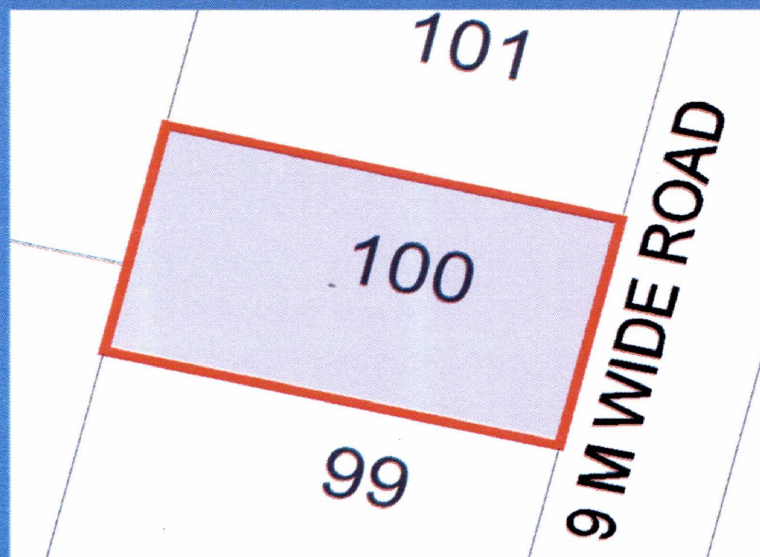

Qmm
14/6/17

Salil

N.B. Chaudhan
14/6/17

DRAW OF PLOT OF REHABILITATION AND RESETTLEMENT OF AIRPORT VILLAGES

BLOCK 33	Pocket no.	Sector	Plot no.
Plot Range (Sq m)	1, 2	R3	96D
	1, 2	R5	43A
370	4, 5, 6	25A	17E

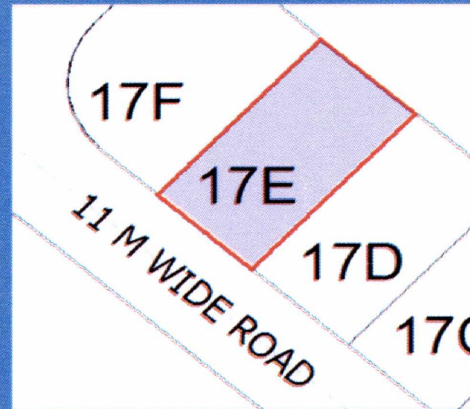
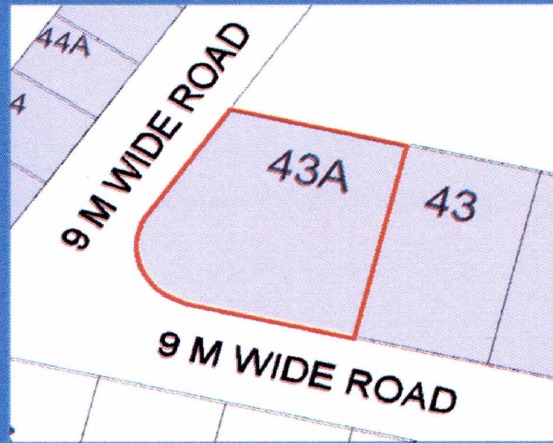
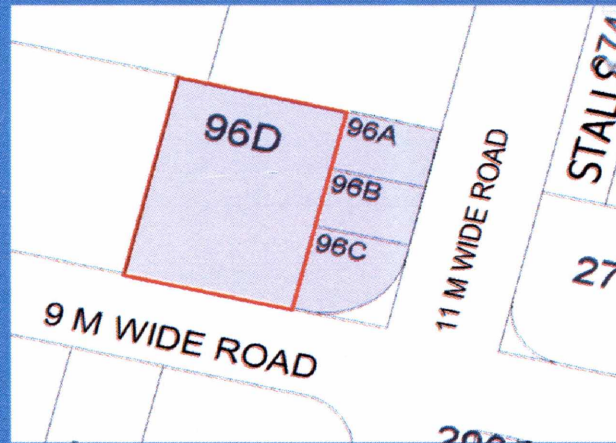

R & R POCKET 1, 2 & 3

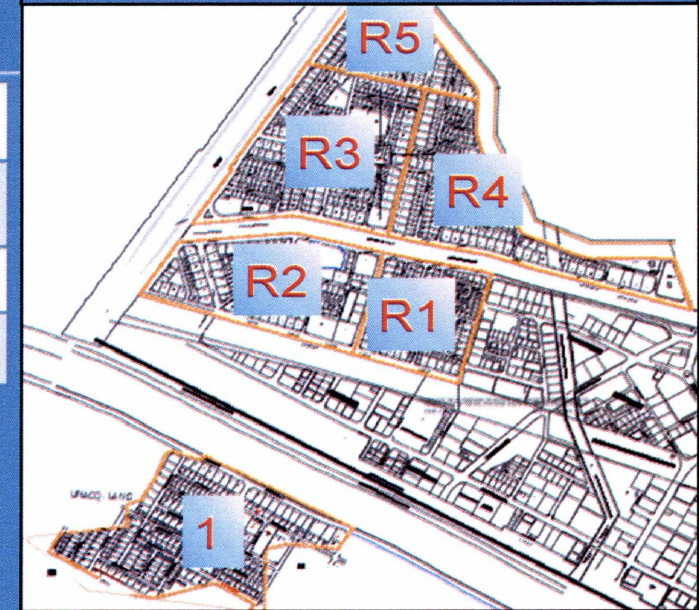

R & R POCKET 4, 5 & 6

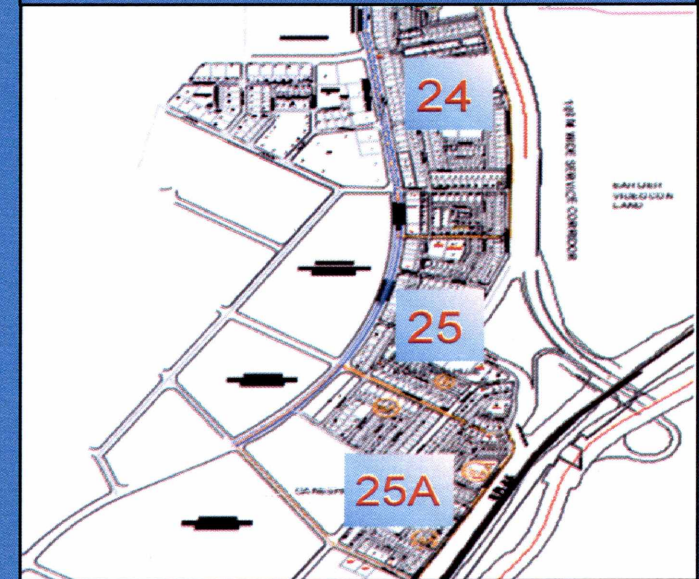

9mm
14/6/17

Satish

N.B. Chaudhary
14/06/17

DRAW OF PLOT OF REHABILITATION AND RESETTLEMENT OF AIRPORT VILLAGES

BLOCK 34	Pocket no.	Sector	Plot no.
Plot Range (Sq m)	1, 2	R3	14, 202A
380			



R & R POCKET 1, 2 & 3

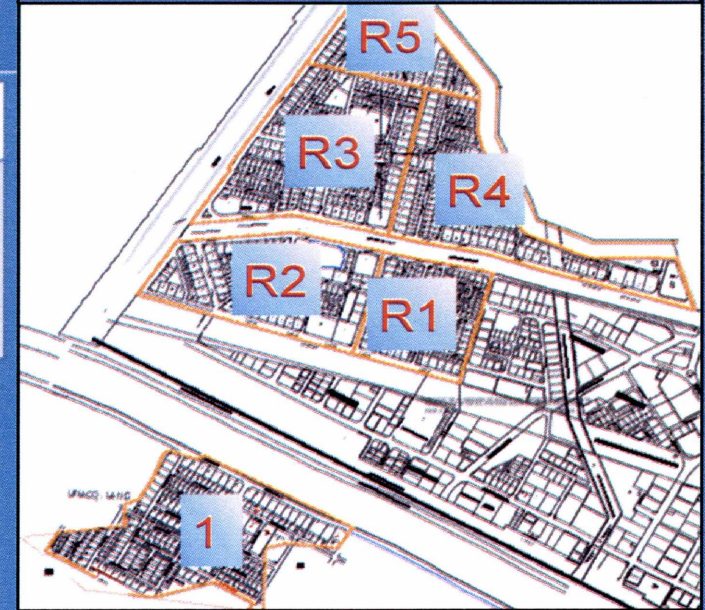

R & R POCKET 4, 5 & 6

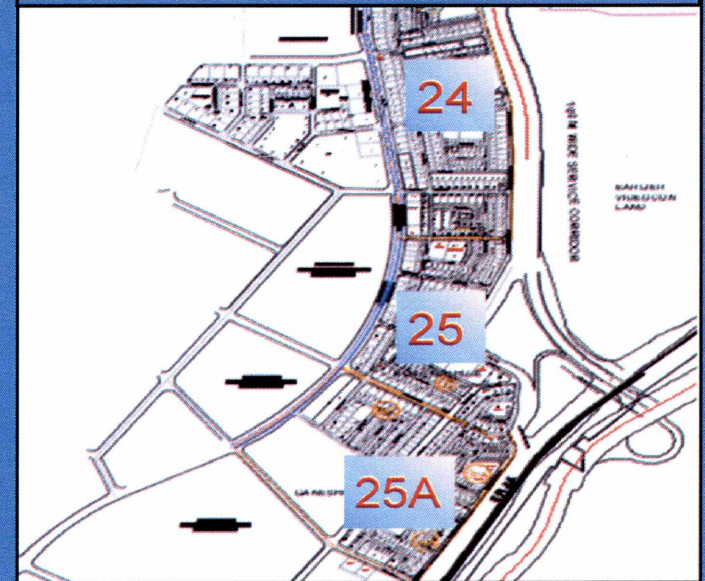

9/11/17
14/6/17

Satish

N.B. Chaudhary
14/6/17

DRAW OF PLOT OF REHABILITATION AND RESETTLEMENT OF AIRPORT VILLAGES

BLOCK 35	Pocket no.	Sector	Plot no.
Plot Range (Sq m)	1, 2	R3	38 + 39
390, 400	4, 5, 6	24	303

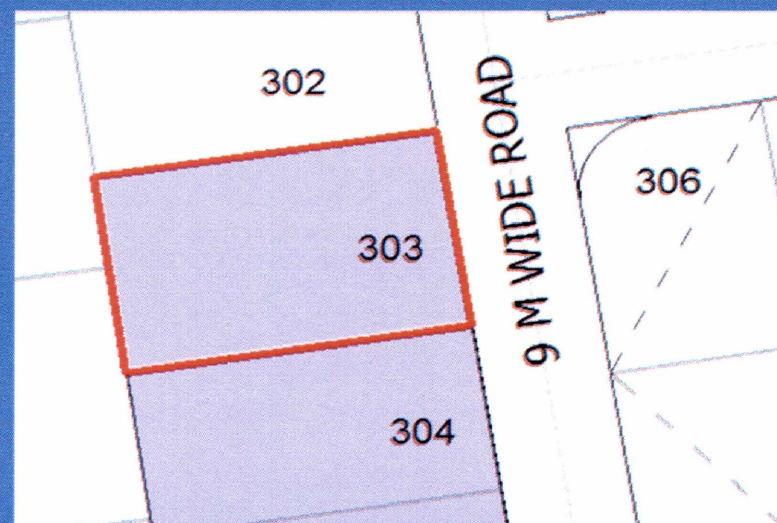
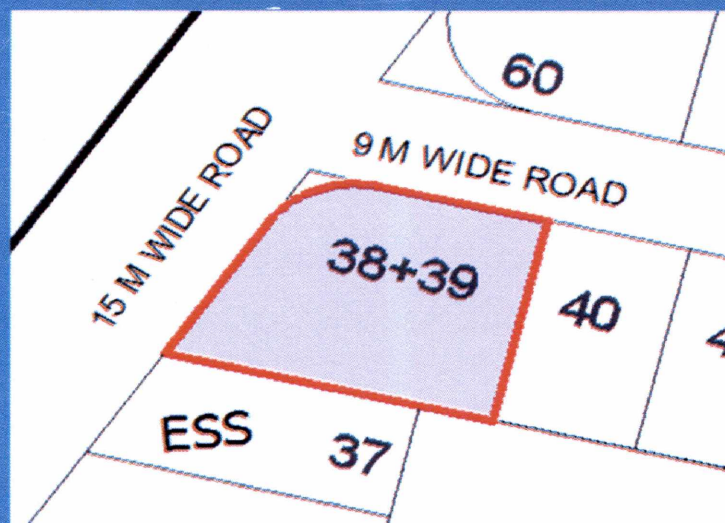

R & R POCKET 1, 2 & 3

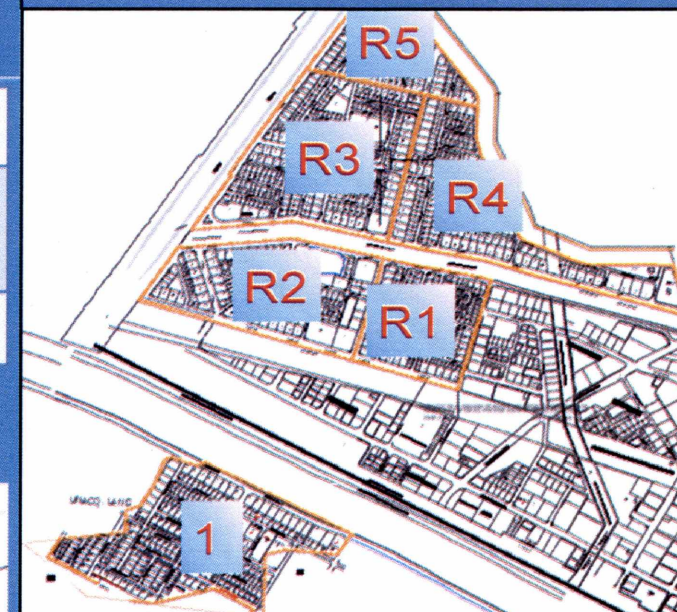

R & R POCKET 4, 5 & 6

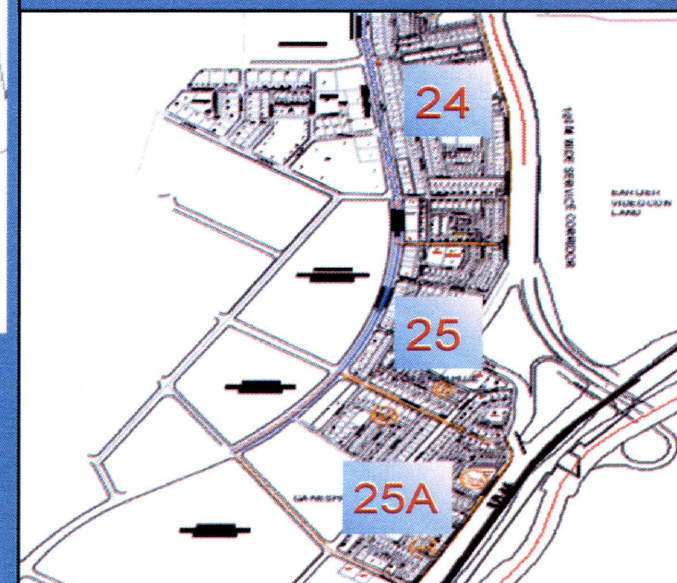

QMM
14/6/17

Signature

N.B. Chaudhary
14/6/17

DRAW OF PLOT OF REHABILITATION AND RESETTLEMENT OF AIRPORT VILLAGES

BLOCK 36	Pocket no.	Sector	Plot no.
Plot Range (Sq m)	4, 5, 6	24	148
420		25A	17F

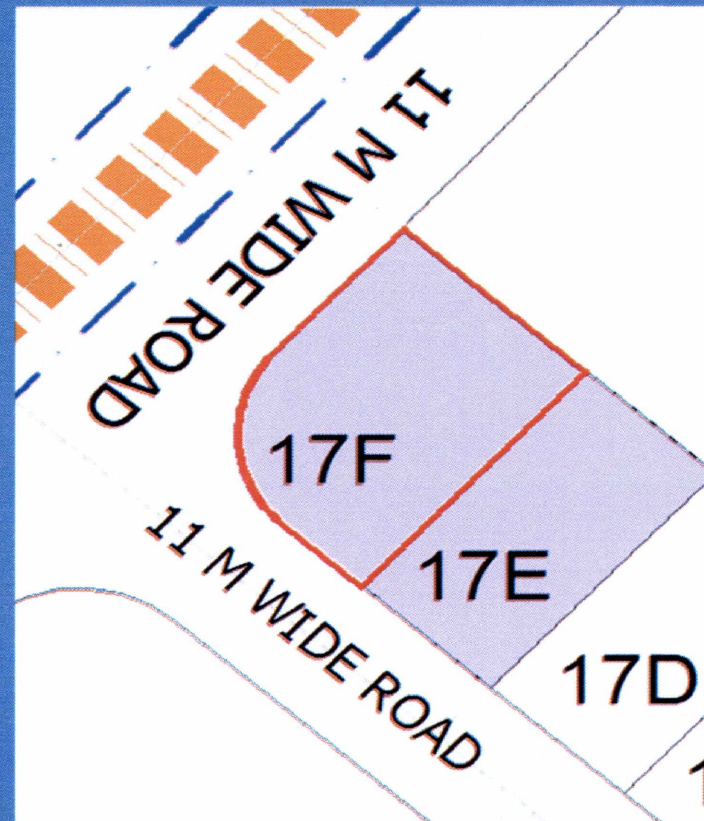
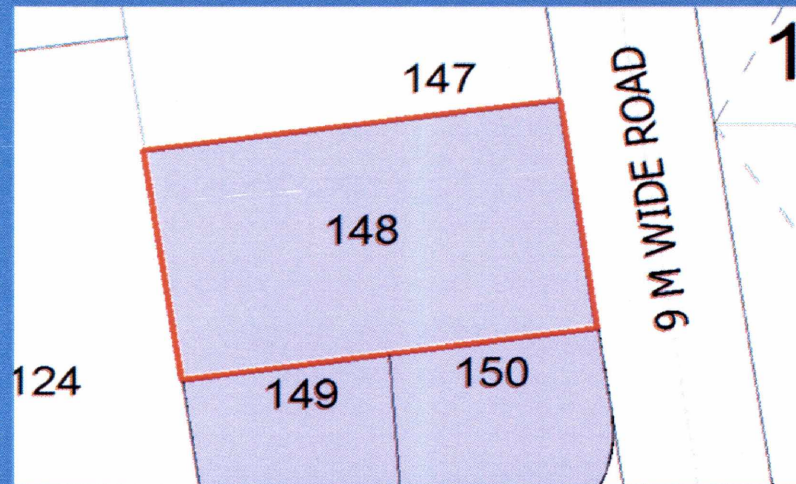

R & R POCKET 1, 2 & 3

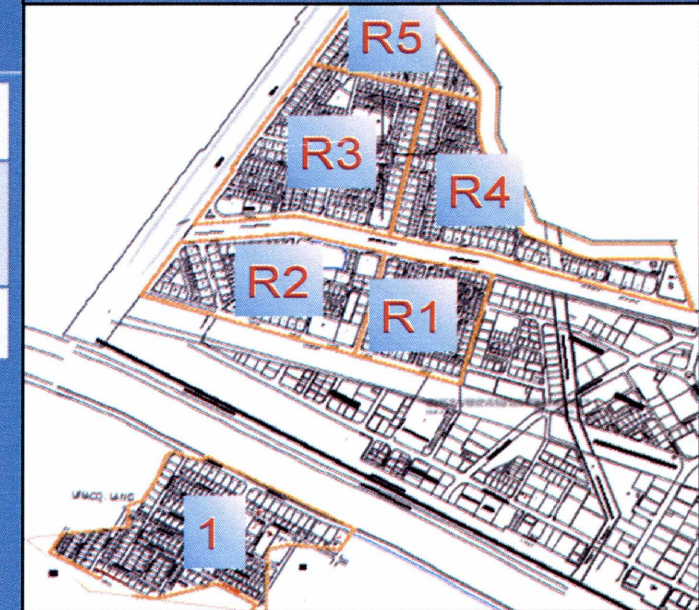

R & R POCKET 4, 5 & 6

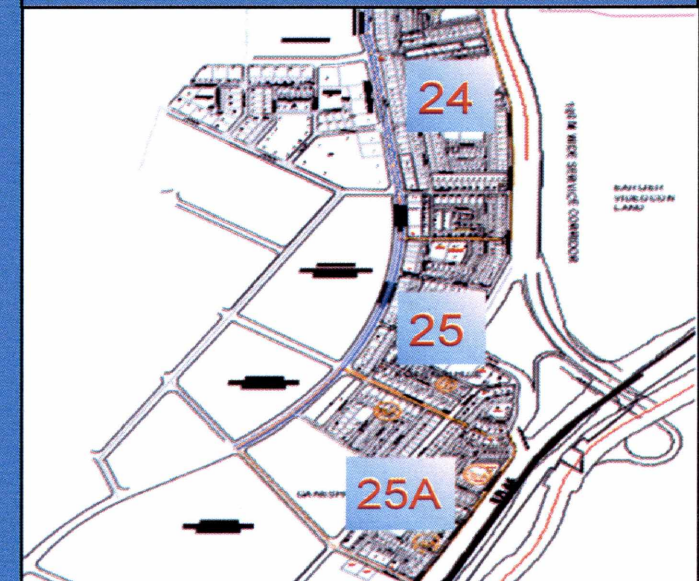

QWUN
14/6/17

slatil

N.B. Chaudhary
14/6/17

DRAW OF PLOT OF REHABILITATION AND RESETTLEMENT OF AIRPORT VILLAGES

BLOCK 37	Pocket no.	Sector	Plot no.
Plot Range (Sq m)	1, 2	R4	84B
430, 440	4, 5, 6	24	7, 8

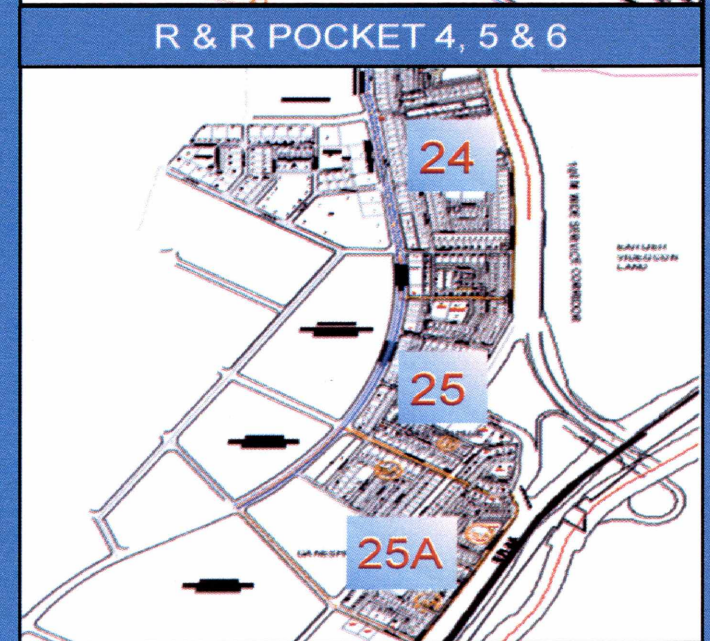
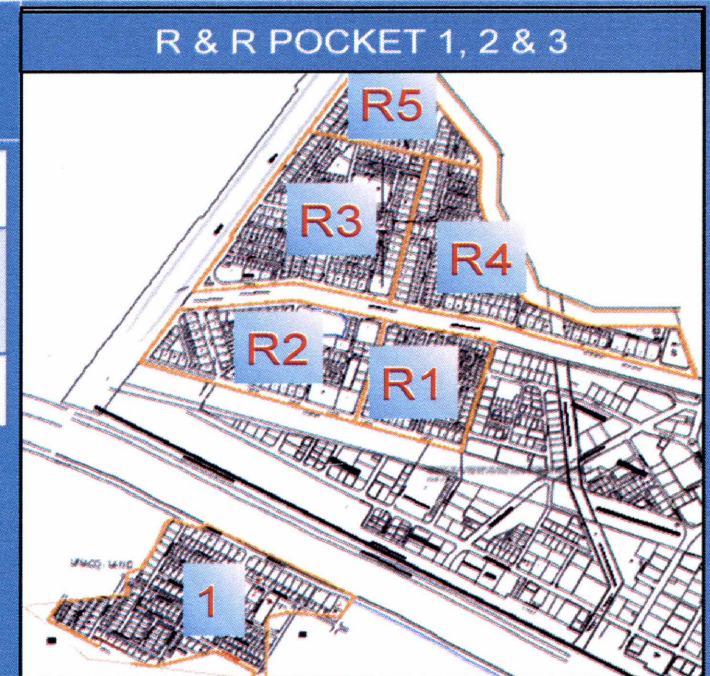
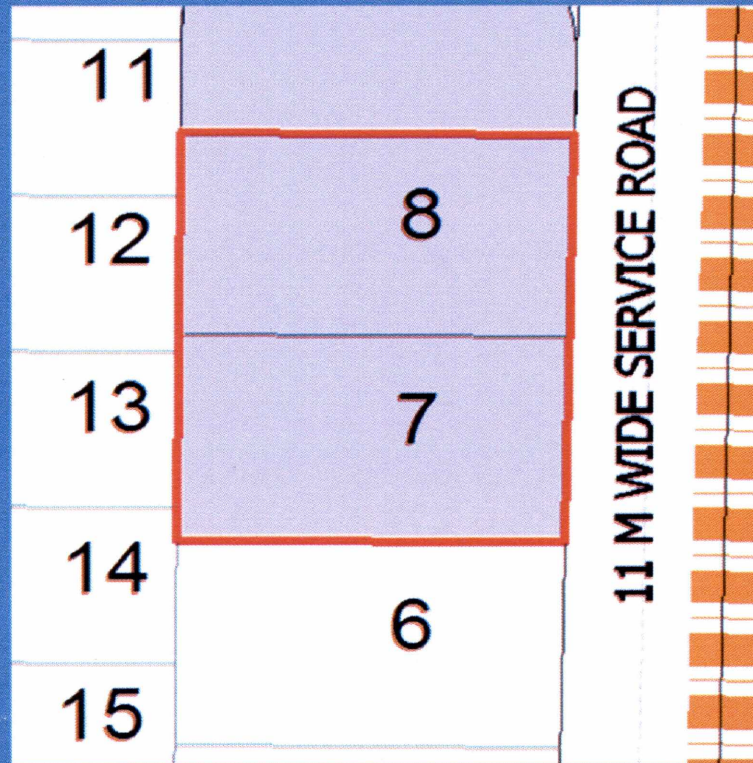
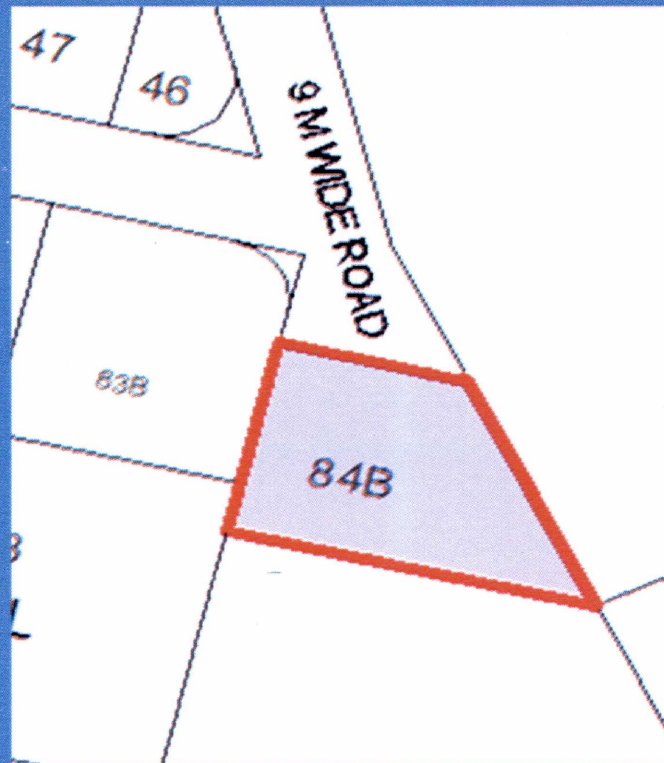

Q. M. L.
14/6/17

Satish

N.B. Chaudhary
14/6/17

DRAW OF PLOT OF REHABILITATION AND RESETTLEMENT OF AIRPORT VILLAGES

BLOCK 38	Pocket no.	Sector	Plot no.
Plot Range (Sq m)	3	1	296
450	4, 5, 6	24	9

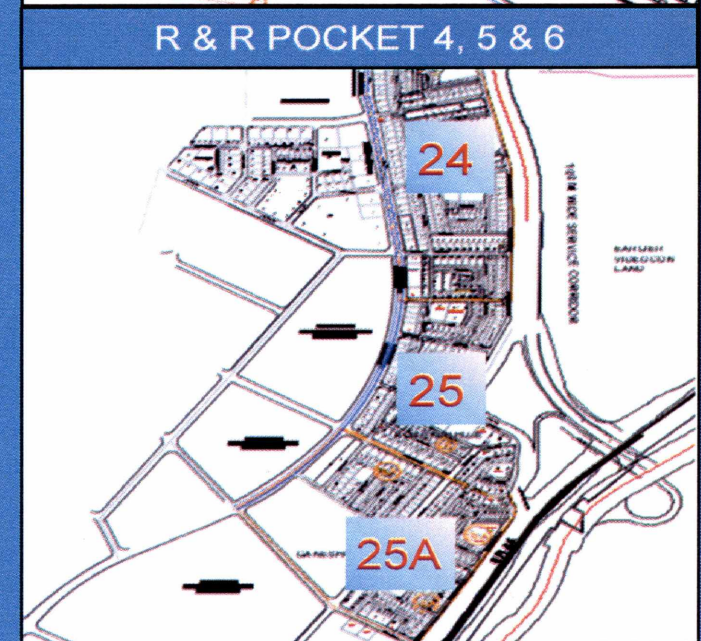
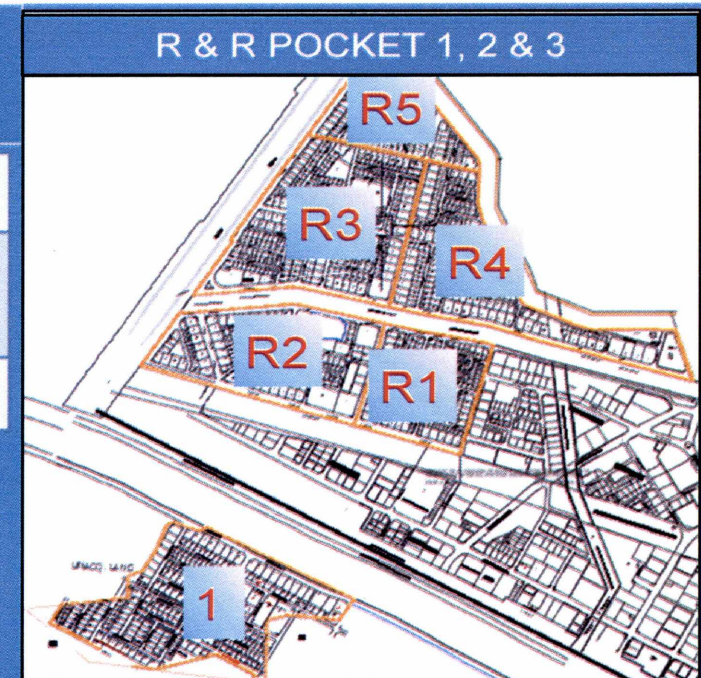

Qum
14/6/17

Satish

N.B. Chaudhary
14/6/17

DRAW OF PLOT OF REHABILITATION AND RESETTLEMENT OF AIRPORT VILLAGES

BLOCK 39	Pocket no.	Sector	Plot no.
Plot Range (Sq m)	4, 5, 6	24	305
470	4, 5, 6	25A	19G

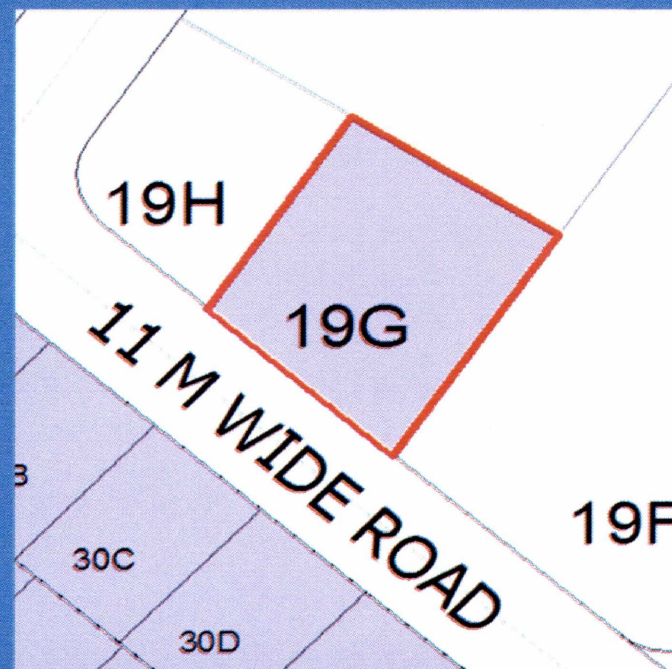

R & R POCKET 1, 2 & 3

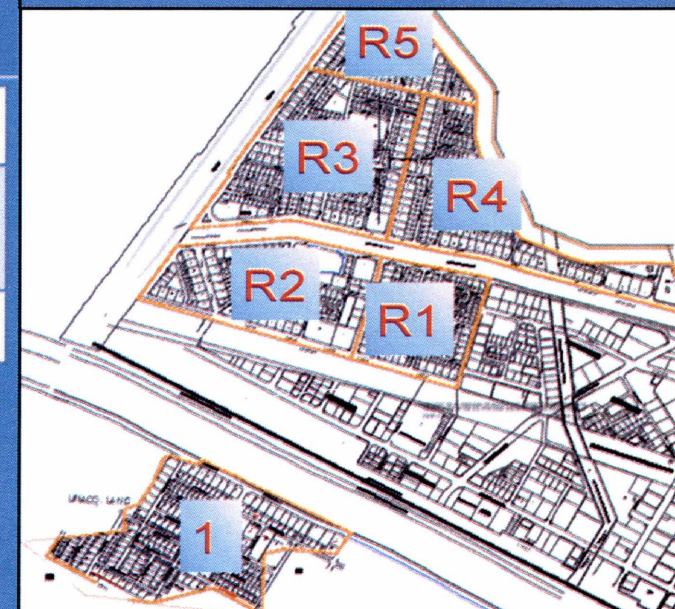

R & R POCKET 4, 5 & 6

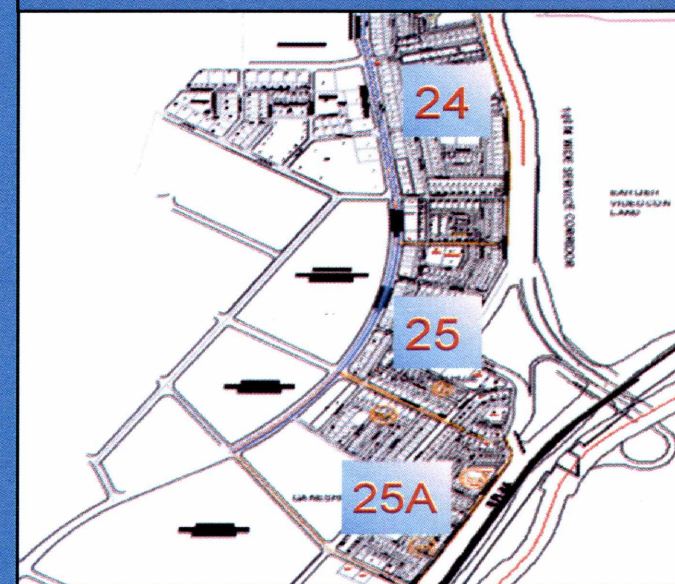

Qmm
14/6/17

Satish

N.B. Chaudhary
14/6/17

DRAW OF PLOT OF REHABILITATION AND RESETTLEMENT OF AIRPORT VILLAGES

BLOCK 40	Pocket no.	Sector	Plot no.
Plot Range (Sq m)	1, 2	R2	156
520, 540	3	1	61

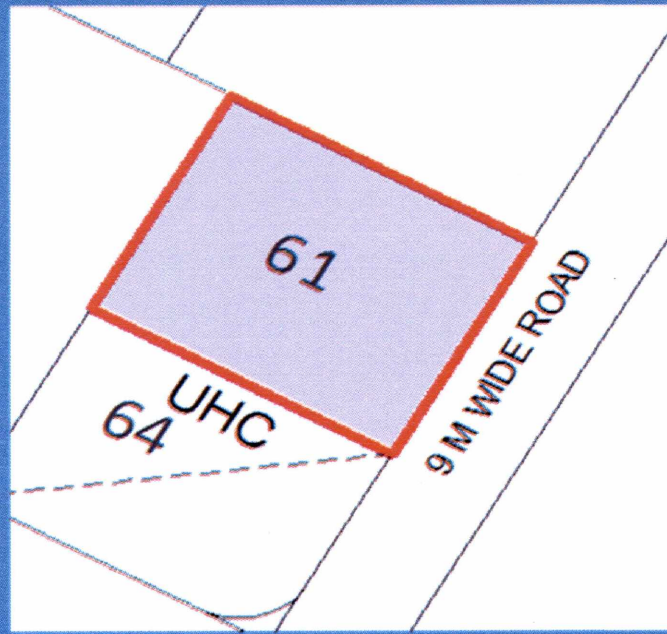
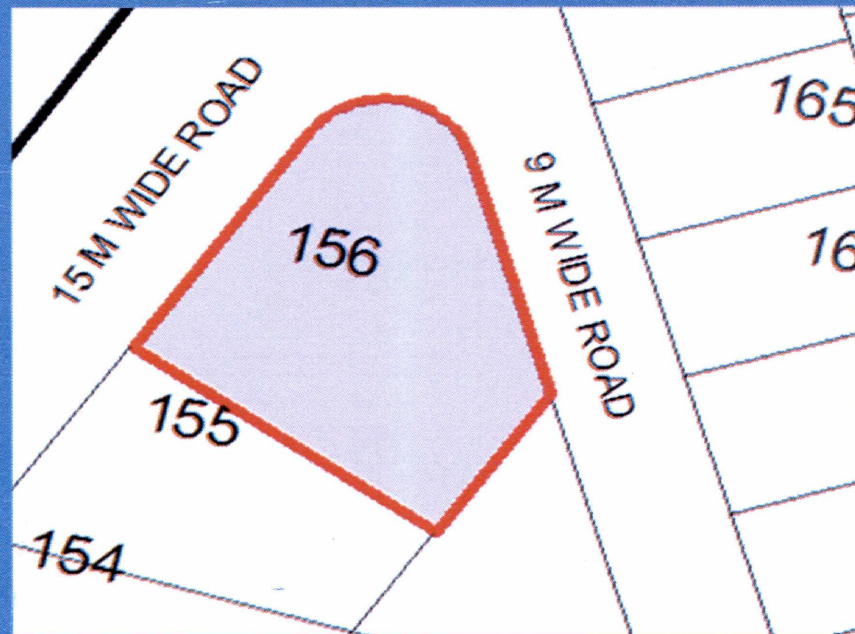

R & R POCKET 1, 2 & 3

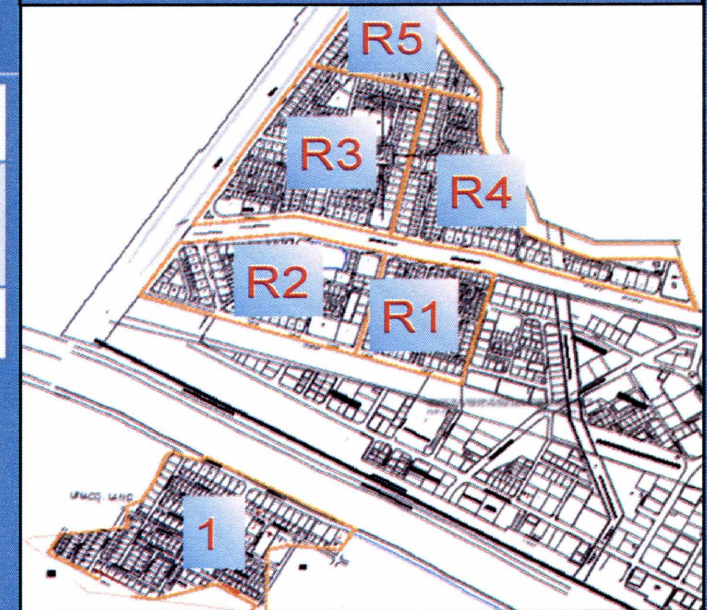

R & R POCKET 4, 5 & 6

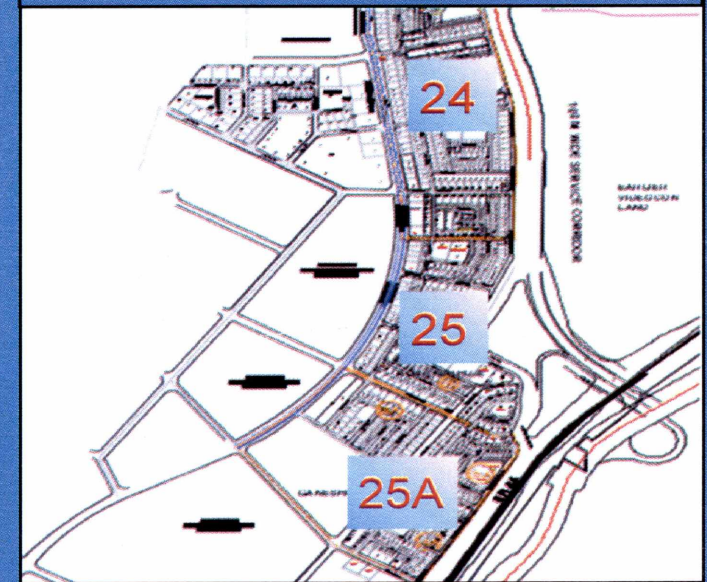

9mm
14/6/17

Salil

N.B. Chaudhary
14/6/17

DRAW OF PLOT OF REHABILITATION AND RESETTLEMENT OF AIRPORT VILLAGES

BLOCK 41	Pocket no.	Sector	Plot no.
Plot Range (Sq m)	1, 2	R4	219
580	4, 5, 6	25	177

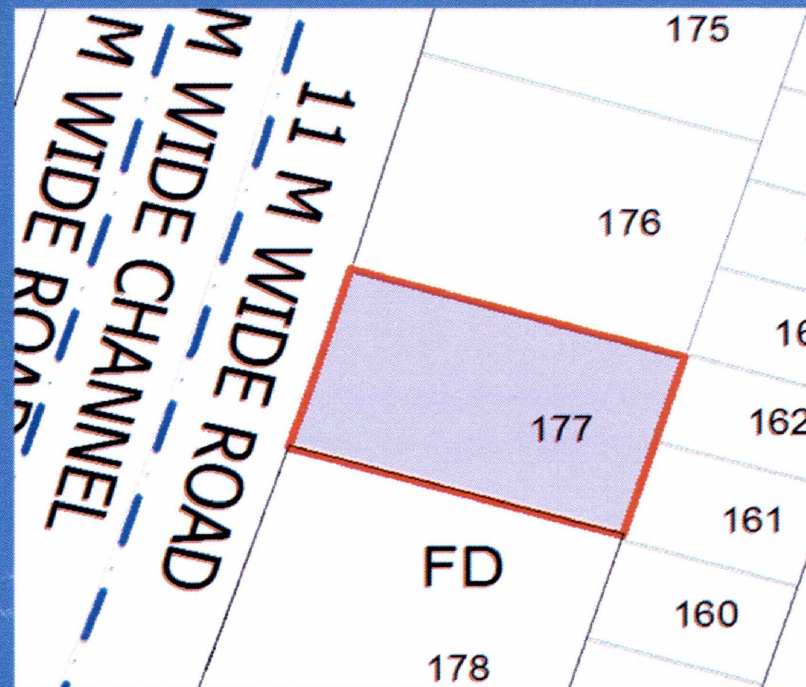

R & R POCKET 1, 2 & 3

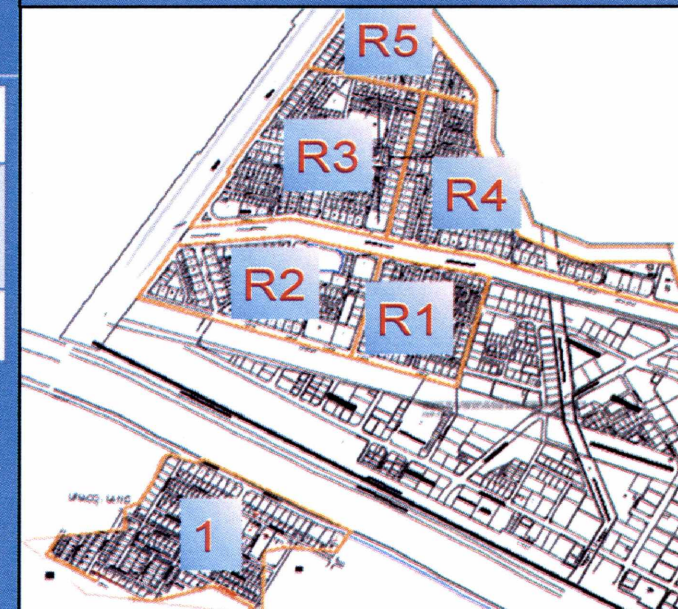

R & R POCKET 4, 5 & 6



QMM
14/6/17

Satish

N.B. Chaudhary
14/6/17

DRAW OF PLOT OF REHABILITATION AND RESETTLEMENT OF AIRPORT VILLAGES

BLOCK 42	Pocket no.	Sector	Plot no.
Plot Range (Sq m)	4, 5, 6	24	34
1230	4, 5, 6	25	244

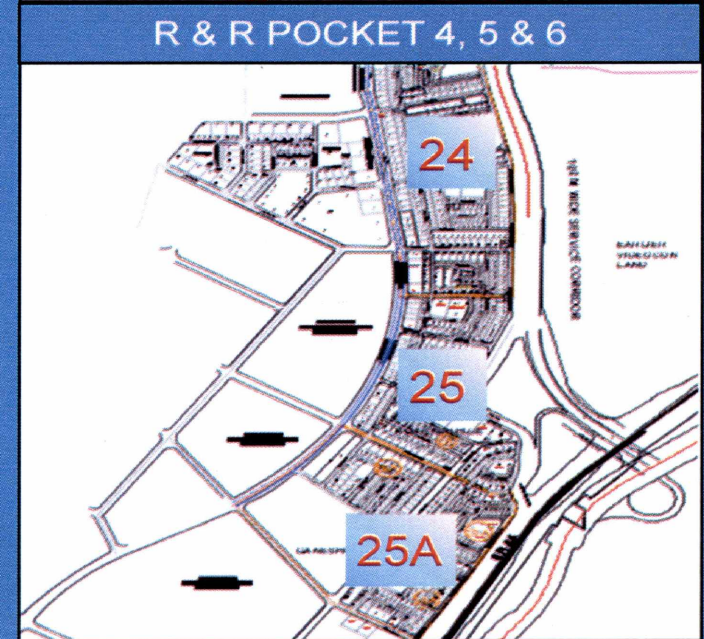
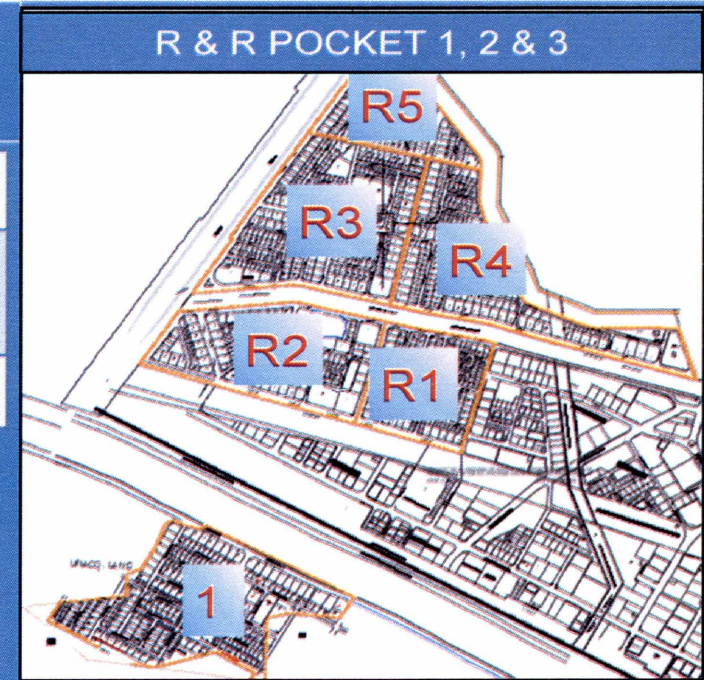
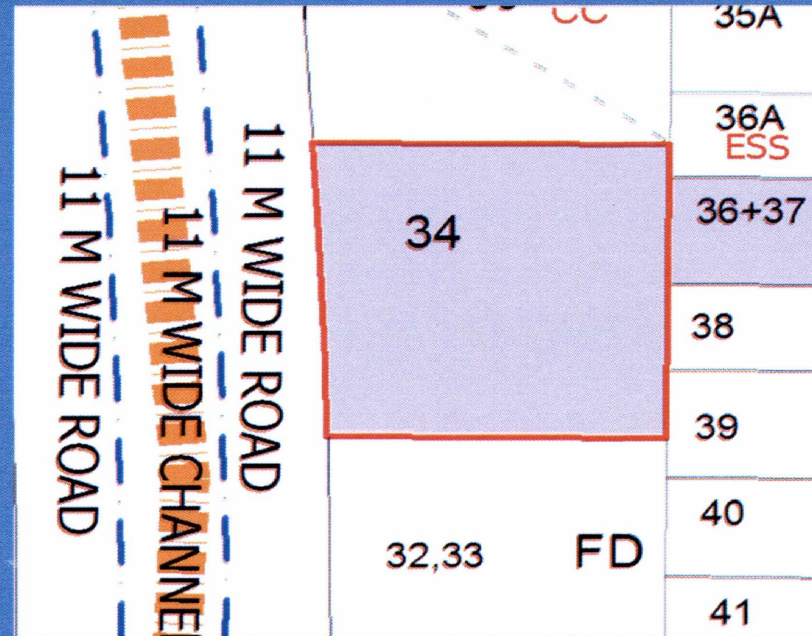
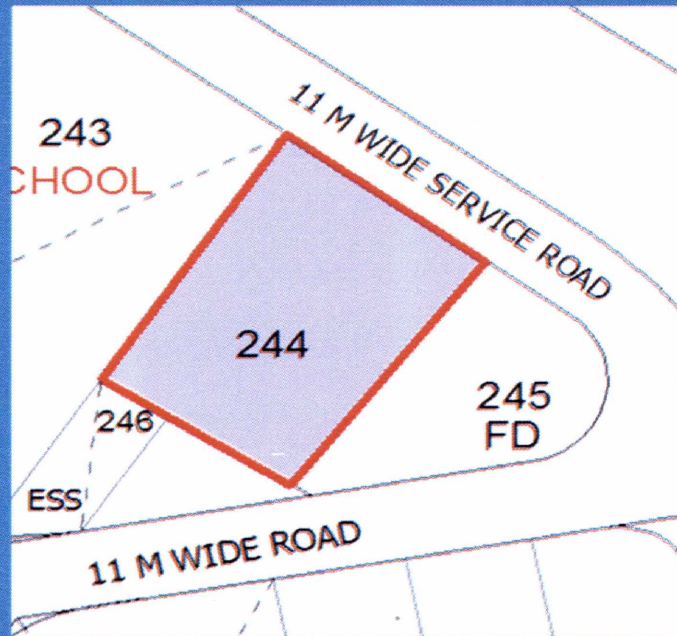

Qm
14/6/17

Satish

N.B. Chaudhary
14/6/17

DRAW OF PLOT OF REHABILITATION AND RESETTLEMENT OF AIRPORT VILLAGES

BLOCK 43	Pocket no.	Sector	Plot no.
Plot Range (Sq m)	4, 5, 6	25A	19M, 390A
1480			

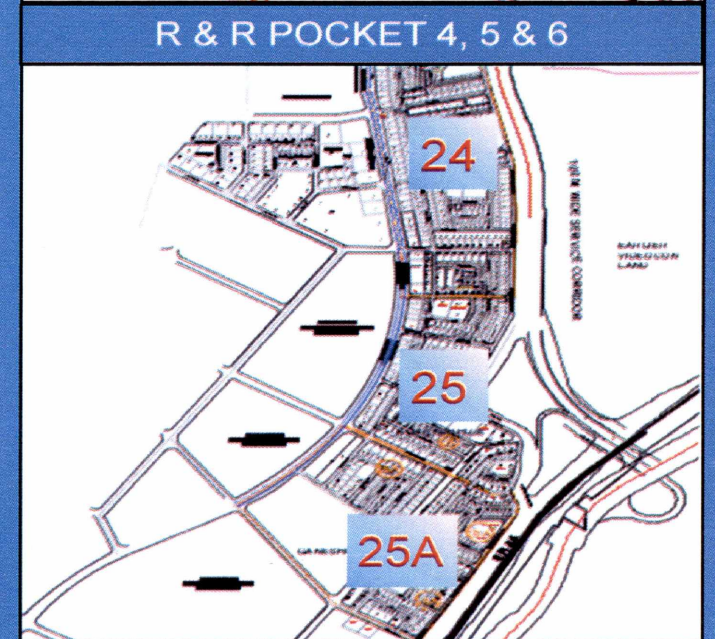
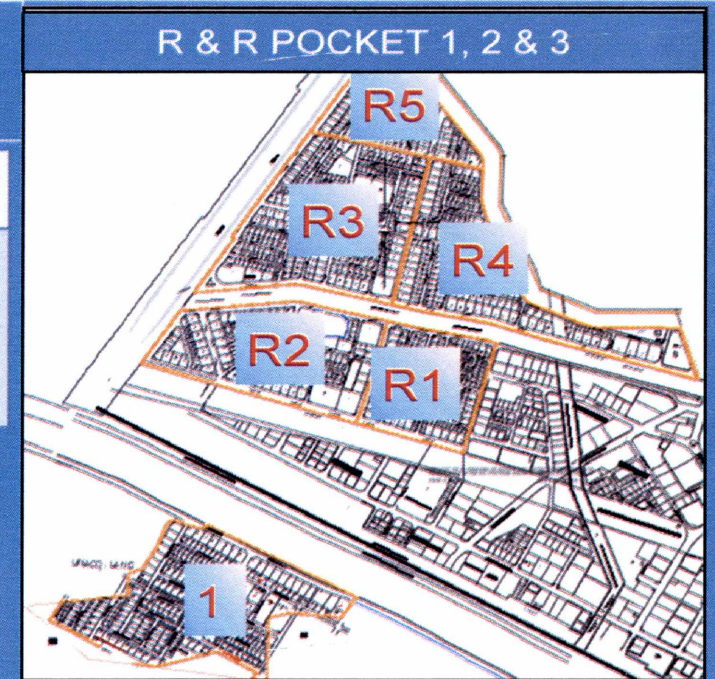
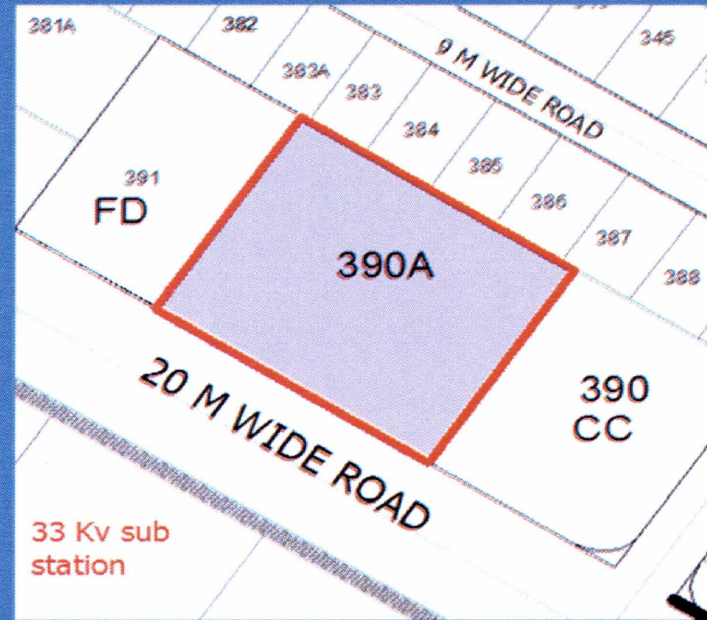
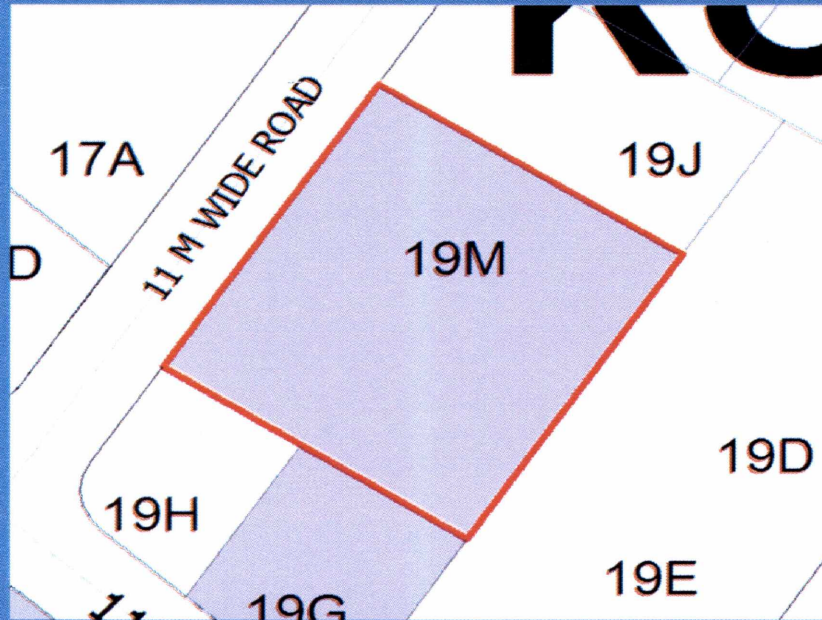

Qum
14/6/17

Satil

N.B. Chaudhary
14/6/17

DRAW OF PLOT OF REHABILITATION AND RESETTLEMENT OF AIRPORT VILLAGES

BLOCK 44	Pocket no.	Sector	Plot no.
Plot Range (Sq m)	4,5,6	24	541, 36+37
250	1,2	R2	24
	3	1	29A

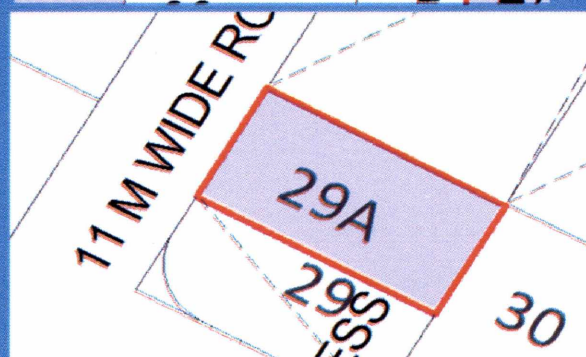
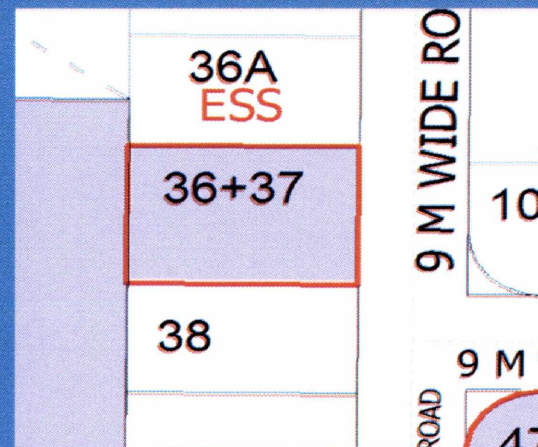
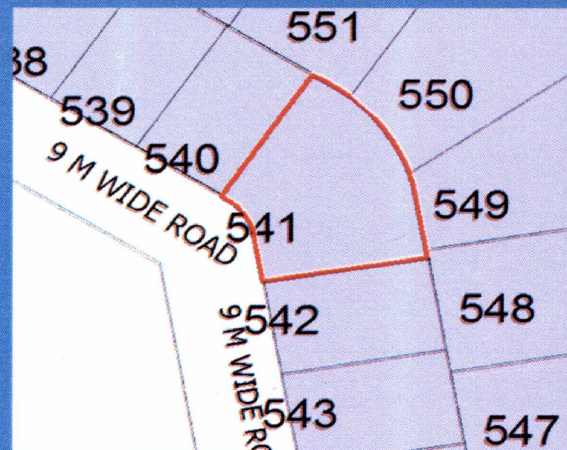

R & R POCKET 1, 2 & 3

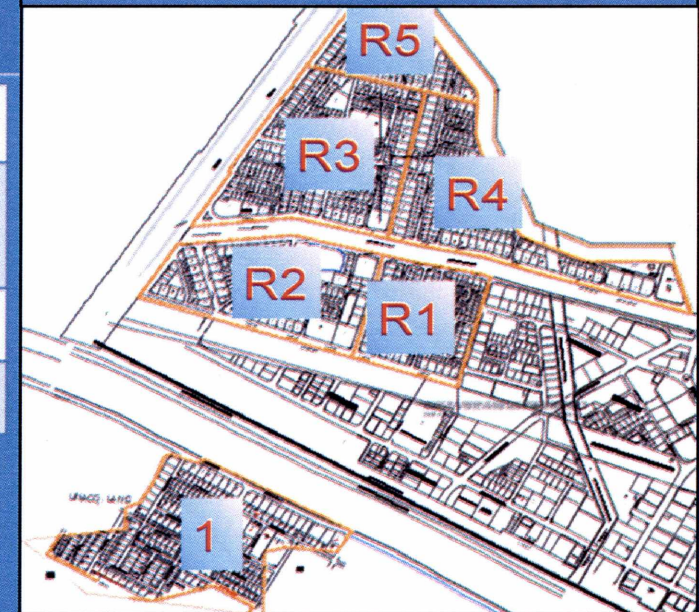

R & R POCKET 4, 5 & 6

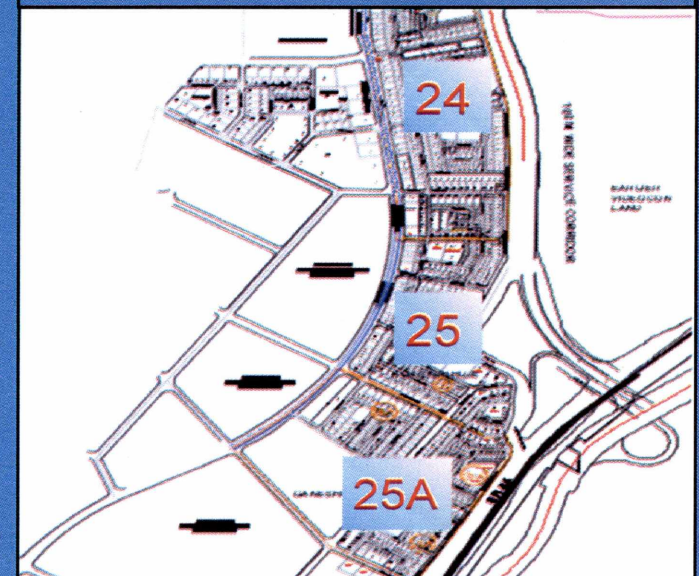

QMM
14/6/17

Satish

N.B. Chaudhary
14/6/17