

# DRAW OF PLOTS FOR REHABILITATION & RESETTLEMENT OF AIRPORT VILLAGES BALANCE R&R AND COURT CASE RELOCATION

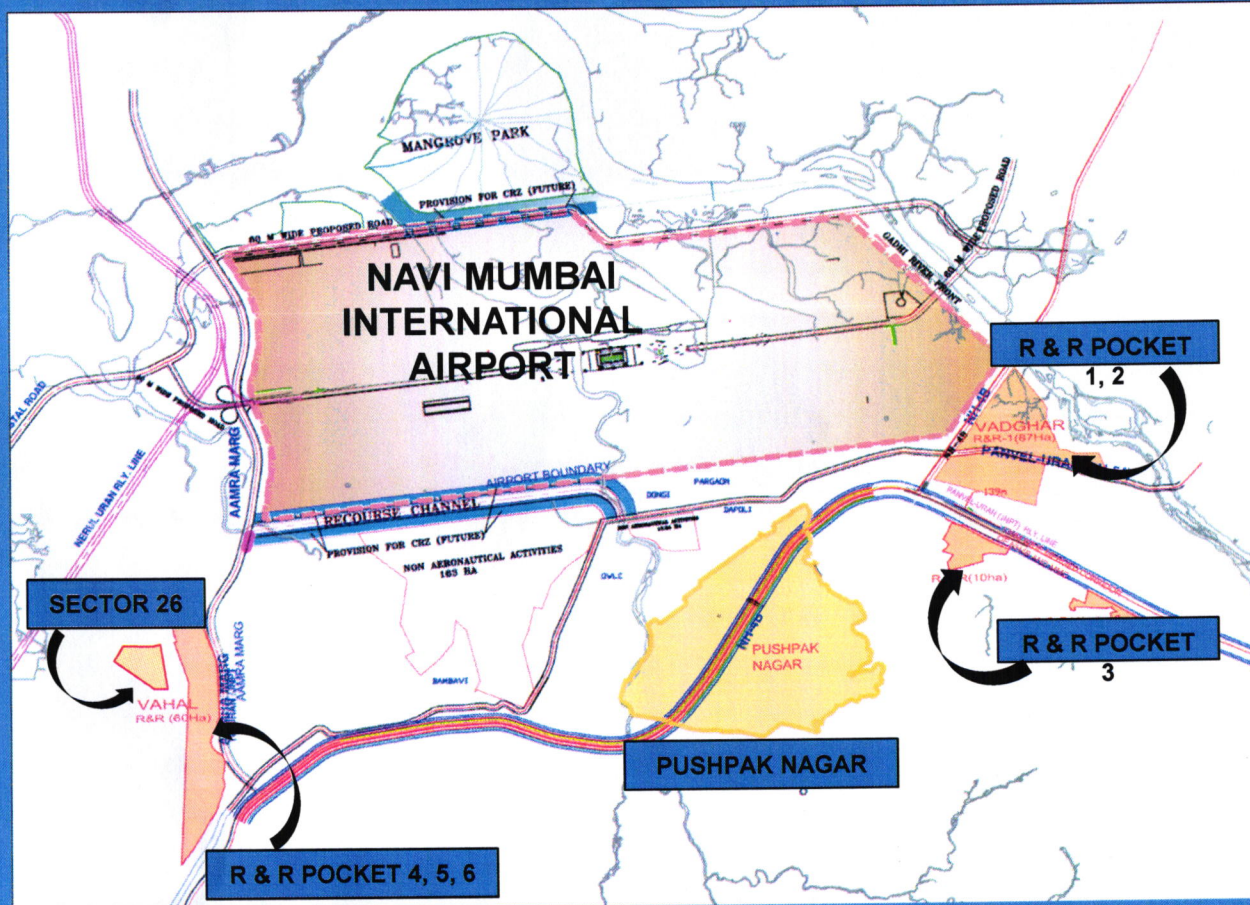

POCKET 1 & 2

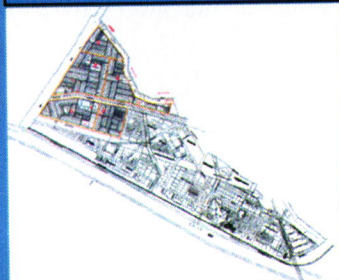

SECTOR 25 & 25A

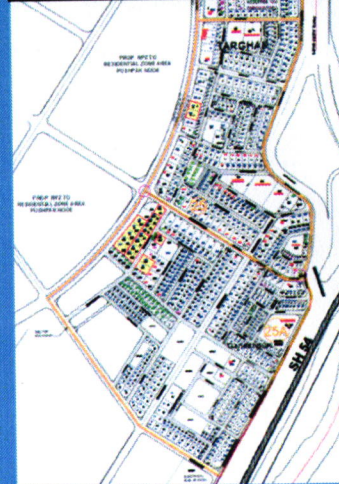

DRAW DATE : 01/01/2018

For identifying plots affected by Survey Nos. under Court Stay Order, the Universal Database of <https://gis.cidcoindia.com/agportal/> (CLAIMS) has been used.



# DRAW OF PLOT OF REHABILITATION AND RESETTLEMENT OF AIRPORT VILLAGES

<b>BLOCK - 1</b>	02 plots	<b>Sector no.</b>	R2	R5
Plot Range	50 sq.mt.	Plot no.	167	128A

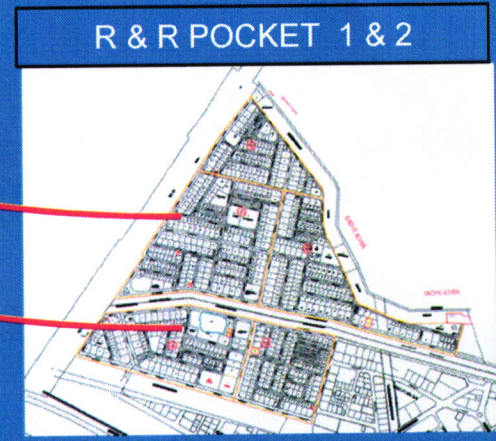
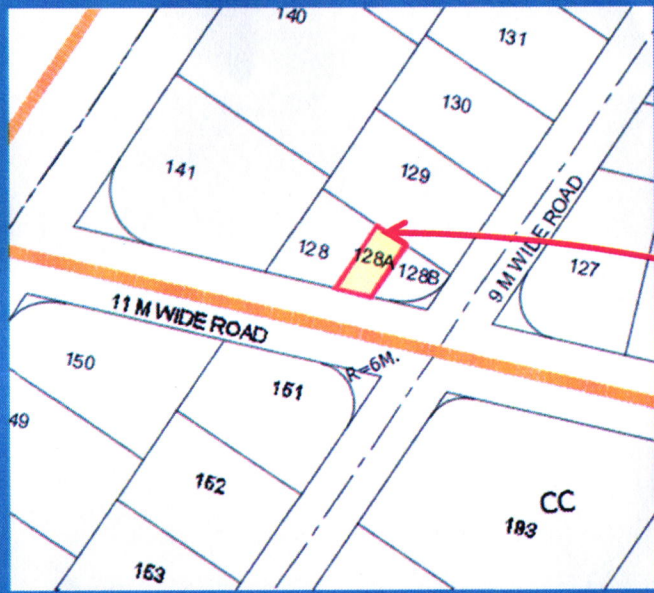

For identifying plots affected by Survey Nos. under Court Stay Order, the Universal Database of <https://ols.cidcoindia.com/portal/> (CLAIMS) has been used.

*Qum*  
01/01/18

*Satish*

*NBC*



# DRAW OF PLOT OF REHABILITATION AND RESETTLEMENT OF AIRPORT VILLAGES

<b>BLOCK - 2</b>	02 plots	<b>Sector no.</b>	R1	<b>25A</b>
Plot Range	70 sq.mt.	Plot no.	31A	18A

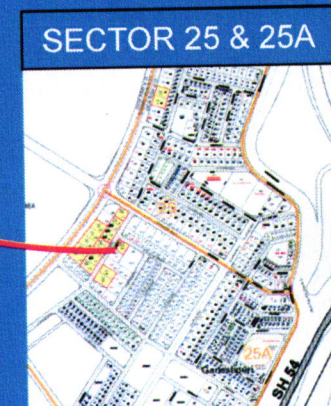
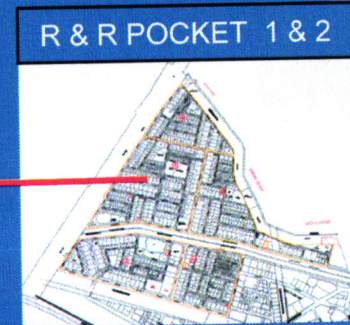

For identifying plots affected by Survey Nos. under Court Stay Order, the Universal Database of <http://vib.co.com/nci/comp/portal> (CLalMS) has been used.

*9mm*  
*01/01/18*

*setil*

NBC

# DRAW OF PLOT OF REHABILITATION AND RESETTLEMENT OF AIRPORT VILLAGES

<b>BLOCK - 3</b>	02 plots	<b>Sector no.</b>	R3
Plot Range	120 sq.mt.	Plot no.	87, 15A

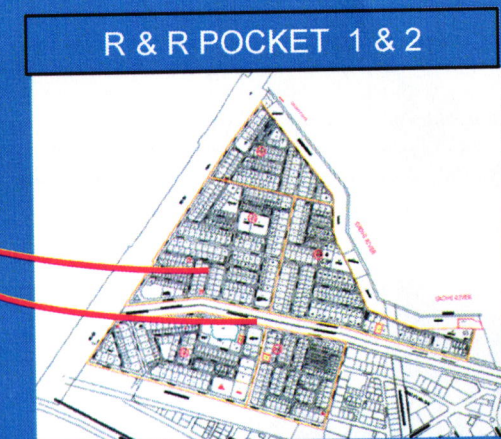

For identifying plots affected by Survey Nos. under Court Stay Order, the Universal Database of [www.cad.cad.cad.com](http://www.cad.cad.cad.com) (CLAIMS) has been used.

*Quill*  
01/01/18

*Patil*

*NBC*



# DRAW OF PLOT OF REHABILITATION AND RESETTLEMENT OF AIRPORT VILLAGES

<b>BLOCK - 4</b>	02 plots	<b>Sector no.</b>	R2
Plot Range	230, 280 sq.mt.	Plot no.	4, 5

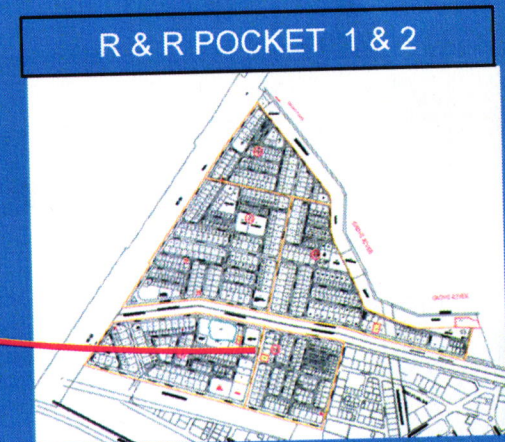
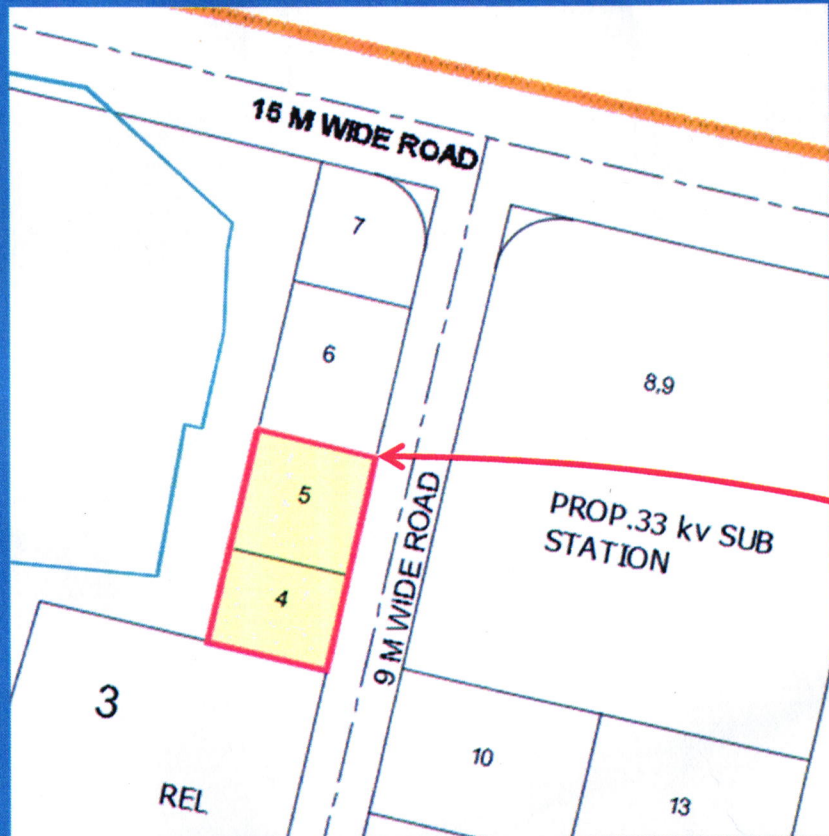

For identifying plots affected by Survey Nos. under Court Stay Order, the Universal Database of <http://gm.cidco.gov.in/portal/> (CLAIMS) has been used.

*Quam*  
01/01/18

*Patil*

*NBC*



# DRAW OF PLOT OF REHABILITATION AND RESETTLEMENT OF AIRPORT VILLAGES

<b>BLOCK - 5</b>	02 plots	<b>Sector no.</b>	R1
Plot Range	570 sq.mt.	Plot no.	R4
			97
			218

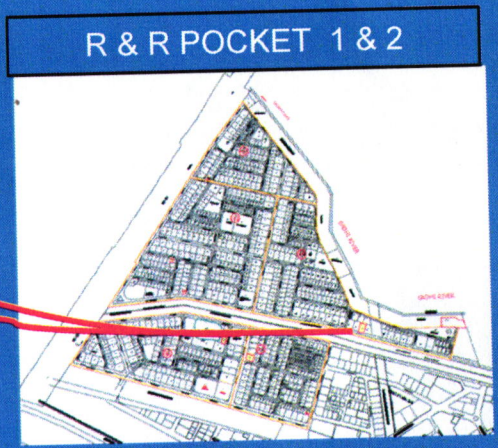
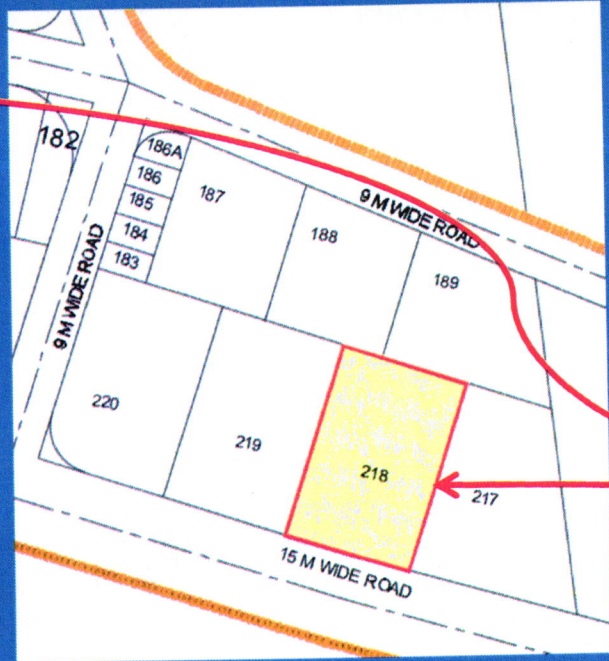
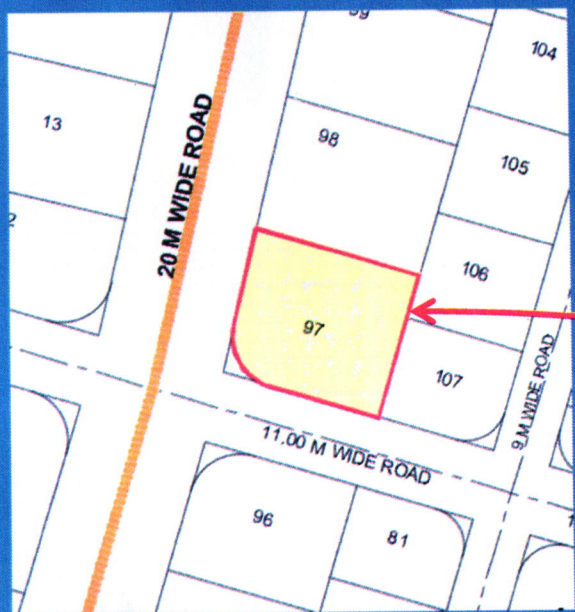

For identifying plots affected by Survey Nos. under Court Stay Order, the Universal Database of <https://gis.cisrindia.com/portal/> (CLalMS) has been used.

*Qum*  
01/01/18

*Star*

MBC



# DRAW OF PLOT OF REHABILITATION AND RESETTLEMENT OF AIRPORT VILLAGES

<b>BLOCK - 6</b>	04 plots	<b>Sector no.</b>	<b>25A</b>
Plot Range	370, 380, 410sq.mt.	Plot no.	1B, 1C, 1D, 1E

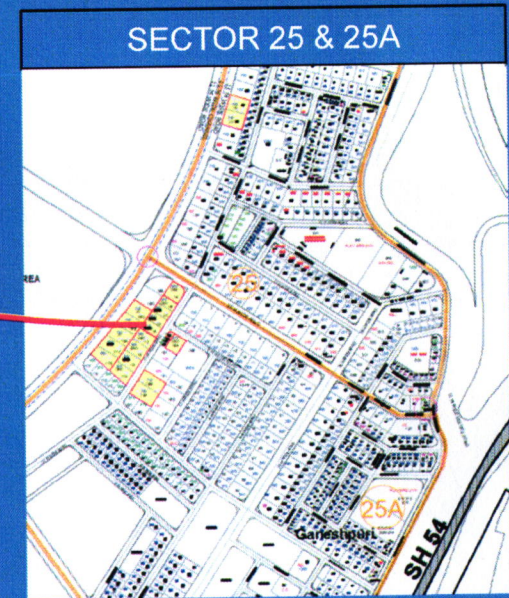
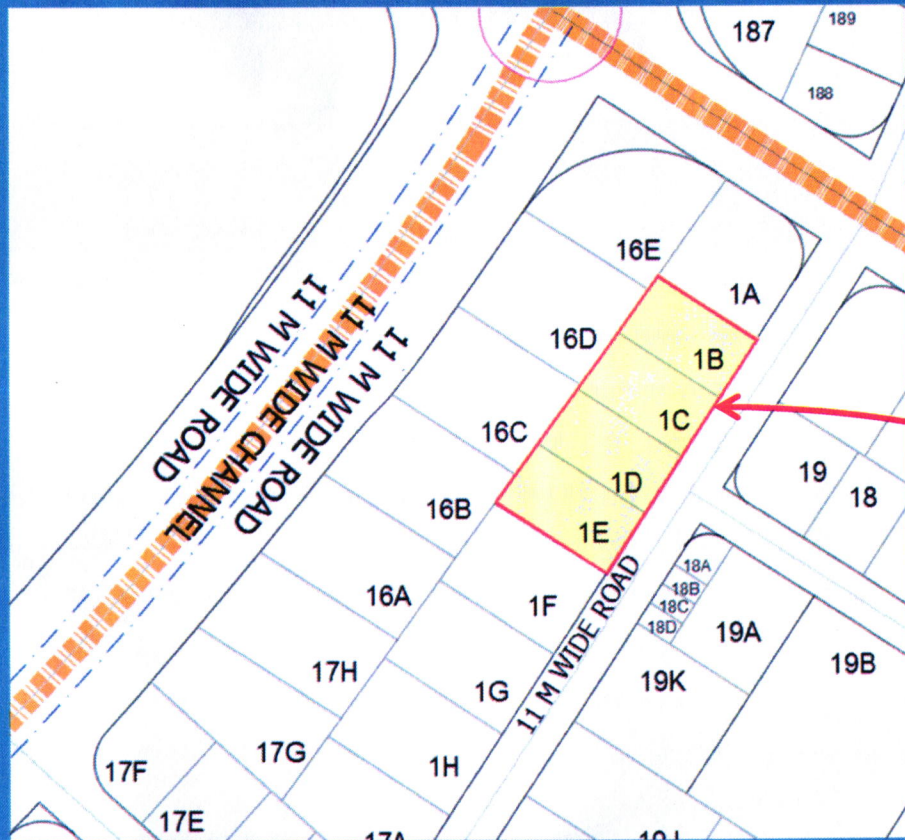

For identifying plots affected by Survey Nos. under Court Stay Order, the Universal Database of <http://www.cidcoindia.com/eng/cita> (CLAIMS) has been used.

*Qmm*  
01/01/18

*statu*

NBC

# DRAW OF PLOT OF REHABILITATION AND RESETTLEMENT OF AIRPORT VILLAGES

<b>BLOCK - 7</b>	02 plots	<b>Sector no.</b>	<b>25A</b>
Plot Range	570, 580 sq.mt.	Plot no.	1A, 19A

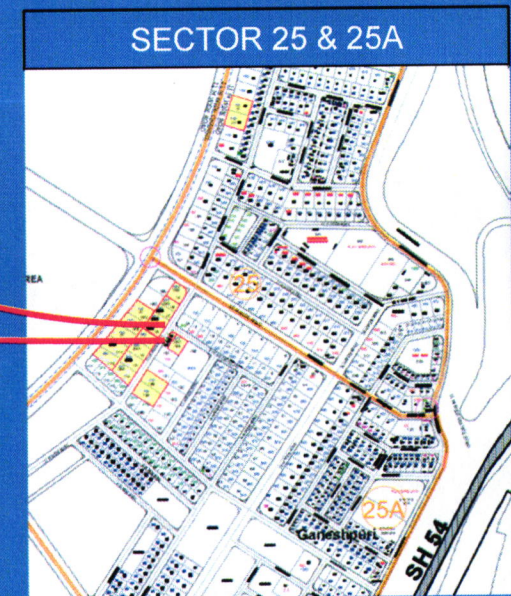
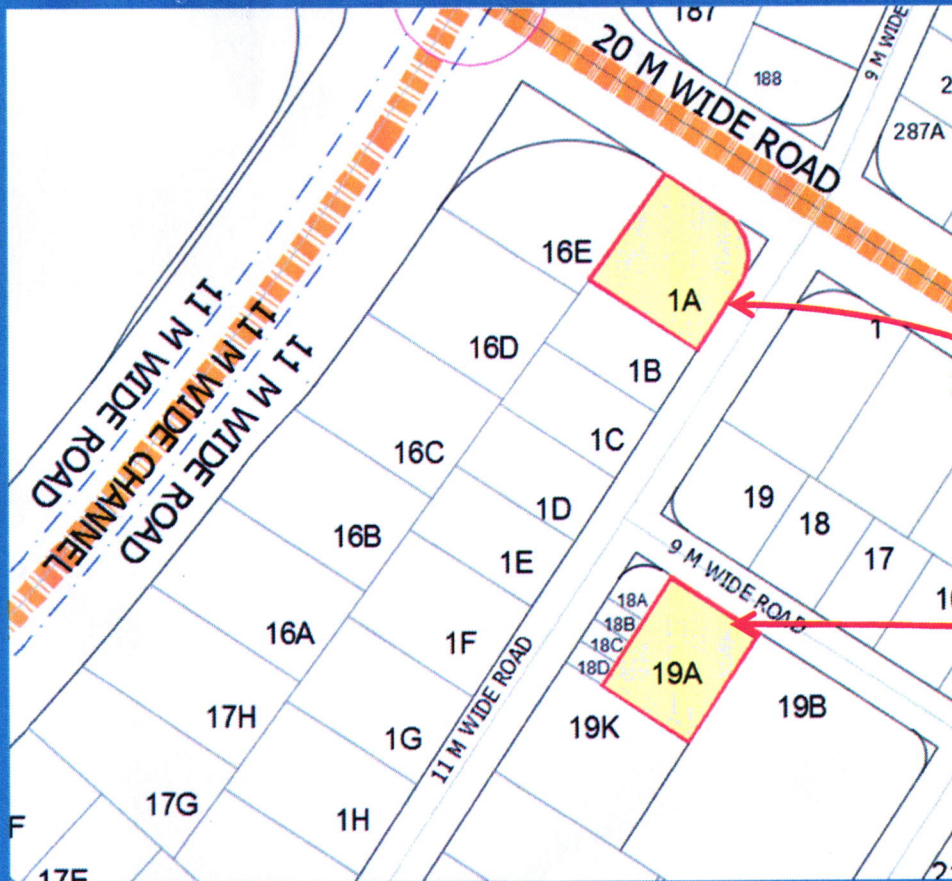

For identifying plots affected by Survey Nos. under Court Stay Order, the Universal Database of <http://clalms.cidco.gov.in> (CLalMS) has been used.

*QMM*  
01/01/18

*Satish*

*NBC*



# DRAW OF PLOT OF REHABILITATION AND RESETTLEMENT OF AIRPORT VILLAGES

<b>BLOCK - 8</b>	04 plots	<b>Sector no.</b>	<b>25A</b>
Plot Range	570, 580, 620, 640 sq.mt.	Plot no.	1F, 1G, 1H, 17A

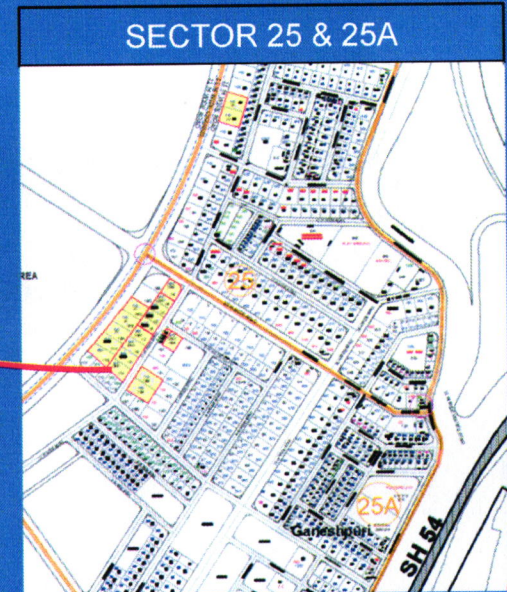
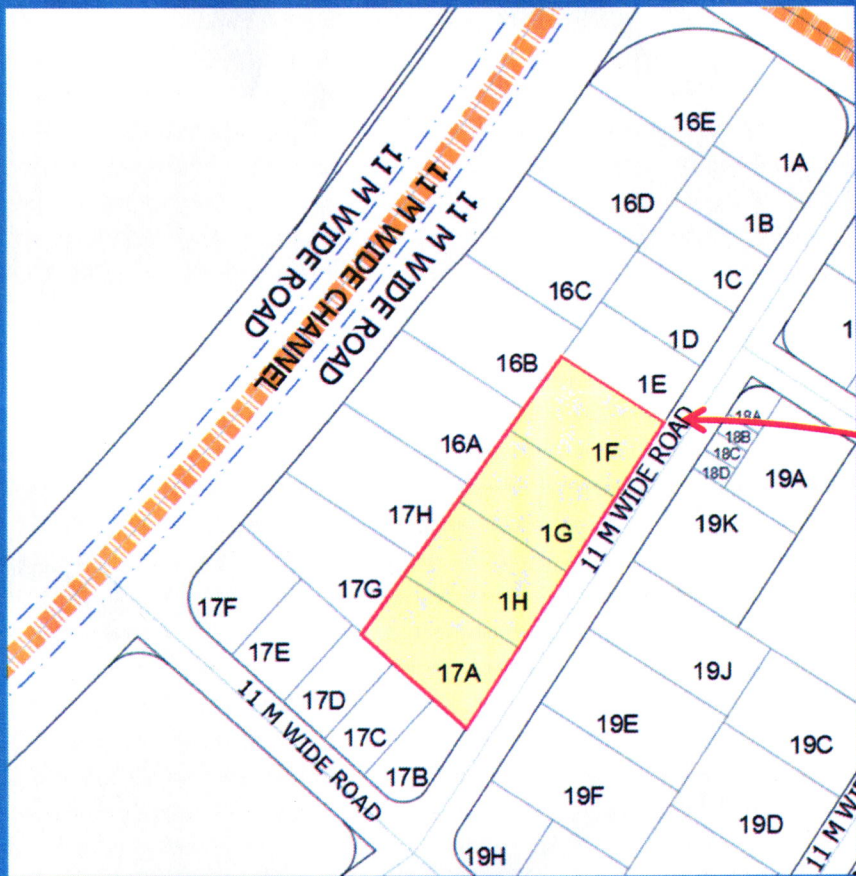

For identifying plots affected by Survey Nos. under Court Stay Order, the Universal Database of <http://zoh.arp.gov.in/arcgis/rest/services/> (CLAMS) has been used.

Q 01/01/18  
S  
NBC

# DRAW OF PLOT OF REHABILITATION AND RESETTLEMENT OF AIRPORT VILLAGES

<b>BLOCK - 9</b>	05 plots	<b>Sector no.</b>	<b>25A</b>
Plot Range	650, 700 sq.mt.	Plot no.	16A, 16B, 16C, 17G, 17H

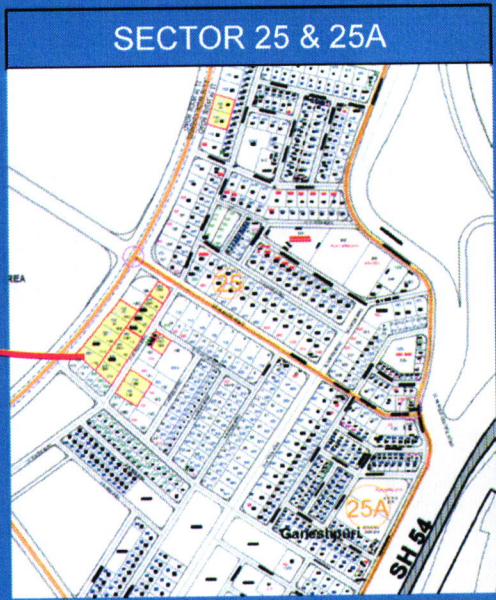
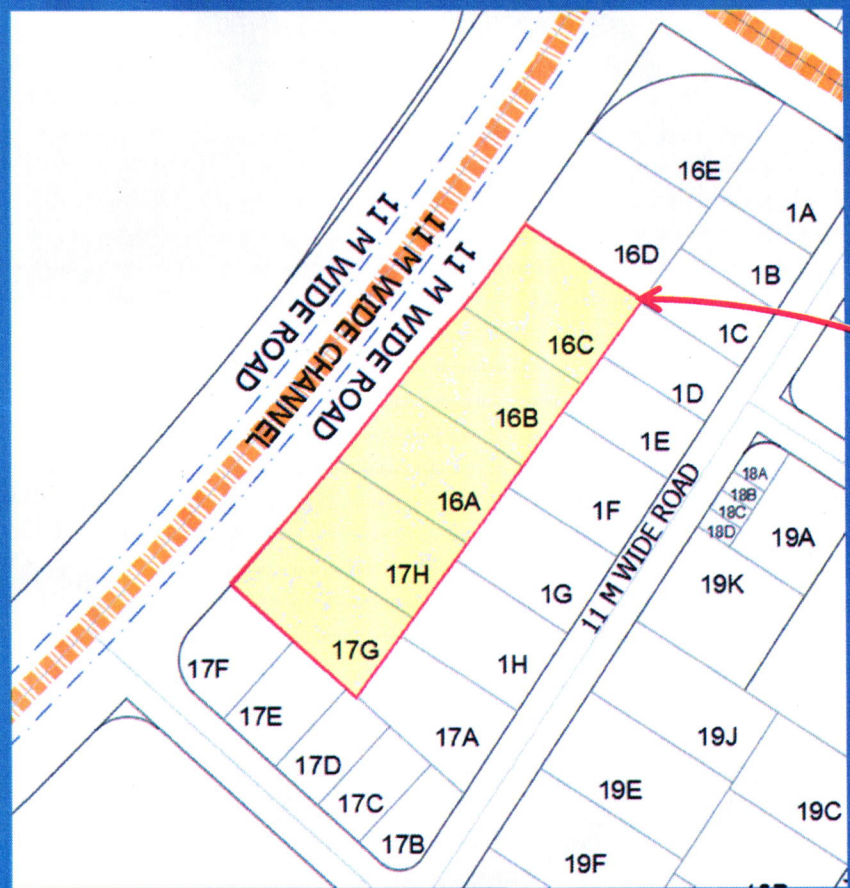

For identifying plots affected by Survey Nos. under Court Stay Order, the Universal Database of <http://www.cisrindia.com/portal/> (CLAIMS) has been used.

D 01/01/18 S NBC



# DRAW OF PLOT OF REHABILITATION AND RESETTLEMENT OF AIRPORT VILLAGES

<b>BLOCK - 10</b>	02 plots	<b>Sector no.</b>	<b>25A</b>
Plot Range	700, 780 sq.mt.	Plot no.	19E, 19F

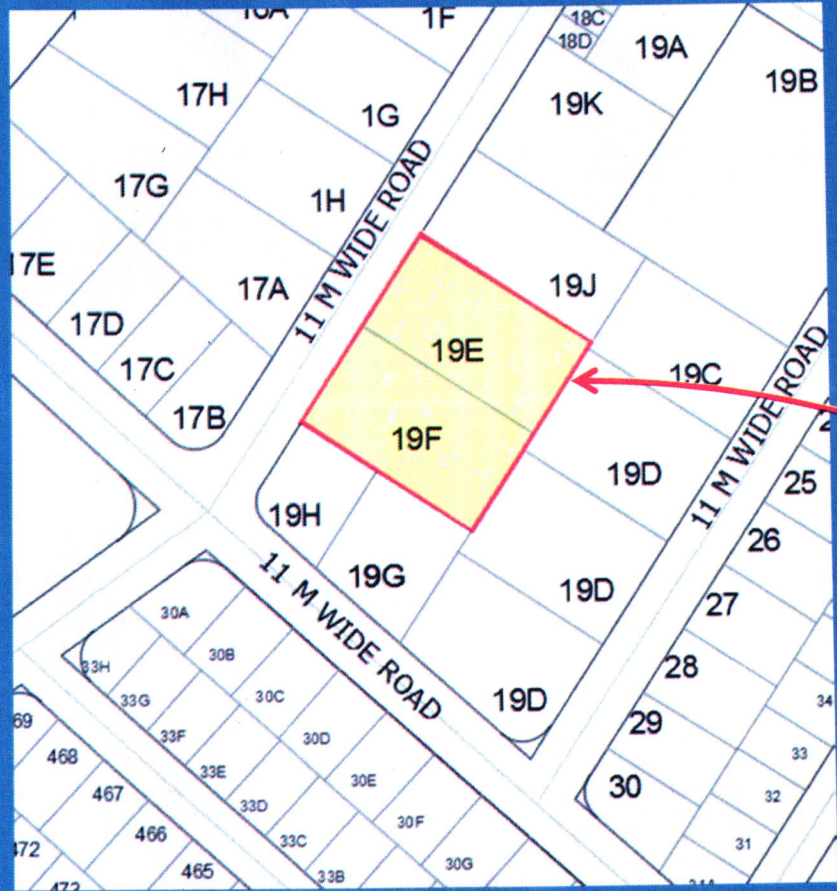

For identifying plots affected by Survey Nos. under Court Stay Order, the Universal Database of <http://mhc.cidco.gov.in> (CLAIMS) has been used.

M 01/01/19  
Satil  
NBC



# DRAW OF PLOT OF REHABILITATION AND RESETTLEMENT OF AIRPORT VILLAGES

<b>BLOCK - 11</b>	02 plots	<b>Sector no.</b>	<b>25</b>
Plot Range	700 sq.mt.	Plot no.	177, 178

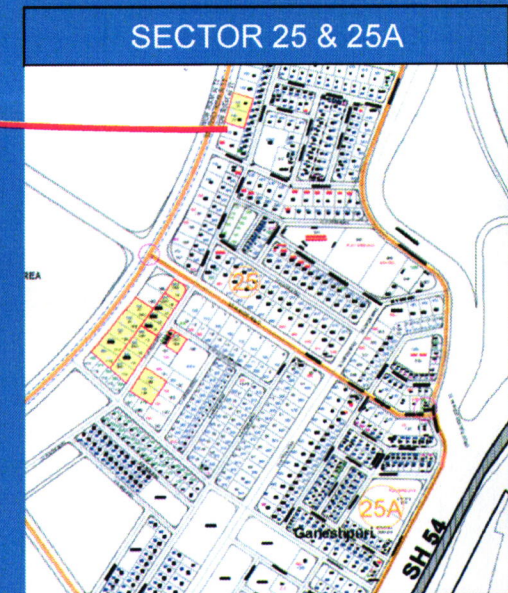
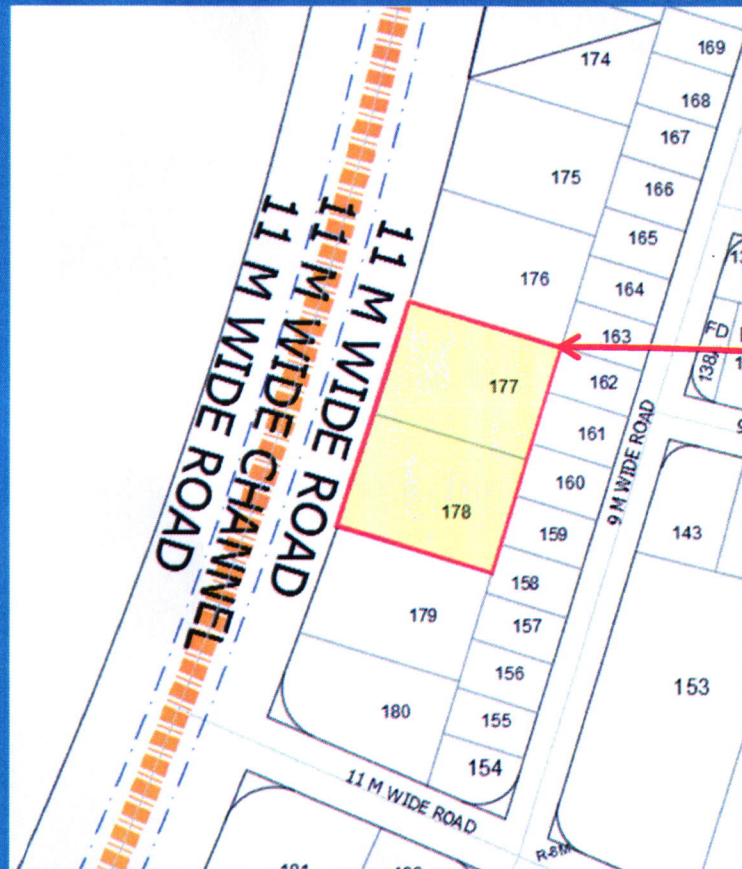

For identifying plots affected by Survey Nos. under Court Stay Order, the Universal Database of <https://ais.cdcourts.gov/sports/> (CLAIMS) has been used.

*Qum*  
01/01/18

*still*

NBC