

# DRAW OF PLOTS FOR REHABILITATION & RESETTLEMENT OF AIRPORT VILLAGES AT R&R POCKET- 6 (NEW LAYOUT AT SECTOR 25A)

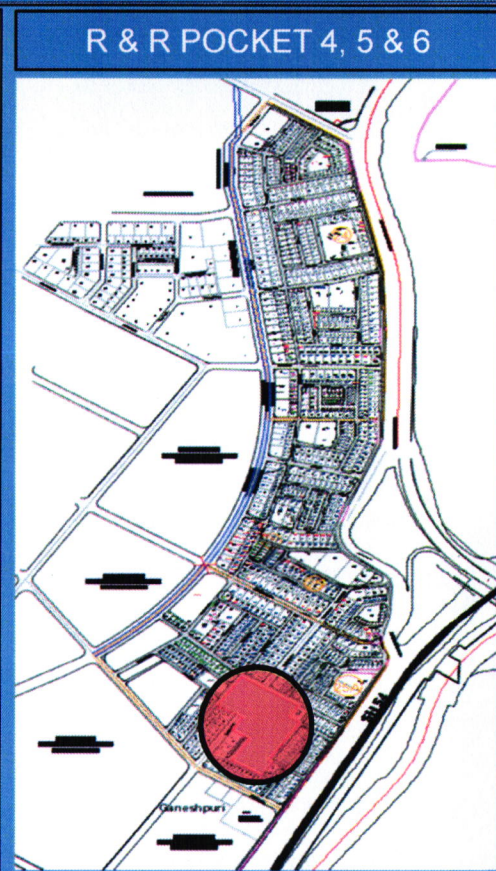
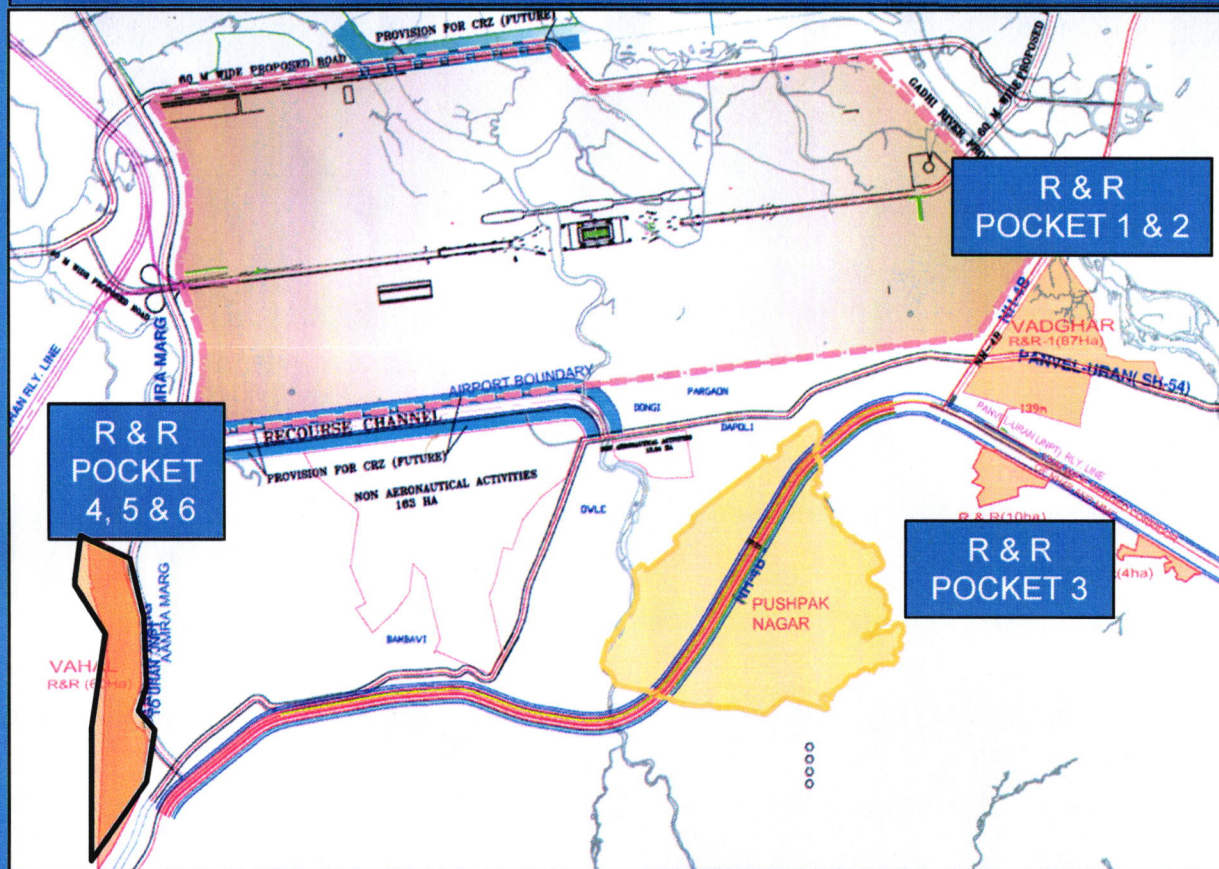

DRAW DATE : 01/01/2018

# DRAW OF PLOT OF REHABILITATION AND RESETTLEMENT OF AIRPORT VILLAGES

**BLOCK - 1**

12 plots

Plot Range

40, 50 sq.mt.

**Sector no.**

**25A**

Old plot no.

336E, 336F, 336G, 336H, 337C,  
337D, 337E, 337F, 337G, 337H,  
336D, 337B

New plot no.

363, 364, 365, 366, 367, 368, 369,  
370, 371, 372, 373, 374

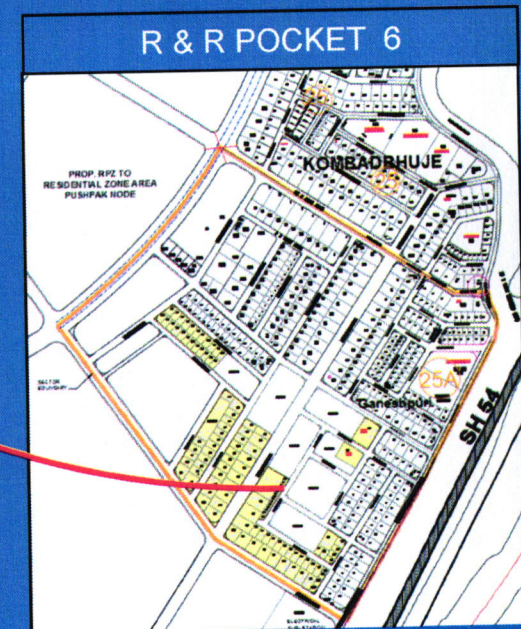

*Qum*  
*01/01/18* *Latil*

NBC

# DRAW OF PLOT OF REHABILITATION AND RESETTLEMENT OF AIRPORT VILLAGES

**BLOCK - 2**

3 plots

Plot Range

80, 110, 140 sq.mt.

**Sector no.**

**25A**

Old plot no.

325, 326, 383

New plot no.

388, 389, 389A

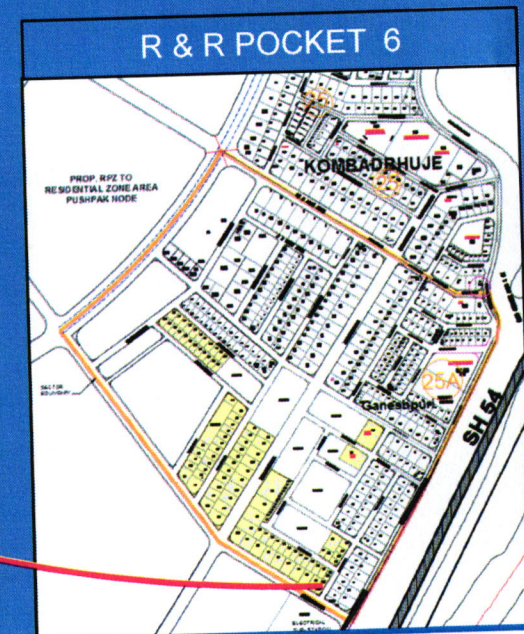

*QMM 01/01/18*

*Start*

*NBC*

# DRAW OF PLOT OF REHABILITATION AND RESETTLEMENT OF AIRPORT VILLAGES

**BLOCK - 3**

4 plots

Plot Range

150, 210 sq.mt.

**Sector no.**

**25A**

Old plot no.

382A, 383A, 389, 380+380A

New plot no.

352, 353, 354, 355

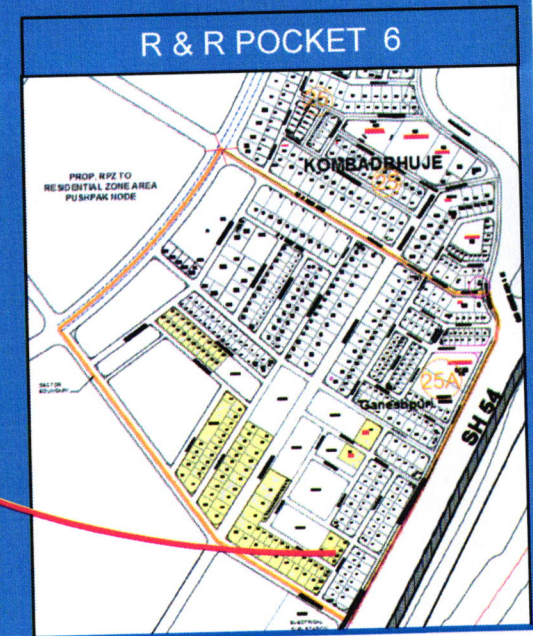
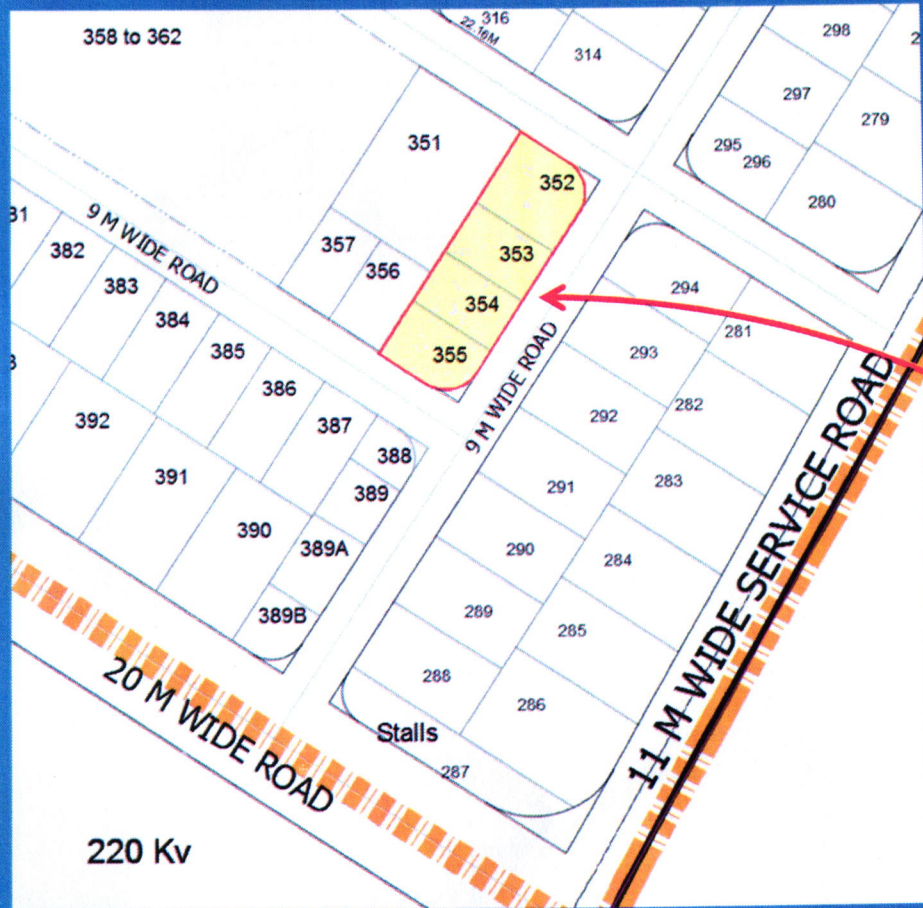

*QMM*  
*01/01/18*

*stall*

*NBC*

# DRAW OF PLOT OF REHABILITATION AND RESETTLEMENT OF AIRPORT VILLAGES

**BLOCK - 4**

2 plots

Plot Range

160 sq.mt.

**Sector no.**

**25A**

Old plot no.

384, 385

New plot no.

356, 357

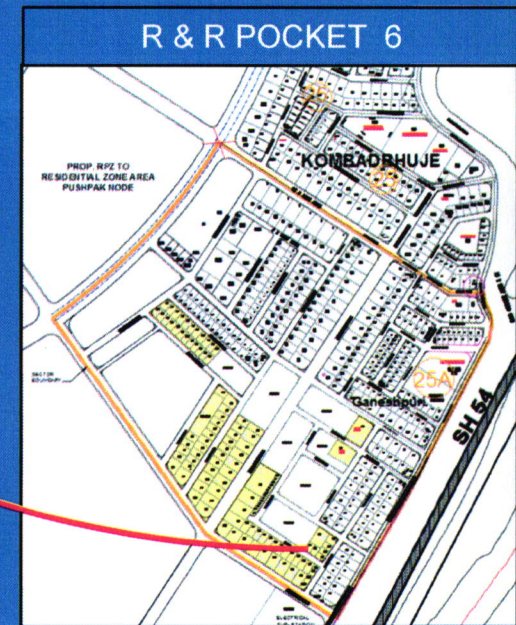

*9mm 01/01/18*      *stall*      *NBC*

# DRAW OF PLOT OF REHABILITATION AND RESETTLEMENT OF AIRPORT VILLAGES

**BLOCK - 5**

12 plots

Plot Range

170, 180, 190, 220 sq.mt.

**Sector no.**

**25A**

Old plot no.

386, 387, 388, 342A, 345, 347, 348,  
258, 259, 260, 261, 343

New plot no.

470, 471, 472, 473, 474, 475, 476,  
477, 478, 479, 480, 481

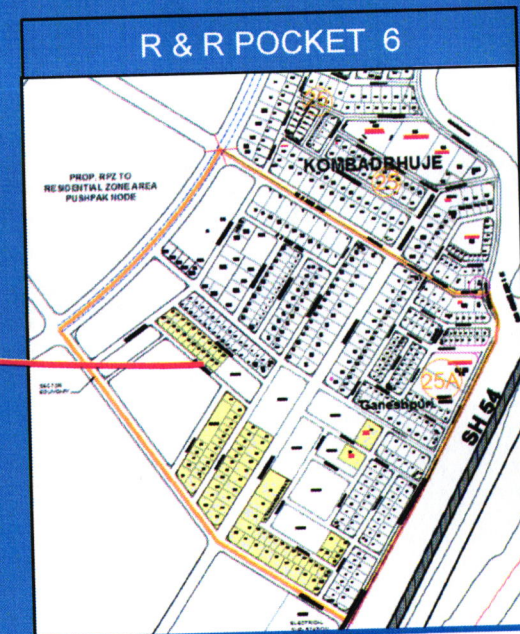
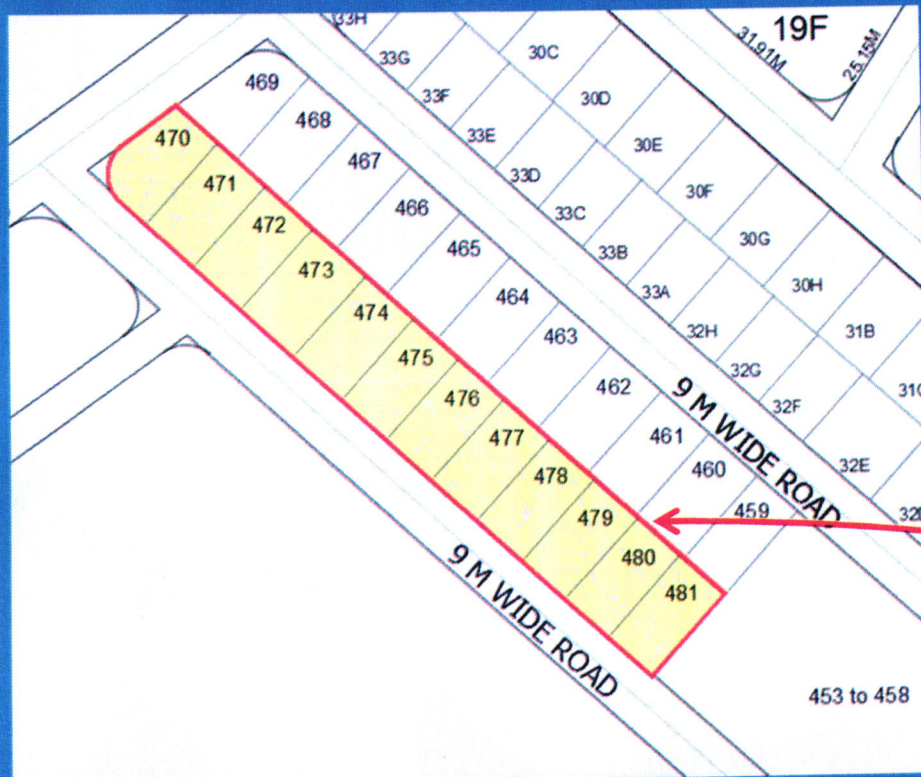

*QMN*  
01/01/18

*Satish*

*NBC*

# DRAW OF PLOT OF REHABILITATION AND RESETTLEMENT OF AIRPORT VILLAGES

<b>BLOCK - 6</b>	11 plots	<b>Sector no.</b>	<b>25A</b>
Plot Range	160, 190, 200 sq.mt.	Old plot no.	382, 344, 346, 358, 360, 361, 363, 364, 365, 366, 380B
		New plot no.	459, 460, 461, 462, 463, 464, 465, 466, 467, 468, 469

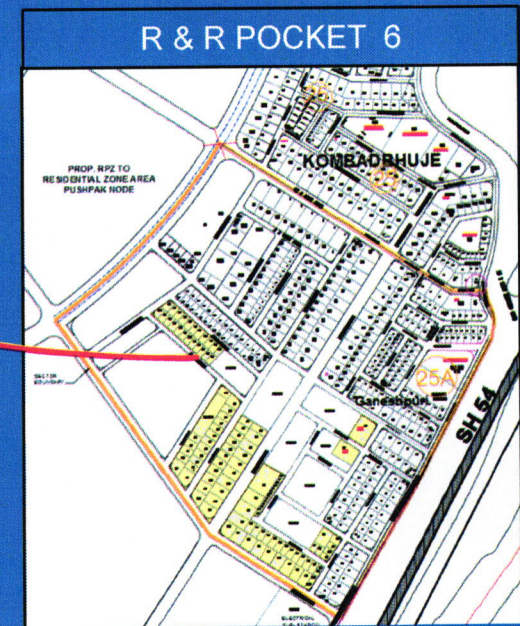
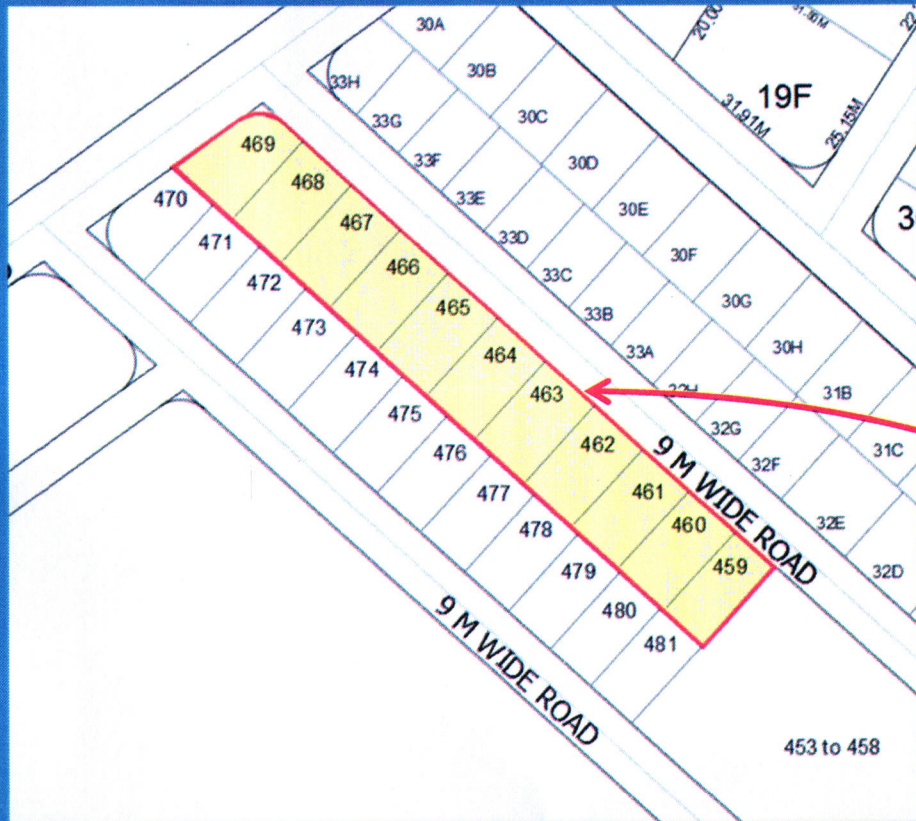

*Qum*  
*01/01/18*  
*Satish*  
*NBC*

# DRAW OF PLOT OF REHABILITATION AND RESETTLEMENT OF AIRPORT VILLAGES

**BLOCK - 7**

12 plots

Plot Range

210, 220 sq.mt.

**Sector no.**

**25A**

Old plot no.

350, 356, 357, 359, 362, 367, 262,  
263, 264, 353, 354, 355

New plot no.

376, 377, 378, 379, 380, 381, 382,  
383, 384, 385, 386, 387

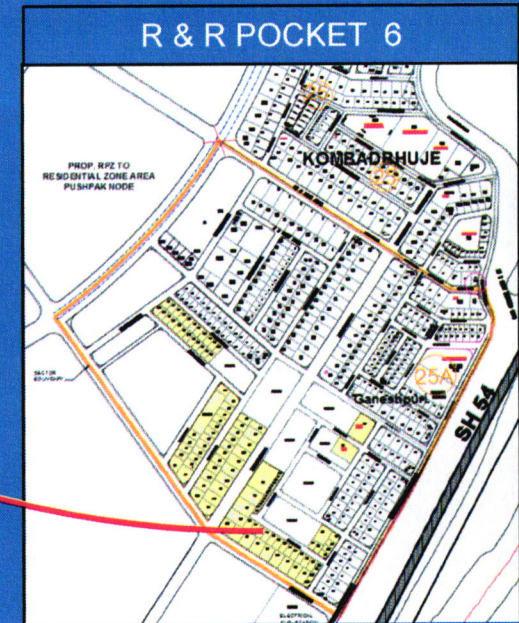

*QUNN  
01/01/12*

*Satish*

*NBC*



# DRAW OF PLOT OF REHABILITATION AND RESETTLEMENT OF AIRPORT VILLAGES

<b>BLOCK - 8</b>	5 plots	<b>Sector no.</b>	<b>25A</b>
Plot Range	250, 260 sq.mt.	Old plot no.	331, 333, 334, 335, 380C
		New plot no.	443, 444, 445, 446, 452

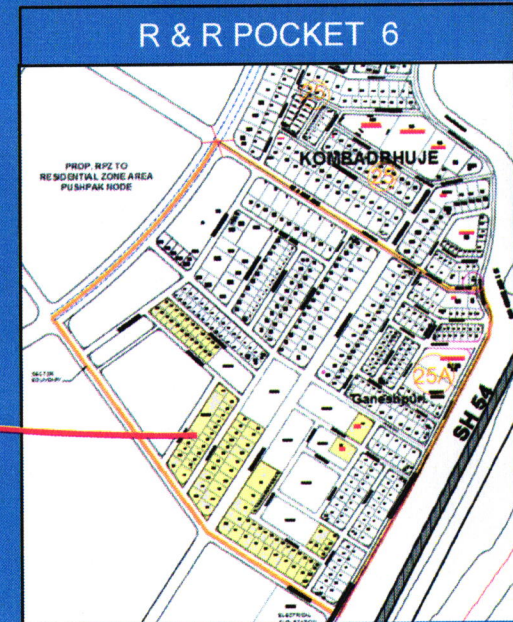
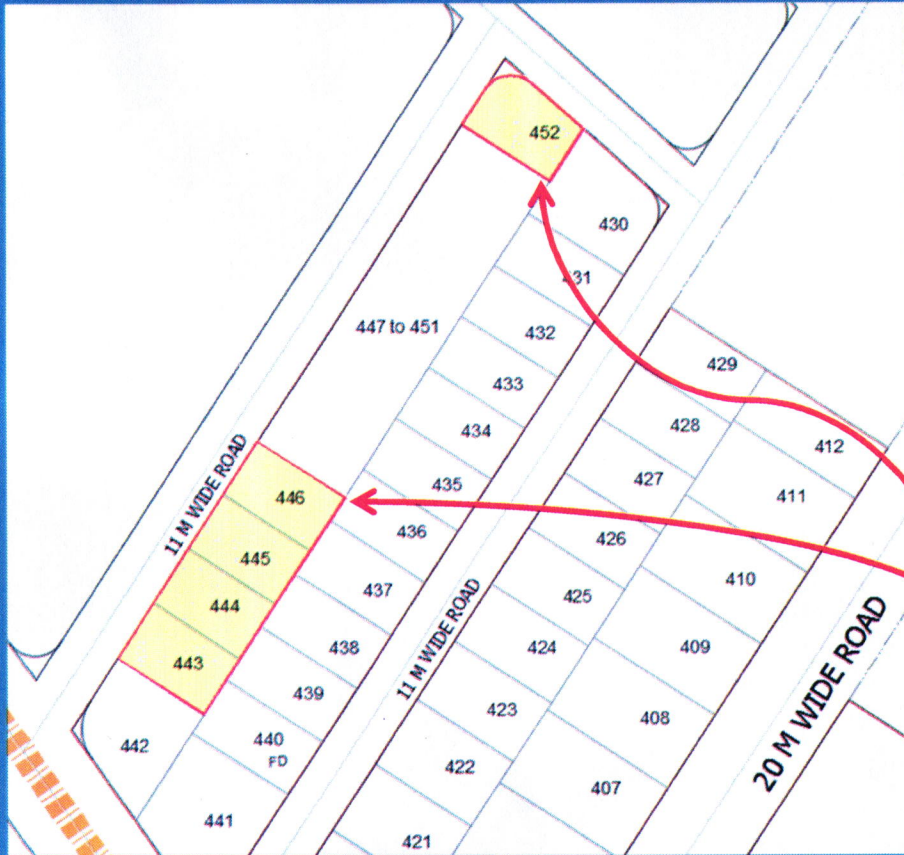

*Qm*  
01/01/12

*Satish*

*NBC*

# DRAW OF PLOT OF REHABILITATION AND RESETTLEMENT OF AIRPORT VILLAGES

<b>BLOCK - 9</b>	10 plots	<b>Sector no.</b>	<b>25A</b>
Plot Range	260, 270, 390 sq.mt.	Old plot no.	332, 338, 339, 340A, 351, 352, 337, 337A, 380D, 254
		New plot no.	430, 431, 432, 433, 434, 435, 436, 437, 438, 439

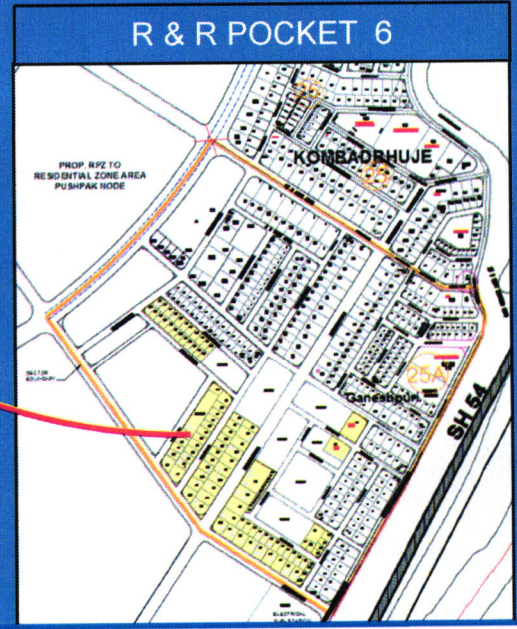
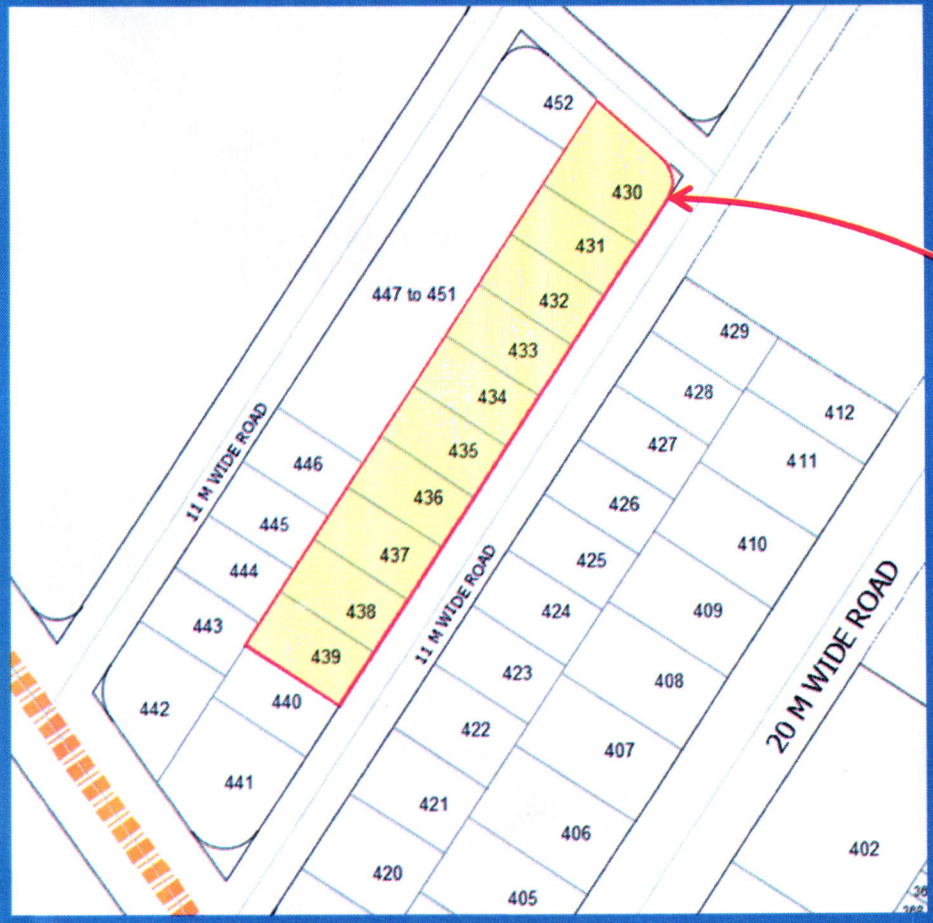

*01/01/18*  
*Satish*  
*NBC*

# DRAW OF PLOT OF REHABILITATION AND RESETTLEMENT OF AIRPORT VILLAGES

**BLOCK - 10**

10 plots

Plot Range

280, 290, 300, 330, 340, 390 sq.mt.

**Sector no.**

**25A**

Old plot no.

330, 340, 341, 342, 328, 329, 327,  
381, 349A, 253

New plot no.

422, 421, 420, 423, 424, 425, 426,  
427, 428, 429

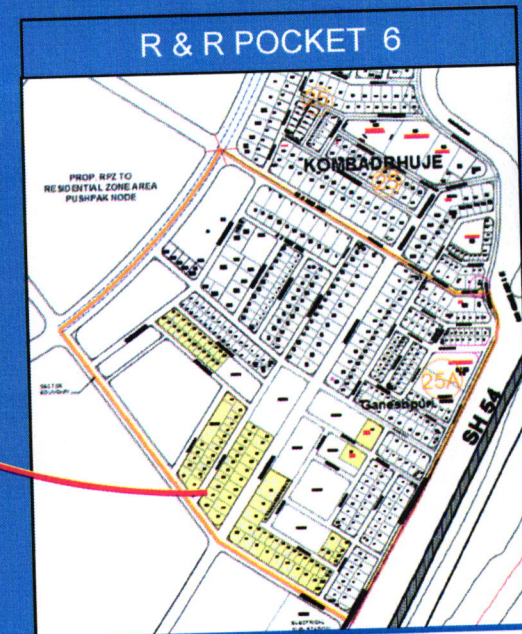
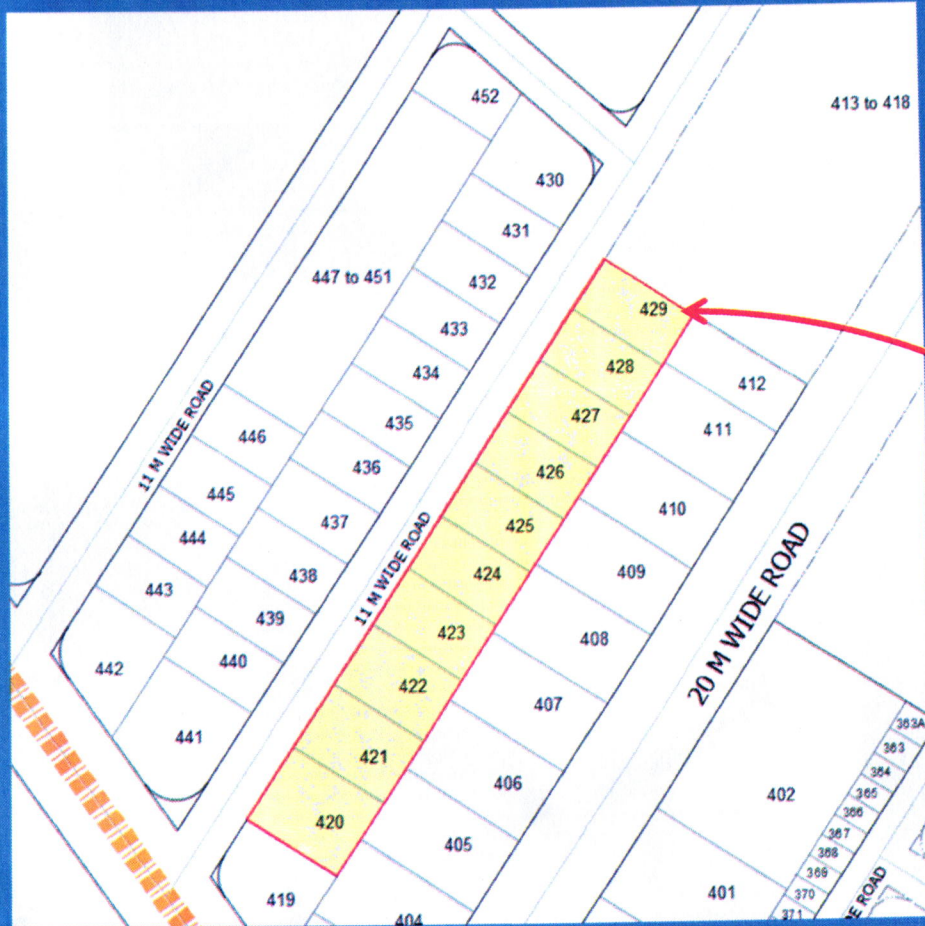

*Q. V. M. M.*  
*04/01/18*

*Handwritten signature*

NBC



# DRAW OF PLOT OF REHABILITATION AND RESETTLEMENT OF AIRPORT VILLAGES

<b>BLOCK - 11</b>	8 plots	<b>Sector no.</b>	<b>25A</b>
Plot Range	370, 380, 420, 440, 450, 470 sq.mt.	Old plot no.	255+256+257, 336B, 349, 251, 368, 370, 375, 378
		New plot no.	390, 391, 392, 393, 394, 395, 396, 397

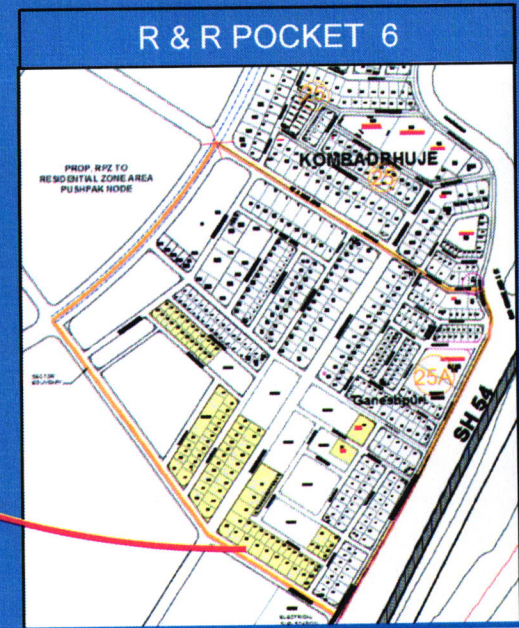
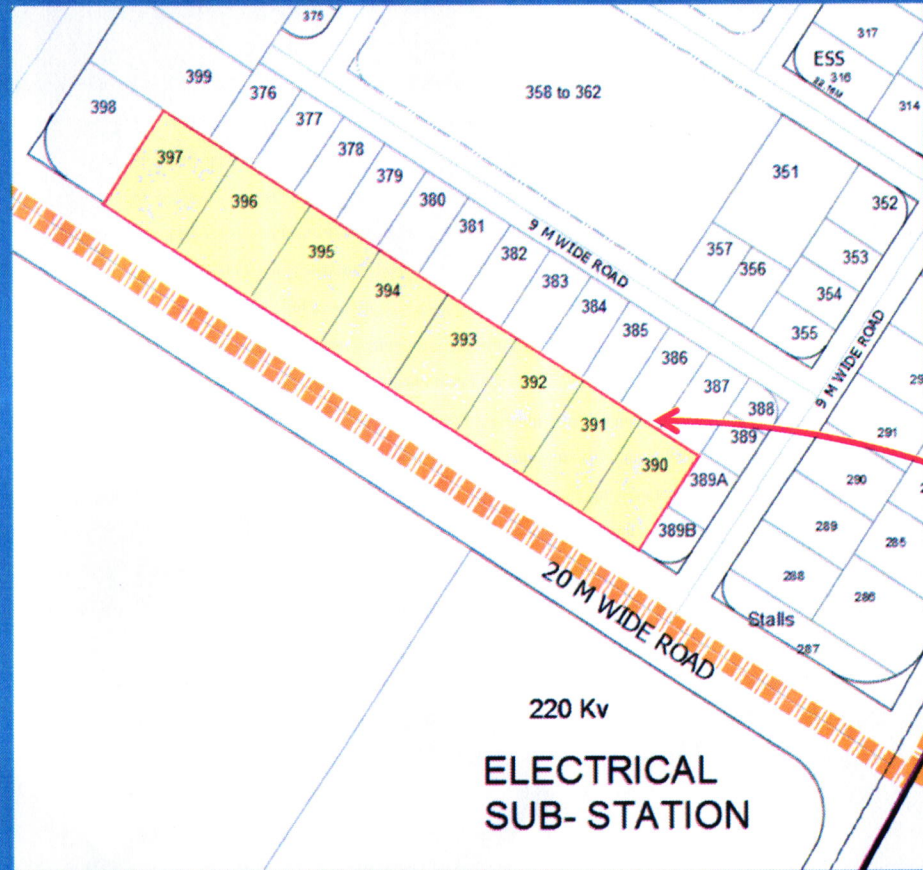

*QMM*  
01/01/16

*Satish*

*NBC*

# DRAW OF PLOT OF REHABILITATION AND RESETTLEMENT OF AIRPORT VILLAGES

<b>BLOCK - 12</b>	2 plots	<b>Sector no.</b>	<b>25A</b>
Plot Range	410 sq.mt.	Old plot no.	252, 381A
		New plot no.	419, 442

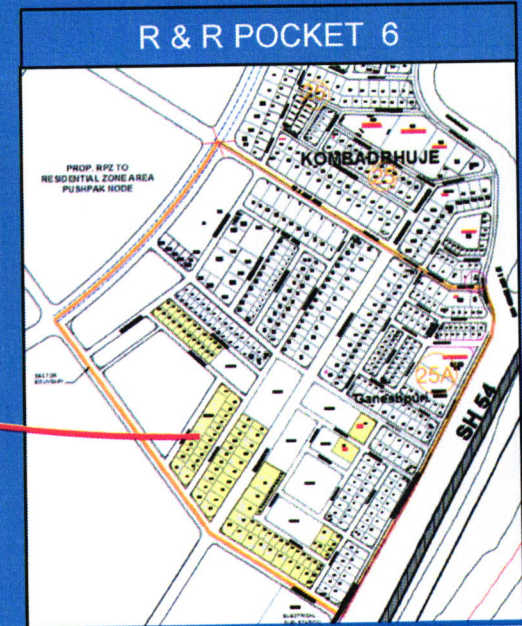

*QMM 01/01/12*      *Sate*      *NBC*

# DRAW OF PLOT OF REHABILITATION AND RESETTLEMENT OF AIRPORT VILLAGES

<b>BLOCK - 13</b>	7 plots	<b>Sector no.</b>	<b>25A</b>
Plot Range	460, 470, 480, 490 sq.mt.	Old plot no.	371, 379, 336C, 373, 372, 379B, 377
		New plot no.	405, 406, 407, 408, 409, 410, 411

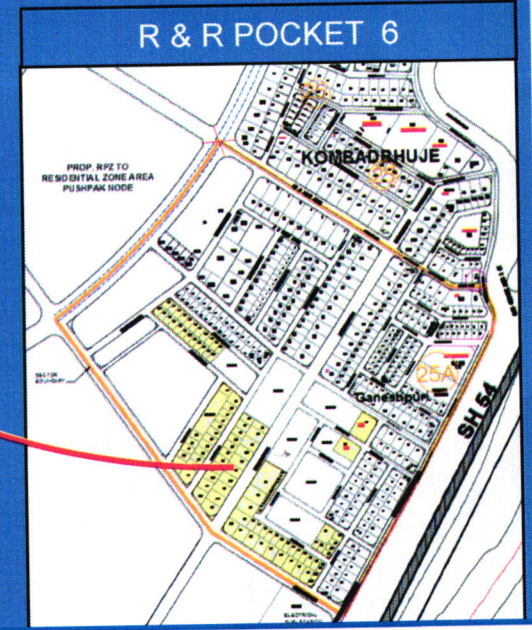
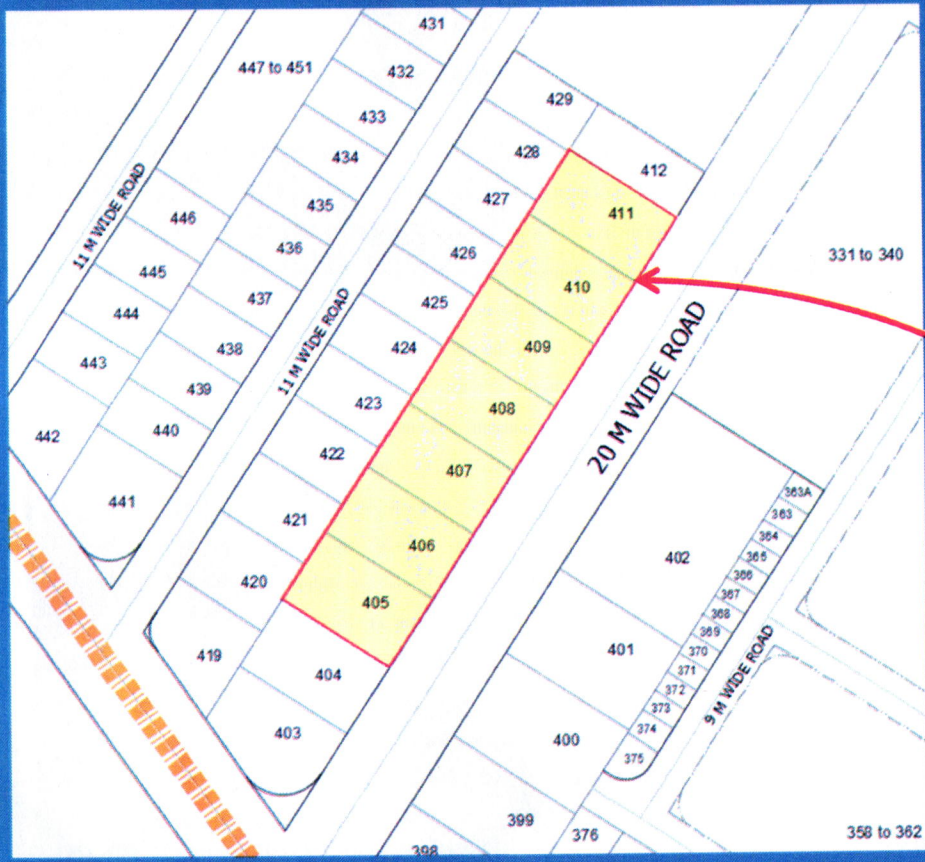

*Handwritten notes:*  
 01/01/18  
 NBC

# DRAW OF PLOT OF REHABILITATION AND RESETTLEMENT OF AIRPORT VILLAGES

<b>BLOCK - 14</b>	3 plots
Plot Range	500, 510 sq.mt.

<b>Sector no.</b>	<b>25A</b>
Old plot no.	379C, 379D, 379A
New plot no.	403, 404, 441

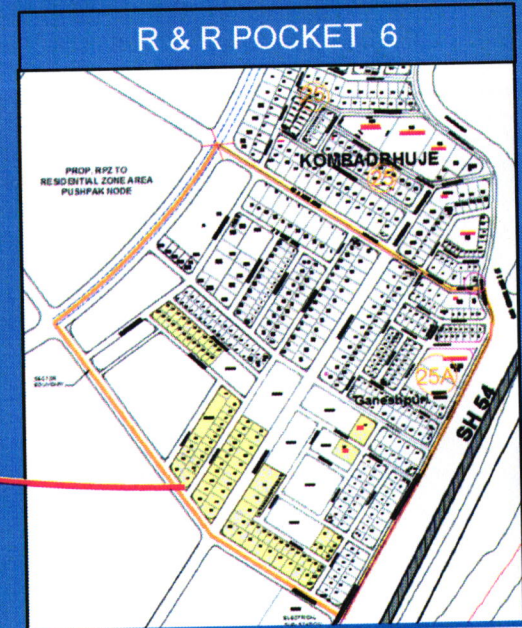

*9mm 01/01/14*      *Satish*      *NBC*

# DRAW OF PLOT OF REHABILITATION AND RESETTLEMENT OF AIRPORT VILLAGES

**BLOCK - 15**

4 plots

Plot Range

570, 700, 1480 sq.mt.

**Sector no.**

**25A**

Old plot no.

369, 376, 374, 390A

New plot no.

399, 400, 401, 402

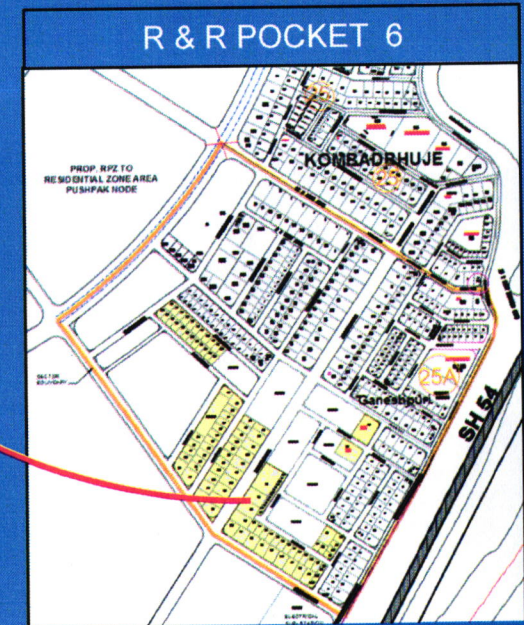

*9mm 01/09/14* *stati* *NBC*