

SEPTIC TANK REQUIREMENT											
BUILDING NUMBER	NUMBER OF TENEMENT	POPULATION	WATER REQUIREMENT					% FLOW TO SEWER		TOTAL FLOW LPD	TOTAL PROVIDED
			FLUSHING		DOMESTIC		TOTAL	FLUSHING 100%	DOMESTIC 85%		
			LPCD	LPD	LPCD	LPD	LPD	LPD	LPD	LPD	
1	2	(3) = (2) X 5	4	(5) = (3) X (4)	6	(7) = (3) X (6)	(8) = (5) + (7)	(9) = (5) X 100%	(10) = (7) X 85%	(11) = (9) + (10)	5.0 X 3.40 X 4.00
02-Wing E & F	39	195	54	10530	135	26325	36855	10530	22376.25	32906.25	
	ADD. TOILETS	8	54	432	126	1008	1440	432	856.80	1288.80	
	TOTAL			10962		27333	38295	10962	23233.05	34195.05	68000

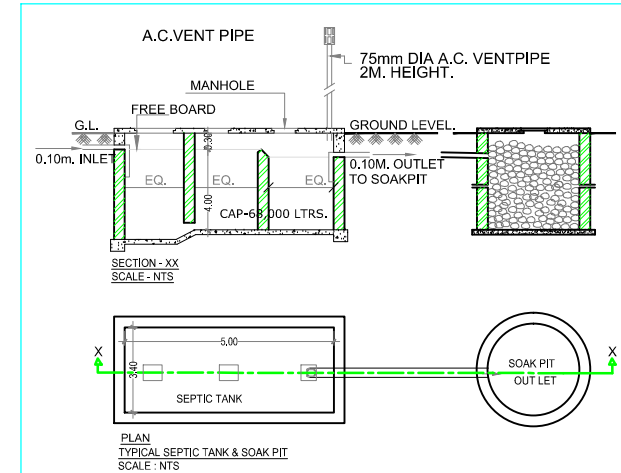

**STAMP OF APPROVAL 2/4**

AS BUILT DRAWING APPROVED Subject to the condition mentioned in this office Certificate

No:CIDCO/NAINA/Panvel/Adai/BP-00196/OC/Full/2022/0284

Dated-25 Oct 2022.

**Legend :-**

Sr.No.	Item	Site Plan On White Print	Building Plan On White Print
01.	Plot Line	—	—
02.	Existing Street	—	—
03.	Marginal Open Space	NO COLOUR	—
04.	Drainage & Sewerage Work	---	---
05.	Water Supply Work	---	---
06.	RWH Line	---	---
07.	Proposed Work	---	---

NOTE: ALL DIMENSIONS ARE IN METERS.  
INTERNAL WALL THICKNESS 0.10 M.  
EXTERNAL WALL THICKNESS 0.15 M.

**CONTENT OF THE SHEET**

SERVICES PLAN , U/G TANK PLAN , U/G TANK SECTION , U/G TANK AREAS CALCULATION , SEPTIC TANK & SECTION , SEPTIC TANK AREA CALCULATION , COMPOUND WALL SECTION , ENTRANCE GATE , R.O.H. DRAIN SECTION.

**CERTIFICATE OF AREA**

CERTIFIED THAT I/WE HAVE SURVEYED THE PLOT BEARING S. NO.27/1/(B)/2, AT- ADAI , TALUKA -PANVEL, DIST. -RAIGAD ON 20-11-2016 AND THAT THE DIMENSIONS OF THE SIDES ETC. OF THE PLOT STATED ON THE PLAN ARE AS MEASURED ON SITE AND AREA SO WORKED OUT IS 3027.93 SQUARE METERS.

M/s. PRAYAG PROPERTIES THROUGH Mr. PADEEP K. BHOPI

M/s. YASH ENTERPRISES THROUGH Mr. DEEPAK G. JITEKAR

(Signature of Architect.)  
AR. SWAPNIL KALYANKAR  
REGD. NO. CA / 2010 / 47491

M/s. PRAYAG PROPERTIES THROUGH Mr. PADEEP K. BHOPI

M/s. YASH ENTERPRISES THROUGH Mr. DEEPAK G. JITEKAR

(Signature of Architect.)  
AR. SWAPNIL KALYANKAR  
REGD. NO. CA / 2010 / 47491

**DESCRIPTION OF PROPOSAL & PROPERTY**

AS BUILT FOR PART OC (BUILDING-2)  
PROPOSED BUILDING PERMISSION ON S. NO.27/1/(B)/2, AT- ADAI , TALUKA -PANVEL, DIST. -RAIGAD.

DATE	15.10.2022
SCALE	1: 100, 1:200, 1: 500, 1: 5000, N.T.S.
DRN BY	IMRAN
CHKD BY	SWAPNIL KALYANKAR

**SKA**  
SWAPNIL KALYANKAR ARCHITECTS  
Swapnil Kalyankar | +91 - 99875 96001  
OFFICE: SIDHANT MARKET, D - WING,  
2ND FLOOR, OPP. B.J.P OFFICE, PANVEL - 410 206.  
EMAIL: skaplanners@gmail.com

**SERVICES PLAN**  
SCALE 1:200 AS BUILT PLAN

**OVERHEAD WATER TANK CAPACITY CALCULATION**

BUILDING NUMBER	WATER REQUIRED (LITRE)	O.H.T Provided		
		TANK SIZE (METRE)	TOTAL CAPACITY (LITRE)	NUMBER OF TANK
02-Wing E & F	17258.63	4.40 X 2.50 X 1.20	13200	2

**WATER STORAGE CAPACITY CALCULATION**

BUILDING NUMBER	TOTAL NUMBER OF UNITS	ADDITIONAL TOILET	POPULATION	WATER REQUIREMENT (IN LITRE)		UNDER GROUND WATER TANK PROVIDED			
				ADDL. TOILET (180 LITRE)	POPULATION (189 LITRE)	TANK NUMBER	SIZE / DIMENSION	CAPACITY (LITRE)	
02-Wing E & F	39	8	195	1440	36855	38295	1	7.65X4.00X2.50	76500

